



Kimberley Cruising

Great Escape

The Kimberley is a land of captivating contrast. Discover one of the world's most amazing untouched wilderness areas and cruise past breathtaking waterfalls and dramatic cliff faces, while relaxing on the deck of your vessel. A Kimberley cruise is an adventure you will never forget!

Of course there's more to the Kimberley coastline than spectacular scenery. Reach for the binoculars to take in the abundance of birdlife and embark on an excursion to see some of the oldest Aboriginal rock art galleries featured in natural caves.

As you cruise along the Kimberley coastline, visit some of the most incredible attractions Australia has to offer. Witness the natural phenomenon at Montgomery Reef, where white water rapids reveal a vast reef eco-system. Marvel at the tiered waterfall at King Cascade, on the Prince Regent River and take a thrilling ride through the Horizontal Falls. Spot crocodiles along the Mitchell River and explore the beaches and ancient rock art on Bigge Island. Just sit back, relax and enjoy the breathtaking scenery that will surround you.

A whole new world of underwater wonder is yours to enjoy at Rowley Shoals Marine Park, 300 kilometres west of Broome. The coral atolls, clear lagoons and incredible marine life are exceptional. Take a dive on Clerke or Mermaid Reef and be on the lookout for everything from colourful coral gardens to various fish species. Come face to face with sea turtles, manta rays and dolphins. It's an underwater playground.

After a full day of exploring the wilderness, dine on sumptuous fresh food and watch the spectacular Kimberley sunset.

Kimberley Coastal Highlights

View Horizontal Falls by air and by boat

Snorkel the coral reefs of the Rowley Shoals

Hike inland to secluded rock pools and waterfalls for a swim

Enjoy a helicopter flight over Montgomery Reef

Dine on fresh fish, oysters and mud crab

Discover 20,000 year old rock art



True North



Coral Princess, King George River

Cruising Tips

Choosing a cruise

With cruises ranging from four to fourteen days, there's something for everyone, each providing access to remote locations best seen from the water.

Vessels range from five star ships offering a traditional cruise experience to small custom built vessels designed to navigate the tidal rivers and rugged coastlines of the Kimberley coast. Whether you choose to cruise with a small group of fourteen or a cruise that accommodates a maximum of 72, the friendly and knowledgeable crew will endeavor to show you the best of the Kimberley. With a vessel and style to suit you and 74 islands to sail between, you're spoilt for choice in the calm warm waters of the Kimberley.

What's included

Included in your cruise is onboard accommodation, all meals and day boat excursions. Sit back and relax and let it all be done for you. Competent crew will take you on shore excursions and prepare wonderful fresh meals to ensure you come away with memories of a lifetime.

Best time to go?

Early in the dry season from April to June is the best time to embark on a Kimberley cruise. This is when waterfalls and gorges have an abundance of water and the Barramundi fishing is at its best.

Is Adventure Cruising for me?

Kimberley cruising has been designed to allow all types of passengers the opportunity to experience the Kimberley coastline in comfort and style. Relax and enjoy the onboard facilities of the vessel while you cruise along the rugged coastline. All cruises offer a variety of land excursions each day and some walks require a reasonable level of fitness.

Need more information?

Our team of friendly travel experts are here to help with all your Kimberley cruising questions and can tailor make a cruise experience just for you.



Kimberley Cruising

Coral Princess Cruises



Coral Princess Cruises is Australia's longest established expedition cruise operator having pioneered the concept of small-ship cruising along the spectacular Kimberley coast between Broome and Darwin for over 18 years. Choose to cruise aboard the state-of-the-art, 63 metre luxury expedition ship Oceanic Discoverer or the legendary 35 metre catamaran Coral Princess, both purpose built in Australia for Australian cruising conditions. Each ship provides all the comforts and amenities you would expect from much larger vessels, but is small enough to access remote wilderness areas beyond the reach of other travellers.

Throughout your voyage of discovery, you will explore in the company of an all-Australian crew and team of expert guest lecturers. Gain a thorough understanding of the Kimberley's unique landscapes, flora and fauna and ancient art sites; insights that only true 'local knowledge' can deliver. Experience the Kimberley's 'big' rivers, stunning waterfalls and the tidal phenomena aboard a fleet of inflatable zodiacs and the unique, specially designed excursion vessel 'Xplorer'. Accommodating all guests in individual padded seating and featuring an onboard toilet and a roof for sun protection, aboard 'Xplorer' you will be able to discover much more of the Kimberley.

10 NIGHT BROOME TO DARWIN EXPEDITION CRUISE

When you join Coral Princess Cruises on a 10 night expedition cruise between Darwin and Broome you won't just see the Kimberley but truly experience it!

Discover remarkable Montgomery Reef and the amazing natural phenomenon of the Horizontal Falls of Talbot Bay. Explore the Mitchell Plateau and cruise the King George River with its towering 80 metre twin falls.

ITINERARY:

Day 1:	Depart Broome
Day 2:	Lacepede Islands
Day 3:	Horizontal Falls and Buccaneer Archipelago
Day 4:	Ruby Falls and Raft Point
Day 5:	Doubtful Bay and Montgomery Reef
Day 6:	Prince Regent River and King Cascades
Day 7:	Careening Bay and Bigge Island
Day 8:	Hathaway's Hideaway and Mitchell Falls
Day 9:	Vansittart Bay and Jar Island
Day 10:	King George River and Falls
Day 11:	Arrive Darwin

Cruise is also available in reverse.



DEPARTURE INFORMATION:

FROM BROOME
CORAL PRINCESS
2014: Apr 21
May 12
Jul 14
Aug 25
Oct 6
OCEANIC DISCOVERER
2014: Apr 28
Jun 30
Aug 11
Sep 1, 22
FROM DARWIN
CORAL PRINCESS
2014: Apr 11
May 2, 23
Jul 4, 25
Aug 15
Sep 5, 26
OCEANIC DISCOVERER
2014: Apr 18
May 9, 30
Jun 20
Aug 1, 22
Sep 12

VESSEL FEATURES:

- Air-conditioning
- Sundeck and spa pool
- Modern lounges and dining room
- Gift shop
- Comprehensive reference library

CABIN FEATURES:

- Air-conditioning
- Ensuite
- Choice of twin or double beds

INCLUDES:

- On board accommodation
- Landing fees
- All meals and 24 hour tea and coffee station
- Post mixed soft drink on board
- Services of expedition staff and guest lecturers
- Shore excursions aboard the unique 'Xplorer' and fleet of zodiacs

AVAILABLE AT AN EXTRA CHARGE:

- Wi-Fi
- Helicopter flight to Mitchell Falls
- Laundry charges
- Bar purchases
- Phone and fax facilities



Oceanic Discoverer



King Cascades

CORAL PRINCESS

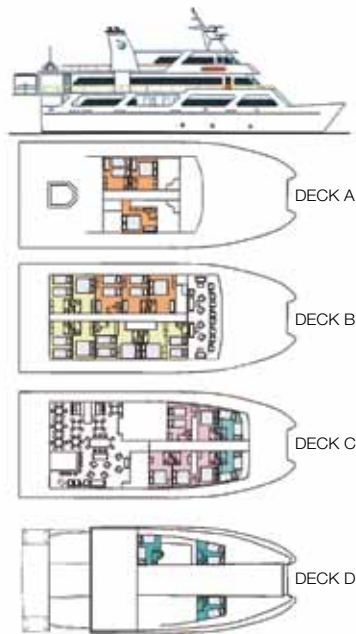

- 6 Deluxe Staterooms
- 8 Upper Deck Staterooms
- 5 Staterooms
- 5 Cabins

OCEANIC DISCOVERER

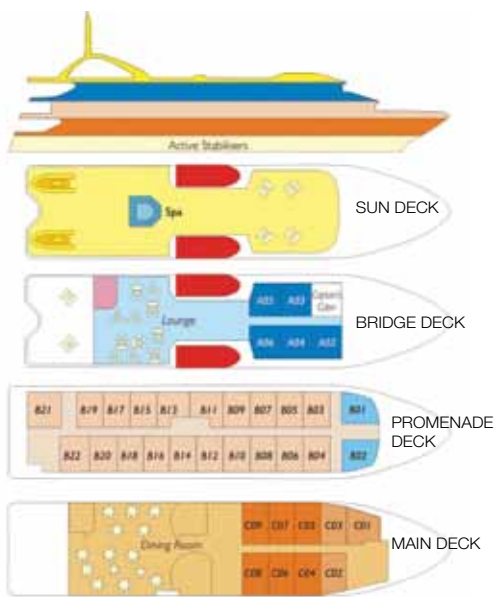

- Main Deck B
- Main Deck A
- Promenade Deck B
- Promenade Deck A
- Bridge Deck



Stateroom, Oceanic Discoverer



King George Falls

PRICE PER PERSON TWIN SHARE

CORAL PRINCESS	CABIN	STATEROOM	UPPER DECK STATEROOM	DELUXE STATEROOM
10 Night Broome to Darwin Expedition Cruise	\$7390	\$8390	\$8790	\$9090

PRICE PER PERSON TWIN SHARE

OCEANIC DISCOVERER	MAIN DECK B	MAIN DECK A	PROMENADE DECK B	PROMENADE DECK A	BRIDGE DECK
10 Night Broome to Darwin Expedition Cruise	\$8990	\$9290	\$9690	\$9990	\$10490

Children: 12 to 18 years – adult prices apply. Not suitable for children under 12 years. A fuel levy may apply. Above prices apply for reverse itinerary. Due to weather, tides or mechanical reasons, the itinerary may be subject to change without notice. Other Coral Princess Cruises destinations include: Great Barrier Reef, Cape York & Arnhem Land, New Zealand, Papua New Guinea, Islands of the South Pacific, Spice Islands & Raja Ampat.

CPCCS

Kimberley Cruising

The Great Escape Charter Company



Take a journey of discovery with The Great Escape Charter Company to the magnificent Kimberley coast and pristine Rowley Shoals.

MV Great Escape is a 26 metre custom built catamaran, designed to take you on an adventure of exploration to ancient and largely inaccessible parts of Australia's awe inspiring north west coast in complete style. With only 14 guests and a crew of five, the team at Great Escape Charter Company offer intimate and personalised cruises. A specially designed eight person spa is located on the foredeck, the perfect place to enjoy an ice-cold beverage and a spectacular Kimberley sunset. Satellite phone and fax equipment is available in the wheelhouse and all guests will have the ability to send and receive emails via satellite connection as well as watching real time TV in the lounge.

MV Great Escape operates three tenders offering variety and personalisation to the already small groups. The dedicated on board helicopter adds incredible perspective to the many adventure activities including in each itinerary.

4 NIGHT QUINTESSENTIAL KIMBERLEY COAST ESCAPE

This Quintessential Kimberley Coast Escape cruise captures the incredible Kimberley coastline over five days, including Montgomery Reef, Raft Point and the intriguing Aboriginal rock-art, Ruby Falls and the stunning Sale River. Take the opportunity to see the famous Horizontal Falls from the air.

Spend time in the tenders viewing the spectacular waterfalls, swim in a freshwater rock-pool and try your hand at fishing. Witness a host of flora and fauna with a good chance of spotting crocodiles. The bird life is wonderful and the movement of the tides is amazing.

ITINERARY:

- Day 1: Depart Broome
- Day 2: Raft Point, Ruby Falls
- Day 3: Sale River
- Day 4: Montgomery Reef
- Day 5: Arrive Broome

DEPARTURE INFORMATION:

FROM BROOME
 2014: Jul 17, 21, 25, 29 • Aug 2
 Sep 12, 16, 20, 24
 2015: Jul 28 • Aug 1, 5, 9, 13
 Sep 7, 15, 19, 23

6 & 7 NIGHT KINGS OF THE KIMBERLEY ADVENTURE

This cruise covers the best of the northern Kimberley Coast between Wyndham and the Mitchell Plateau, including the spectacular Kimberley icon, the King George Falls. You can choose to cruise from north to south (6 nights), or in reverse (7 nights). The cruise package includes a scenic charter flight across the northern Kimberley from Kununurra, to the Mitchell Plateau or in reverse, and a scenic helicopter flight over the Mitchell Falls.

ITINERARY:

- Day 1: Scenic Flight from Kununurra to Mitchell Plateau
- Day 2: Mitchell River
- Day 3: Vansittart Bay
- Day 4: Drysdale River
- Day 5: King George River
- Day 6: Atlantis Bay
- Day 7: Berkeley River
- Day 8: Wyndham – Kununurra

DEPARTURE INFORMATION:

FROM KUNUNURRA (FLY/CRUISE)
 2014: Apr 11 • May 23
 2015: Apr 10
 FROM KUNUNURRA (CRUISE/FLY)
 2014: Apr 5 • May 17
 2015: Apr 4

7 NIGHT SOUTHERN KIMBERLEY EXPERIENCE

Travel the Kimberley coast from Broome through to Hunter River/Mitchell Plateau and everywhere in between. Experience the natural majesty of the Prince Regent, explore ancient tributaries and natural phenomena such as Montgomery Reef and the famous Horizontal Falls.

ITINERARY:

- Day 1: Depart Broome
- Day 2: Buccaneer Archipelago, Horizontal Falls
- Day 3: Raft Point, Ruby Falls
- Day 4: Montgomery Reef
- Day 5: Camden Harbour
- Day 6: King Cascade
- Day 7: Camp Creek, Careening Bay
- Day 8: Scenic helicopter flight over Mitchell Falls, scenic flight to Broome

Cruise is also available in reverse.

DEPARTURE INFORMATION:

FROM BROOME (CRUISE/FLY)
 2014: Jun 14, 29
 2015: Jun 27 • Jul 12 • Aug 22
 FROM BROOME (FLY/CRUISE)
 2014: Jun 21 • Jul 6
 2015: Jul 4, 19 • Aug 29

13 NIGHT KIMBERLEY CLASSIC ADVENTURE

This popular cruise explores the length of the Kimberley coast between Broome and Wyndham. The Kimberley Classic Adventure is recommended for those who truly want to experience all there is to offer along this magnificent wilderness frontier, and is for adventurers and hedonists alike.

ITINERARY:

- Day 1: Depart Broome
 - Day 2: Yampi Sound, Talbot Bay
 - Day 3: Horizontal Falls, Raft Point
 - Day 4: Doubtful Bay, Ruby Falls
 - Day 5: Montgomery Reef, Langjii
 - Day 6: Camden Harbour, Prince Regent River
 - Day 7: King Cascade
 - Day 8/9/10: Hunter River/Bigge Island/Mitchell River
 - Day 11: Vansittart Bay
 - Day 12/13: King George River/Berkeley River
 - Day 14: Arrive Wyndham
- Cruise is also available in reverse.

DEPARTURE INFORMATION:

FROM BROOME
 2014: May 3 • Aug 9
 2015: May 2, 30
 FROM WYNDHAM
 2014: Apr 19 • May 31 • Aug 23
 2015: Apr 18 • May 16 • Jun 13

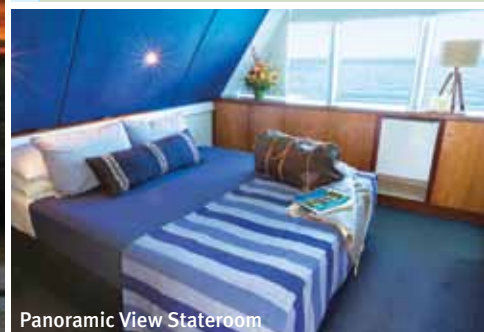
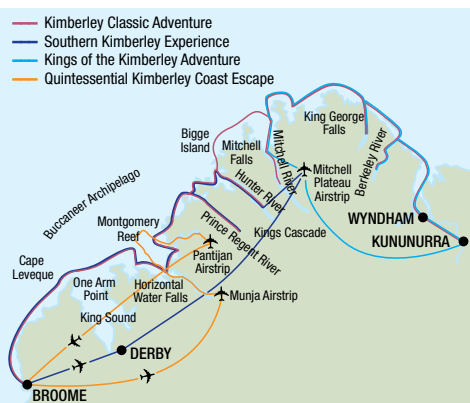

Panoramic View Stateroom

VESSEL FEATURES:

- Air-conditioning
- Spa on deck
- Helicopter
- Indoor and alfresco dining
- Coffee machine
- Extensive reading library
- Media library
- Audio visual equipment
- Maximum of 14 guests

CABIN FEATURES:

- Choice of queen bed or twin beds
- Ensuite ■ Mini refrigerator
- Flat screen TV
- CD/DVD player
- Daily servicing

INCLUDES:

- On board accommodation
- All meals
- All non-alcoholic beverages on board
- Daily activities and shore excursions
- Great Escape Charter Company t-shirt
- Welcome pack with Kimberley map and souvenir DVD
- Laundry service
- Transfers from Broome or Kununurra accommodation/Airport

AVAILABLE AT AN EXTRA CHARGE:

- Wi-Fi
- Optional helicopter flights
- Alcoholic beverages
- Satellite phone and fax

UPPER DECK

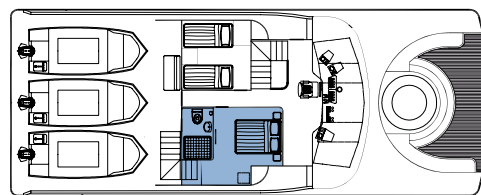

MAIN DECK

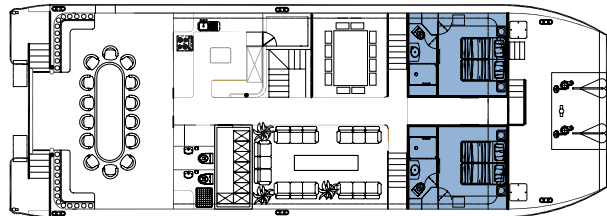

LOWER DECK

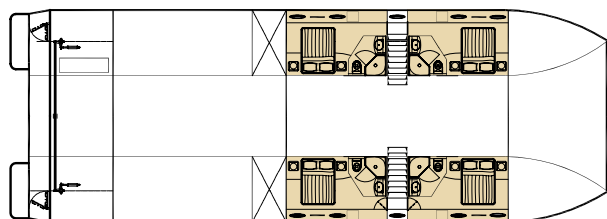

■ Horizon View Stateroom ■ Panoramic View Stateroom



PRICE PER PERSON TWIN SHARE

CRUISE	2014		2015	
	HORIZON VIEW STATEROOM	PANORAMIC VIEW STATEROOM	HORIZON VIEW STATEROOM	PANORAMIC VIEW STATEROOM
4 Night Quintessential Kimberley Coast Escape	\$4195	\$4695	\$4995	\$5495
6 Night Kings of the Kimberley Adventure	\$8455	\$9315	\$8455	\$9315
7 Night Kings of the Kimberley Adventure	\$9865	\$10865	\$9865	\$10865
7 Night Southern Kimberley Experience	\$9865	\$10865	\$9865	\$10865
13 Night Kimberley Classic Adventure	\$16130	\$18130	\$16130	\$18130

Children: 0 to 16 years – on application.

Due to weather, tides or mechanical reasons, the itinerary may be subject to change without notice.

GREBME

Kimberley Cruising

Kimberley Quest



The Kimberley Quest II is a 25 metre expedition vessel which is equipped with its own helipad, spa and has been custom built for the remote Kimberley region, allowing easy access to discover many remote and untouched places. Accommodating just 18 passengers and with a choice of nine cabin styles—each with a private ensuite, enjoy the pristine Kimberley wilderness in comfort and style.

Carrying three excursion tenders, days are filled with a myriad of activities, exploring the waterways with experienced guides who are always on hand to share their extensive knowledge of the region and bring your adventure to life. Witness the vast tidal creeks, rugged gorges, massive waterfalls and pristine beaches. With plenty of time to swim in freshwater pools, explore historical sites and witness ancient rock art galleries. Have a go at landing the elusive barramundi, go croc spotting, beach walking or observe the many species of wildlife – the choice is yours to do as much as you like, or as little as you wish!

7 NIGHT SOUTHERN QUEST

Many icons of the Kimberley can be found in the southern region. This area is prolific with islands, whirlpools, inlets and pockets of rainforest home to many species of birds. Visit the famous Horizontal Waterfalls, Montgomery Reef and the King Cascade.

ITINERARY:

Day 1:	Depart Broome
Day 2:	Buccaneer Archipelago, Dugong Bay, Talbot Bay
Day 3:	Collier Bay, Montgomery Reef
Day 4:	Doubtful Bay, Sale River, Raft Point
Day 5:	Langii, Kuri Bay, Camden Harbour
Day 6:	Prince Regent River, King Cascade, Cathedral Falls
Day 7:	Camp Creek, Careening Bay
Day 8:	Hunter River, scenic flight over Mitchell Falls, return flight back to Broome

Cruise is also available in reverse.

DEPARTURE INFORMATION:

BROOME – HUNTER RIVER (CRUISE/FLY)
2014: Jun 3, 17 • Jul 10, 24
Aug 28 • Sep 11

HUNTER RIVER – BROOME (FLY/CRUISE)
2014: May 26 • Jun 10, 24
Jul 17, 31 • Sep 4, 18

7 NIGHT NORTHERN QUEST

Renowned for its massive gorges and river systems, extensive waterfalls, World War II relics and incredible Bradshaw rock art sites, the northern Kimberley is an experience not to be missed. Exploring between Wyndham and the Mitchell River, this cruise will visit Kimberley icons such as the King George Falls, Berkeley River and the Drysdale River and many more.

ITINERARY:

Day 1:	Broome to Mitchell River
Day 2:	Vansittart Bay, WWII DC3 site
Day 3:	Napier Broome Bay
Day 4:	Drysdale River
Day 5:	Glycosmis Falls, Pangali Cove, Koolama Bay
Day 6:	King George River
Day 7:	Berkeley River, Cambridge Gulf
Day 8:	Wyndham Port

DEPARTURE INFORMATION:

WYNDHAM – MITCHELL RIVER (CRUISE/FLY)
2014: May 5, 19

MITCHELL RIVER – WYNDHAM (FLY/CRUISE)
2014: May 12

9 NIGHT ADVENTURE QUEST

An extensive exploration of the southern Kimberley, visiting many unknown sights, rarely visited islands and inlets. Enjoy pristine beaches, swimming holes, historical art sites and barramundi fishing. This Broome to Broome loop visits icons such as the Horizontal Waterfalls, Montgomery Reef and the King Cascade waterfall. Taking in all there is to offer of the southern region, this quest involves lots of exploring and unforgettable scenery.

ITINERARY:

Day 1:	Broome to Cape Leveque
Day 2:	Buccaneer Archipelago, Dugong Bay, Talbot Bay
Day 3:	Surprise Falls, Secure Bay
Day 4:	Montgomery Reef, Sale River and Raft Point
Day 5:	Doubtful Bay, Red Cone Creek, Camden Sound
Day 6:	Camden Harbour, Rothsay Water
Day 7:	Prince Regent River, King Cascade, Cathedral Falls
Day 8:	Hanover Bay, Booby Island
Day 9:	Heywood and Champagny Island
Day 10:	Broome

Cruise is also available in reverse.

DEPARTURE INFORMATION:

2014: Jul 1 • Aug 7, 18

13 NIGHT ULTIMATE QUEST

The ultimate wilderness cruise along the whole Kimberley coast. Cruising between Broome and Wyndham, this adventure has it all. Witness the amazing icons including the King George Falls, Berkeley River and the Horizontal Waterfalls.

ITINERARY:

Day 1:	Broome, Cape Leveque
Day 2:	Buccaneer Archipelago, Dugong Bay, Talbot Bay
Day 3:	Collier Bay, Montgomery Reef, Red Cone Creek
Day 4:	Doubtful Bay, Sale River, Raft Point
Day 5:	Langii, Kuri Bay, Camden Harbour
Day 6:	Prince Regent River, King Cascade, Cathedral Falls
Day 7:	Careening Bay, Bigge Island
Day 8:	Mitchell River, Surveyors Creek
Day 9:	Vansittart Bay, WWII DC3 site
Day 10:	Drysdale River
Day 11:	Glycosmis Falls, Pangali Cove, Koolama Bay
Day 12:	King George River
Day 13:	Berkeley River, Cambridge Gulf
Day 14:	Wyndham, Kununurra

Cruise is also available in reverse.

DEPARTURE INFORMATION:

BROOME – WYNDHAM
2014: Mar 25 • Apr 22

WYNDHAM – BROOME
2014: Apr 8



VESSEL FEATURES:

- Helipad ■ Spa ■ Spacious sundeck
- Indoor and outdoor alfresco areas
- Comprehensive library ■ CD/DVD player
- Phone and fax facilities (extra charge)
- Maximum of 18 guests

INCLUDES:

- On board accommodation
- All meals on board
- 24 hour tea and coffee station
- Daily excursions ■ Experienced guides
- Return transfers from accommodation

CABIN FEATURES:

- Air-conditioning ■ Ensuite ■ Refrigerator
- Viewing window ■ 240 volt power ■ Daily servicing

AVAILABLE AT AN EXTRA CHARGE:

- Alcoholic beverages and mixers
- Scenic helicopter flights

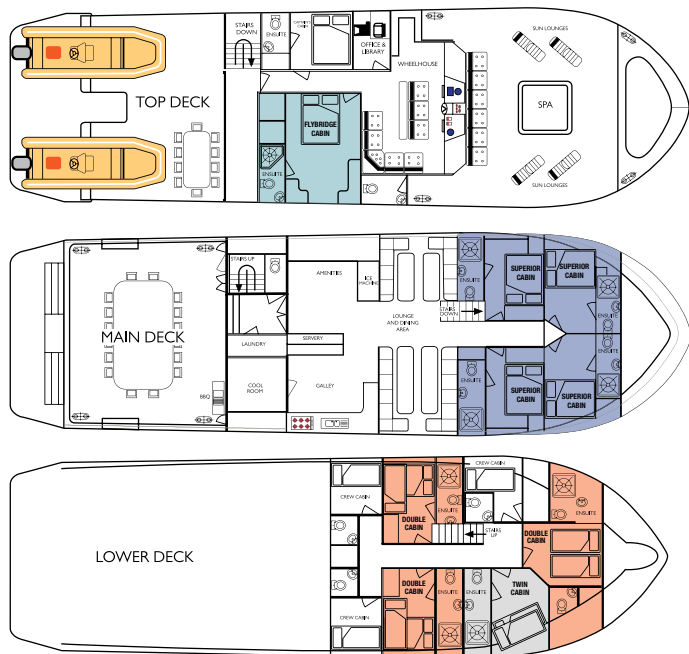

PRICE PER PERSON TWIN SHARE

CRUISE	TWIN CABIN	DOUBLE CABIN	SUPERIOR CABIN	FLYBRIDGE CABIN
7 Night Southern/Northern Quest	\$9180	\$10208	\$11974	\$13294
9 Night Adventure Quest	\$10395	\$11476	\$13330	\$14715
13 Night Ultimate Quest	\$13305	\$15274	\$18628	\$19828

Children: 0 to 10 years – not catered for.

Due to weather, tides or mechanical reasons, the itinerary may be subject to change without notice.

PEABME



Kimberley Cruising

North Star Cruises Australia – True North



North Star Cruises Australia offer activity based adventure cruises aboard the stunning True North. Featuring enhanced levels of comfort and luxury throughout, the True North allows discerning adventurers to experience wilderness in surroundings more akin to one of the world's most exclusive hotels. With a crew of 20 and a passenger limit of 36, True North ensures the unique attention to detail that North Star Cruises is famous for.

Take advantage of the lavish vantage points including a sundeck, a forward observation lounge, a ship's lounge and an alfresco bar. The ship's naturalist presents interpretative information on plasma screens and internet facilities enable convenient communication with the outside world. A popular venue on any North Star cruise, the lower deck dining room offers the ultimate in comfort and panoramic views of the surroundings. North Star Cruises invites you to discover the Kimberley on a 2,000 kilometre expedition along Western Australia's remote north coast. Six expedition boats will allow you to experience the Kimberley 'up close' and in small groups.

To add yet another dimension to your adventure, the True North sails complete with its very own helicopter!

5 NIGHT CORAL ATOLL CRUISE

The Rowley Shoals are perhaps the most exclusive coral environment in the world – less than 300 visitors a year are fortunate enough to give testimony to the brilliance of this remote wilderness. The atoll's crystal clear waters are home to more than 600 species of fish and 200 species of coral – a true Mecca for divers, snorkellers and fishing enthusiasts alike and the True North's flexible itinerary caters for all.

ITINERARY:

Day 1:	Depart Broome
Day 2:	Clerke Reef, The Aquarium
Day 3:	Clerke Reef, Bedwell Island
Day 4:	Clerke Reef, The Dinghy Channels
Day 5:	Mermaid Reef, The Cod Hole and the Northern Wall
Day 6:	Arrive Broome

DEPARTURE INFORMATION:

FROM BROOME
2014: Sep 13, 18, 24
2015: Sep 12, 17, 23

7 NIGHT KIMBERLEY SNAPSHOT

For those pressed for time – here is the flagship Kimberley Ultimate itinerary condensed into a single week voyage! This cruise features several Kimberley icons including the King George Falls, the Hunter River, the Prince Regent Falls, Montgomery Reef and the Horizontal Falls.

ITINERARY:

Day 1:	Depart Broome
Day 2:	Horizontal Falls, Doubtful Bay
Day 3:	Sale River, Montgomery Reef
Day 4:	Prince Regent River, King Cascade
Day 5:	Hunter River, Jackson Falls
Day 6:	Eagle Falls, Koolama Bay
Day 7:	King George Falls, Tranquil Bay
Day 8:	Arrive Wyndham

DEPARTURE INFORMATION:

FROM BROOME
2014: Apr 19 • May 10, 31
Jun 21 • Jul 12 • Aug 2, 23
2015: Apr 18 • May 9, 30
Jun 20 • Jul 11 • Aug 1, 22

10 NIGHT KIMBERLEY WET SEASON ADVENTURE

Experience the emotive beauty that accompanies the end of the wet season! Witness the Kimberley's renowned summer storms and spectacular light shows and marvel at the thundering waterfalls and swollen billabongs.

ITINERARY:

Day 1:	Depart Wyndham
Day 2:	King George River & Falls
Day 3:	Eagle Falls & Bradshaw Art
Day 4:	Surveyors Creek & Mitchell River
Day 5:	Voltaire Passage
Day 6:	Hunter River & Jackson Falls
Day 7:	Melaleuca Falls
Day 8:	Price Regent River & King Cascade
Day 9:	Raft Point & Montgomery Reef
Day 10:	Horizontal Falls & Talbot Bay
Day 11:	Arrive Broome

DEPARTURE INFORMATION:

FROM WYNDHAM
2014: Apr 5
2015: Apr 7

13 NIGHT KIMBERLEY ULTIMATE CRUISE

Cruise the magnificent Kimberley coast. Experience the wild and beautiful panorama of rugged mountains, spectacular gorges and majestic waterfalls, unexplained rock art, extraordinary wildlife and monster barramundi.

ITINERARY:

Day 1:	Depart Wyndham
Day 2:	Berkeley River, Cambridge Gulf
Day 3:	King George River and Falls, Koolama Bay
Day 4:	Drysdale River
Day 5:	Eagle Falls, Drysdale River
Day 6:	Mitchell River, Vansittart Bay
Day 7:	Hunter River, Voltaire Passage
Day 8:	Hunter River, Jackson Falls
Day 9:	Prince Regent River
Day 10:	Prince Regent River, King Cascade
Day 11:	Sale River, Montgomery Reef
Day 12:	No Name Creek, Raft Point
Day 13:	Horizontal Falls, Doubtful Bay
Day 14:	Arrive Broome

DEPARTURE INFORMATION:

FROM WYNDHAM
2014: Apr 26 • May 17 • Jun 7, 28
Jul 19 • Aug 9, 30
2015: Apr 25 • May 16 • Jun 6, 27
Jul 18 • Aug 8, 29

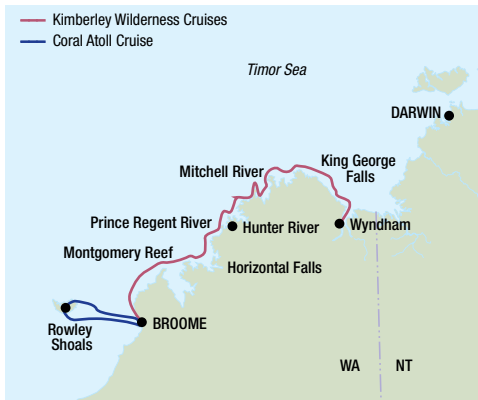

VESSEL FEATURES:

- Internet facilities ■ Sundeck
- Observation lounge
- Ship's lounge ■ Alfresco bar
- Dining room ■ Expedition boats (6)
- Helicopter ■ Maximum of 36 guests and 20 crew

CABIN FEATURES:

- Ensuite ■ In-cabin entertainment
- Satellite phone ■ Air-conditioning

INCLUDES:

- On board accommodation
- All meals and non-alcoholic beverages on board
- Daily activities and shore excursions (excluding scenic flights)

AVAILABLE AT AN EXTRA CHARGE:

- Alcoholic beverages
- Merchandise
- Scenic flights



Explorer Class Stateroom

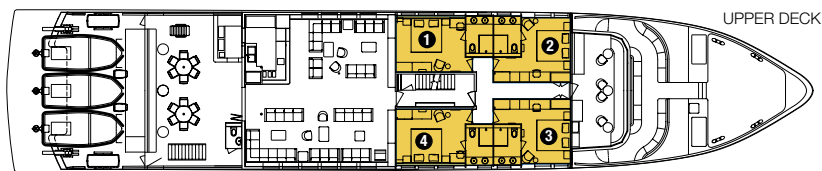

UPPER DECK

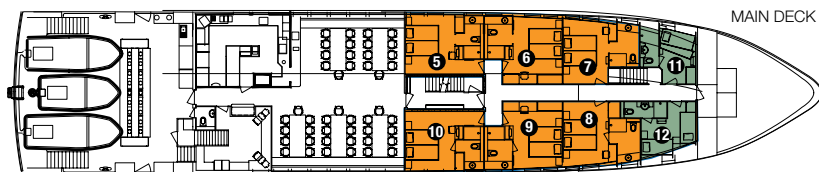

MAIN DECK

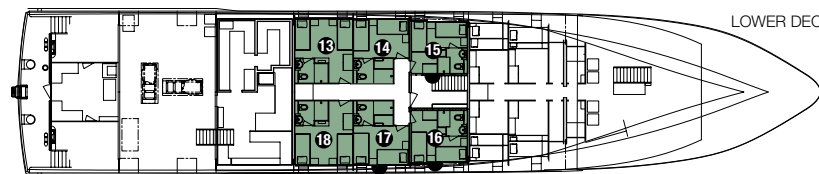

LOWER DECK

- Explorer Class Stateroom
- River Class Double
- Ocean Class Twin

PRICE PER PERSON TWIN SHARE

CRUISE	2014			2015		
	OCEAN CLASS TWIN	RIVER CLASS DOUBLE	EXPLORER CLASS STATEROOM	OCEAN CLASS TWIN	RIVER CLASS DOUBLE	EXPLORER CLASS STATEROOM
5 Night Coral Atoll Cruise	\$4995	\$6595	\$7695	\$5295	\$6995	\$8095
7 Night Kimberley Snapshot	\$10495	\$13295	\$15295	\$11095	\$14095	\$16095
10 Night Kimberley Wet Season Adventure	\$11995	\$16995	\$19295	\$12595	\$17695	\$20095
13 Night Kimberley Ultimate Cruise	\$15295	\$21995	\$24995	\$17995	\$22995	\$26295

Children: 0 to 12 years – child prices are on application. Due to prevailing conditions and local arrangements – itineraries are subject to change without notice. Other True North destinations include: Arohos Islands, Ningaloo Reef, Monte Bello Islands, West Papua, Papua New Guinea, Sydney, Eyre Peninsula.

NORAUS