

KIMBERLEY CRUISING & BROOME



2017/18

Cruise The Kimberley & see Broome the Sunlover Holidays way!

The white sandy beaches, sparkling blue water, ancient indigenous rock art, majestic waterfalls and soaring red gorges of The Kimberley make this region of Western Australia a must see Australian destination.

Get up close to the rugged Kimberley coast on a cruise. Or choose from a wide range of accommodation and touring options. From luxurious beachside resorts or remote Kimberley stations and wilderness camps to guided tours or 4WD hire, create your perfect itinerary. Drive the famous Gibb River Road, visit the magical domes of the Bungle Bungle Ranges and see the sun set over Roebuck Bay.

Whether you're planning a short break, a romantic getaway or the ultimate family adventure, Sunlover Holidays can tailor-make your dream holiday. Use this brochure for inspiration, then let our travel experts assist you to experience Australia your way – happy travelling!



34 | Cable Beach, Broome

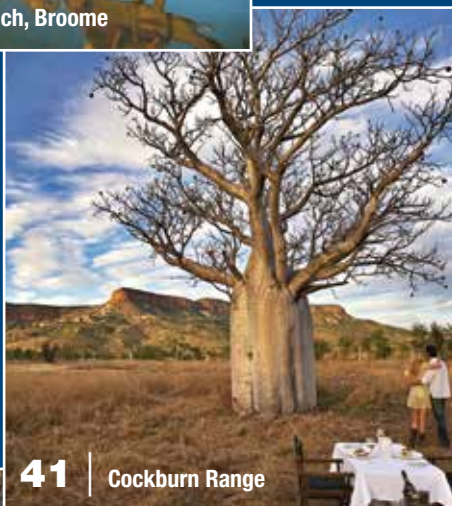

41 | Cockburn Range

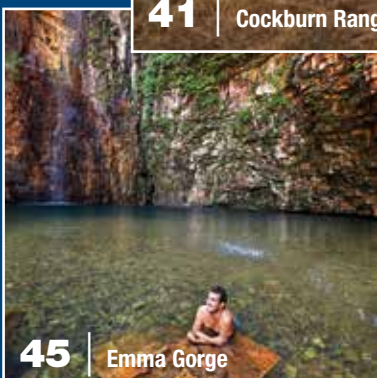

45 | Emma Gorge

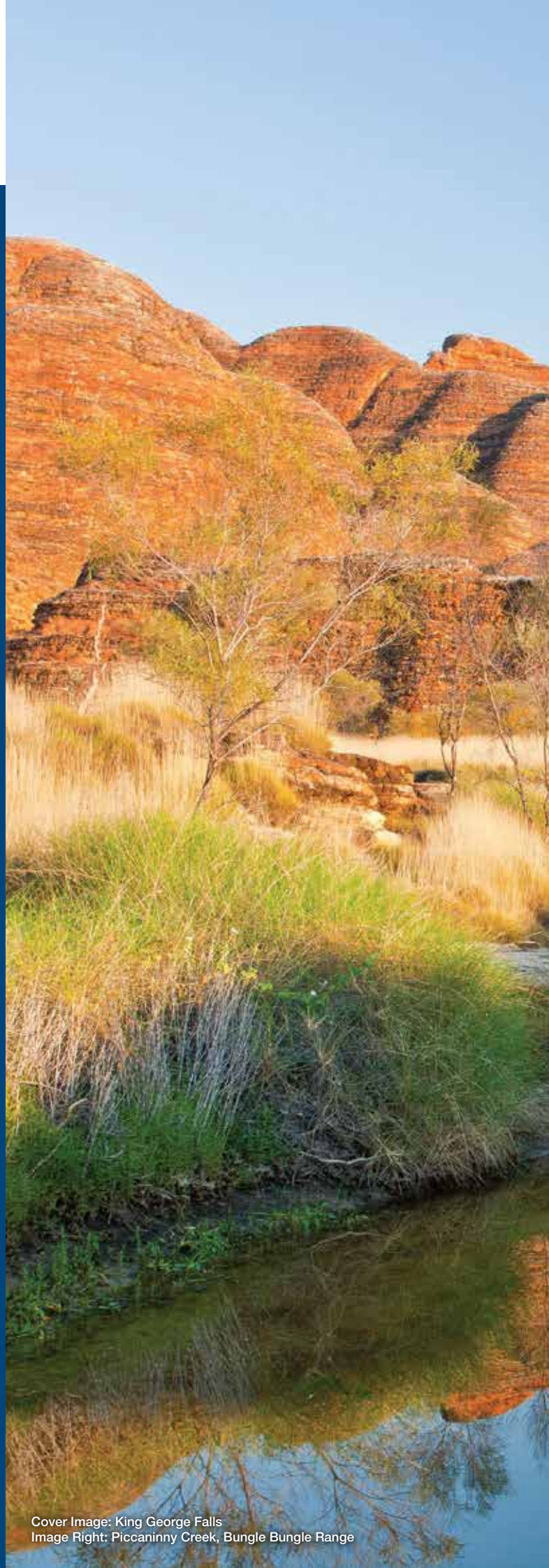

Contents

Navigating This Brochure	4
Travel Tips	6
Top 10 Things To Do	8
Kimberley Cruising	10
Holiday Packages	20
Self Drive Holidays	21
Exploring The Kimberley & Broome	23
Car Hire	23
Extended Touring	25
Broome & Surrounds	32
Kununurra & Surrounds	41
Kimberley Stations & Wilderness Camps	45
Halls Creek	49
Accommodation Index	50
Booking Conditions	51

Why book a Sunlover Holiday?

Gantheaume Point

The Sunlover Holidays Difference

Sunlover Holidays are multi award winning Australian travel specialists, having most recently won the prestigious AFTA National Travel Industry award for Best Wholesaler Australian Product. Our extensive range of travel products and experiences plus great Value for Money offers will provide you with the inspiration you need to plan your dream holiday.

Choose from any of our travel products and experiences or if you would like further inspiration, ask one of our well-travelled team to design your perfect getaway with our Tailor-made Holidays. Fantastic prices, a diverse range of holiday destinations, the widest choice of products and unmatched service, combined with over 30 years experience – that's the Sunlover Holidays difference!



Bonus Offers

Throughout this brochure you'll find amazing Bonus Offers including free nights, room upgrades and food and beverage credits to name a few. Just look for the Bonus Offer box.

We are always sourcing specials throughout the year.

Ask us for the latest deals when making your booking.

Exclusively For You

We're always on the lookout for ways to enhance your holiday experience! Check out our deals marked Exclusively for You.

We've put together some fantastic Holiday Packages that offer exceptional value for money, starting on page 20. You'll love our Self Drive Holidays, these hand-crafted itineraries begin on page 21. You'll find Exclusive Offers throughout the brochure, plus hotels and tours that are available exclusively through Sunlover Holidays.

Just look for Exclusively for You!

24 Hour Assistance

We know your holiday experience doesn't end until you are safely home. That's why our Customer Care Team is on call 24 hours a day, seven days a week, should you require any assistance during your holiday.

All the necessary information will be provided with your travel documentation and you can contact the team at any time during your holiday.

We're with you on your journey.

We love it!

Look for this symbol to find our most popular experiences!

With everything from accommodation, car hire, day tours, extended touring and much more, you'll be spoilt with choice when planning your next holiday.

To assist you, we've highlighted our most popular products booked by our customers. Just look for the We love it! symbol throughout this brochure.

Our customers love it and so will you!



Open Dated Tours

Buy Now & Book Later!

Our Open Dated range of tours offers you the flexibility of pre-paying for your 'must do' holiday experiences without having to lock in dates in advance. This means you can pick the day that best suits your needs once your holiday has commenced. Simply include an Open Dated tour in your itinerary, pay for your entire holiday prior to departure, then call us up to 24 hours in advance to book.

Open Dated gives you the flexibility to buy now and book later!

Navigating This Brochure

Accommodation Ratings

STAR and Diamond ratings are used throughout the brochure to describe the standard of accommodation.

STAR RATINGS Properties featuring the Star symbols are independently assessed by Star Ratings Australia (SRA). SRA is a stand-alone accreditation business and a subsidiary of Australian Motoring Services (AMS). The Stars and the Star Ratings are a registered trademark of AMS. We have no input into the assessment process.

DIAMOND RATINGS Properties featuring Diamond symbols do not participate in a recognised rating scheme. The rating is supplied by the individual property based on their own assessment. We recommend they be used as a guide only.

- ★★
◆◆ Budget standard of accommodation
- ★★★
◆◆◆ Comfortable standard of accommodation
- ★★★★
◆◆◆◆ Superior standard of accommodation and facilities
- ★★★★★
◆◆◆◆◆ Deluxe standard of accommodation and facilities
- ☆
◇ Denotes additional half rating

Pricing Guide

The prices featured in this brochure are intended as a guide. The prices have been calculated using the lowest available daily price at the time this brochure was produced and may change due to exchange rate fluctuations, availability, taxes or seasonal surcharges. Prices featured in accommodation listings are per person twin share for the period specified unless otherwise stated. The "From" price has been calculated using the lowest nightly rate available, i.e. lead-in room type in off-peak season including free night offers if applicable, even if that offer is only available for part of a season. A minimum stay is generally required. Where prices for more than a one night stay are featured, the prices refer to stays of consecutive nights. Ask your travel agent for the best price available, other room types or travel dates.

What the Symbols mean

-  Properties offering free Wi-Fi access throughout the common areas and in rooms.
-  Properties offering in-room disabled facilities.
-  A special bonus offer (e.g. sparkling wine) is available if you are celebrating your honeymoon. Details must be provided at the time of booking.
-  Suggested 'must do' tours of iconic destinations/attractions.
-  Ecotourism product – uses resources wisely, contributes to environmental conservation and helps local communities.
-  Advanced Ecotourism product – a leading and innovative product that uses resources wisely, contributes to environmental conservation and helps local communities.

We love it! Refer to page 5 for details.

 Refer to page 5 for details.

 **tripadvisor**

TripAdvisor rates real travellers' experiences, giving you an unbiased and impartial point of view on the product we feature in this brochure to assist you with your holiday planning. TripAdvisor ratings and reviews are available to view on our website at www.sunloverholidays.com.au.

Let Sunlover Holidays inspire you to discover more of these fantastic destinations.

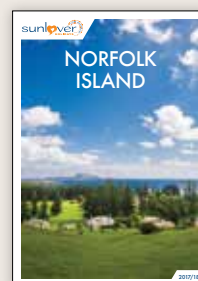
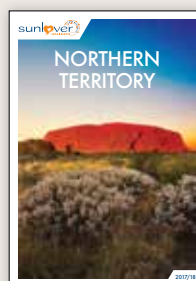
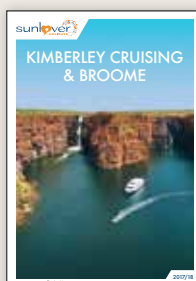
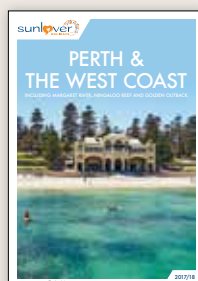
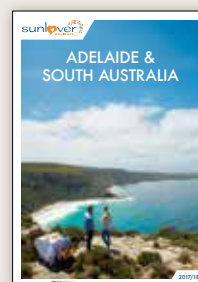
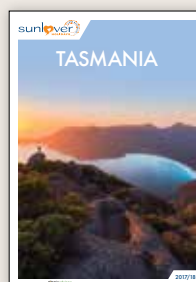
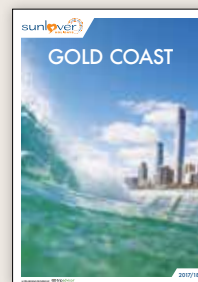
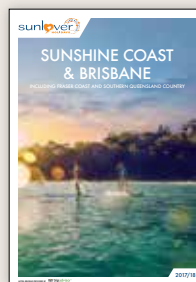
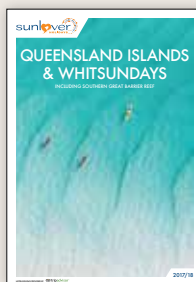
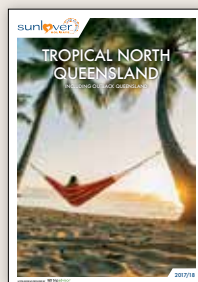

Our Specialty Collection

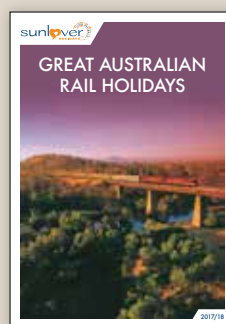

Tailor-made Holidays

Our team of travel experts have unparalleled knowledge of Australia's unique travel experiences and destinations. We can design custom made itineraries to anywhere in Australia. From dining under a glittery canopy of stars at Uluru to a scenic flight over the Great Barrier Reef – the choice is yours!

We look forward to planning a truly inspiring travel experience for you. With our Tailor-made Holidays anything is possible.

We love travel and creating tailor-made travel experiences is what we do best.



Travel Tips



Raft Point, Doubtful Bay

How to Get There

BY AIR Flights are available to Broome from Perth with Virgin Australia. Flights are available to Broome from Brisbane, Sydney, Melbourne and Perth with Qantas. Skippers operate flights between Broome, Derby, Fitzroy Crossing and Halls Creek. Airnorth operate flights between Broome, Kununurra and Darwin.

FLIGHT DURATION

FROM / TO	BROOME	KUNUNURRA
Brisbane	4 hrs 30 mins	-
Sydney	4 hrs 5 mins	-
Melbourne	3 hrs 50 mins	-
Perth	2 hrs 30 mins	3 hrs 10 mins
Darwin	1 hr 45 mins	1hr
Kununurra	1 hr 20 mins	-

Times are a guide only and subject to change.

BY CAR Take the time to explore and discover as you make your way around The Kimberley and Broome by road. Whether it's getting there or getting around we recommend Avis and Budget car hire. See pages 23 and 24 for details or ask your travel agent about the great specials Avis and Budget have to offer.

Broome, Derby and Kununurra can be accessed by sealed road via the Great Northern Highway in Western Australia or the Victoria Highway linking with the Stuart Highway in the Northern Territory. The unsealed Gibb River Road links Derby and Kununurra.

A unique feature of travelling in the region are road trains. These can be up to 50 metres in length, so extra care should be taken when overtaking them.

Many stations in The Kimberley region are unfenced and it is not uncommon to encounter wandering stock and wildlife. Particular care should be taken when driving at dawn and dusk, and if possible, avoid driving at night. During the summer period (November to April), road closures due to flooding are common, particularly on unsealed roads.

Seasons

Summer (Nov to Apr): In summer the weather is hot and humid and the nights balmy. While it's known as the wet season, the rain usually falls in heavy, short downpours in the late afternoon and evenings. Some attractions may not be accessible due to road closures and local flooding.

Winter (May to Oct): Winter is the most popular time to visit with sunny days and cool nights with fresh breezes. This is the best time to experience all outdoor activities, with most roads and attractions open throughout the season.

Swimming

There are plenty of safe places to swim in the region, including Cable Beach. Salt and Freshwater crocodiles are found in estuaries, rivers and billabongs in the remote parts of The Kimberley, so always observe warning signs, but if you are not sure, do not swim. Marine stingers are most prevalent along the coastline from November to April.

Aboriginal Culture and Permits

Transit Permits to visit Indigenous communities are granted through the Aboriginal Lands Trust and are designed to help preserve Aboriginal heritage and culture. It is best to choose a tour where operators already have permission to enter the land.

School Holidays 2017-18

Queensland	1 – 17 Apr, 24 Jun – 9 Jul, 16 Sep – 2 Oct, 9 Dec 17 – 21 Jan 18
New South Wales	8 – 25 Apr, 1 – 17 Jul, 23 Sep – 8 Oct, 16 Dec 17 – 29 Jan 18
Victoria	1 – 17 Apr, 1 – 16 Jul, 23 Sep – 8 Oct, 23 Dec 17 – 29 Jan 18
Australian Capital Territory	8 – 25 Apr, 1 – 16 Jul, 23 Sep – 8 Oct, 16 Dec 17 – 4 Feb 18
Tasmania	14 – 30 Apr, 8 – 23 Jul, 30 Sep – 15 Oct, 22 Dec 17 – 6 Feb 18
South Australia	14 – 30 Apr, 8 – 23 Jul, 30 Sep – 15 Oct, 16 Dec 17 – 28 Jan 18
Western Australia	8 – 23 Apr, 1 – 16 Jul, 23 Sep – 8 Oct, 15 Dec 17 – 30 Jan 18
Northern Territory	8 – 17 Apr, 24 Jun – 24 Jul, 30 Sep – 8 Oct, 15 Dec 17 – 28 Jan 18

Events & Public Holidays

May

Lake Argyle Classic Swim	6th
Ord Valley Muster, Kununurra	19th-28th
Cable Beach Polo	20th-21st
The Gibb Challenge	21st-2nd
Kimberley Moon Experience, Kununurra	27th
Whale Watching Season	May-Dec

August

Shinju Matsuri Festival of the Pearl, Broome	2nd-10th
Kimberley Cup, Broome	5th
Broome Cup	19th

September

Kimberley Writers Festival, Kununurra	TBC
---------------------------------------	-----

Broome Staircase to the Moon

The Staircase to the Moon is a natural phenomenon caused by the rising full moon's reflection off the exposed mudflats at extremely low tide. This creates an optical illusion of stairs reaching to the moon.

March	13th, 14th, 15th
April	12th, 13th, 14th
May	11th, 12th, 13th
June	10th, 11th, 12th
July	10th, 11th, 12th
August	8th, 9th, 10th
September	7th, 8th, 9th
October	6th, 7th, 8th
November	5th, 6th

Refer to page 8 for details.

TBC - Dates for this event were yet to be confirmed at the time of printing.

Weather Guide

Temperature average in

	Broome	Kununurra
Summer	26°C to 33°C	25°C to 37°C
Autumn	22°C to 33°C	21°C to 35°C
Winter	15°C to 29°C	16°C to 31°C
Spring	22°C to 33°C	23°C to 37°C

INTERNATIONAL AIRPORTS
 REGIONAL AIRPORTS
 NATIONAL PARKS
 MAIN ROADS
 DIRT ROADS
 ATTRACTIONS



WESTERN AUSTRALIA

Distances by road (km)

BROOME									
220	DERBY								
395	258	FITZROY CROSSING							
685	546	290	HALLS CREEK						
1046	903	651	361	KUNUNURRA					
2239	2388	2566	2854	3212	PERTH				
612	765	940	1229	1586	1646	PORT HEDLAND			
1055	917	660	369	101	3224	1599	WYNDHAM		
1871	1734	1476	1186	829	4041	2414	933	DARWIN	

Distances should be used as a guide only.

NORTHERN TERRITORY

Top 10 Things To Do



1 Cable Beach



2 Kimberley Station

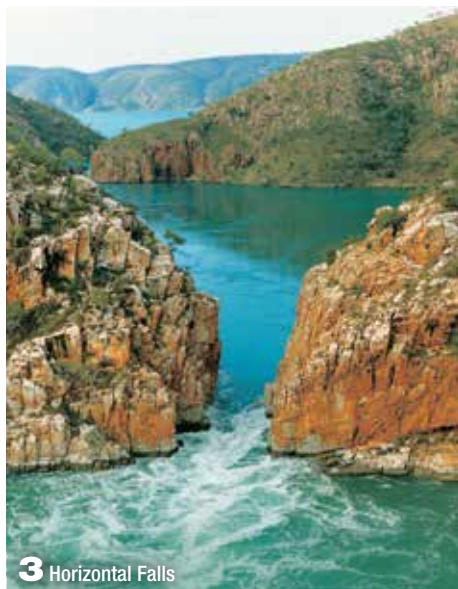

3 Horizontal Falls

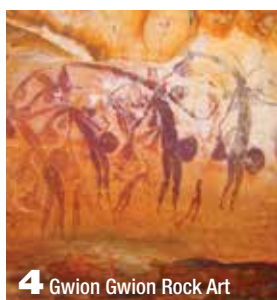

4 Gwion Gwion Rock Art



5 Cape Leveque

1. Cable Beach

One of Australia's most famous beaches, Cable Beach in Broome consists of 22 kilometres of white sand lapped by turquoise waters. A visit to Cable Beach, whether riding a camel or witnessing the sunset, is a must-do experience on any trip to Broome. (see pages 32 to 34 for details)

2. Kimberley Stations

Experience the true seclusion of The Kimberley at a remote station. From sensational fishing to remarkable wildlife and breathtaking gorges, you're sure to get a true sense of the Australian outback. (see pages 45 to 48 for details)

3. Kimberley Aerial Highway

What better way to explore the untouched wilderness of The Kimberley region than with an aerial tour. Fly over some of The Kimberley's most iconic natural wonders, from the Bungle Bungle Range in Purnululu National Park to the tidal movements of Horizontal Falls or vast Lake Argyle. (see pages 26, 27, 38 and 42 for details)

4. Aboriginal Art

Aboriginal Wandjina and Bradshaw rock art can be seen in selected national parks throughout The Kimberley. You can also view the diversity and richness of Aboriginal art in the many galleries in Kununurra. (see pages 26 to 31 and 35 for details)

5. Cape Leveque

Visit an Indigenous community at Cape Leveque on the Dampier Peninsula. Meet the locals, go mud crabbing with a guide, and be sure to see the beautiful pearl shell altar at Beagle Bay. (see pages 26 and 35 for details)

6. Purnululu National Park

The Kimberley has some of the largest and most remote national parks in Australia. The most well known is Purnululu National Park, home to the Bungle Bungle Range. Walk through the narrow Echidna Chasm and experience the acoustics of Cathedral Gorge. Enjoy a day tour from Kununurra, or for a true outback experience stay overnight in the park. (see pages 23, 26 to 31 and 49 for details)

7. Shop for Pearls and Diamonds

Learn about Broome's pearling history on a tour of a working pearl farm. Take a walk through Chinatown and browse the many fine pearl showrooms that line the streets. Tour the Argyle Diamond Mine, the largest open cut diamond mine in the world and perhaps buy a pink diamond from the showroom in Kununurra. (see page 36 for details)

8. Gibb River Road

The Gibb River Road is one of the most famous four wheel drive experiences in Australia! Take in the magnificent scenery on this 660 kilometre stretch between Derby and Kununurra. Make time to stop at Mitchell Plateau home to the beautiful Mitchell Falls. (see pages 23 and 28 for details)

9. Cruising

A Kimberley cruise offers a unique way to view the very best of the rugged North West landscape. View spectacular gorges and caves, feel the force of a thundering waterfall and see the local wildlife. (see pages 10 to 19 for details)

10. Staircase to the Moon

Visit Broome between March and October to witness a breathtaking natural spectacle known as Staircase to the Moon. This natural phenomenon occurs when the full moon rises over the exposed mudflats of Roebuck Bay at extremely low tide creating the optical illusion of a staircase leading to the moon. (see page 6 for dates)

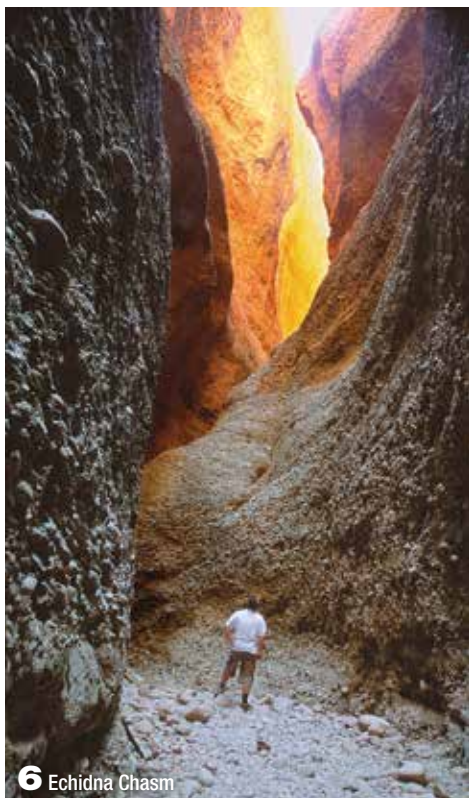

6 Echidna Chasm



7 Pearls



8 Gibb River Road



9 Kimberley Cruising

Our Local Secrets

Movie lovers should not miss...

Digger's Rest Station, the backdrop to the film Australia. See the spectacular Cockburn Ranges and the flat top mountains featured in the film. Make sure to look for the signatures of the stars on the homestead walls.

A great place to take the kids is...

Middle Lagoon located 175 kilometres north of Broome. The lagoon is where locals visit for a safe place to swim all year round. Camp overnight in one of the beach shelters.

Find Broome's best brew at...

Matso's Brewery, renowned for creating beers to reflect The Kimberley region. Try one of their specialty brews in flavours such as mango, ginger, chilli or lychee.

Art lovers should visit...

Raft Point in Doubtful Bay, where you'll find the world's oldest art galleries. More than 50,000 years old, these incredible rock paintings tell the story of the local Worrora people.

For great local seafood...

Try your hand at hooking a Barramundi on a Kimberley cruise. Fishing trips are an excellent way to experience the freshest seafood. The on board chef will be happy to cook your catch!

One of the best places to see a spectacular Kimberley Sunset is at...

Five Rivers Lookout in Wyndham. Marvel at the sweeping views of the King, Forrest, Durack, Pentecost and the Ord rivers flowing into the gulf. Sit back and relax as the sun sets over this remarkable scene.

Kimberley Cruising

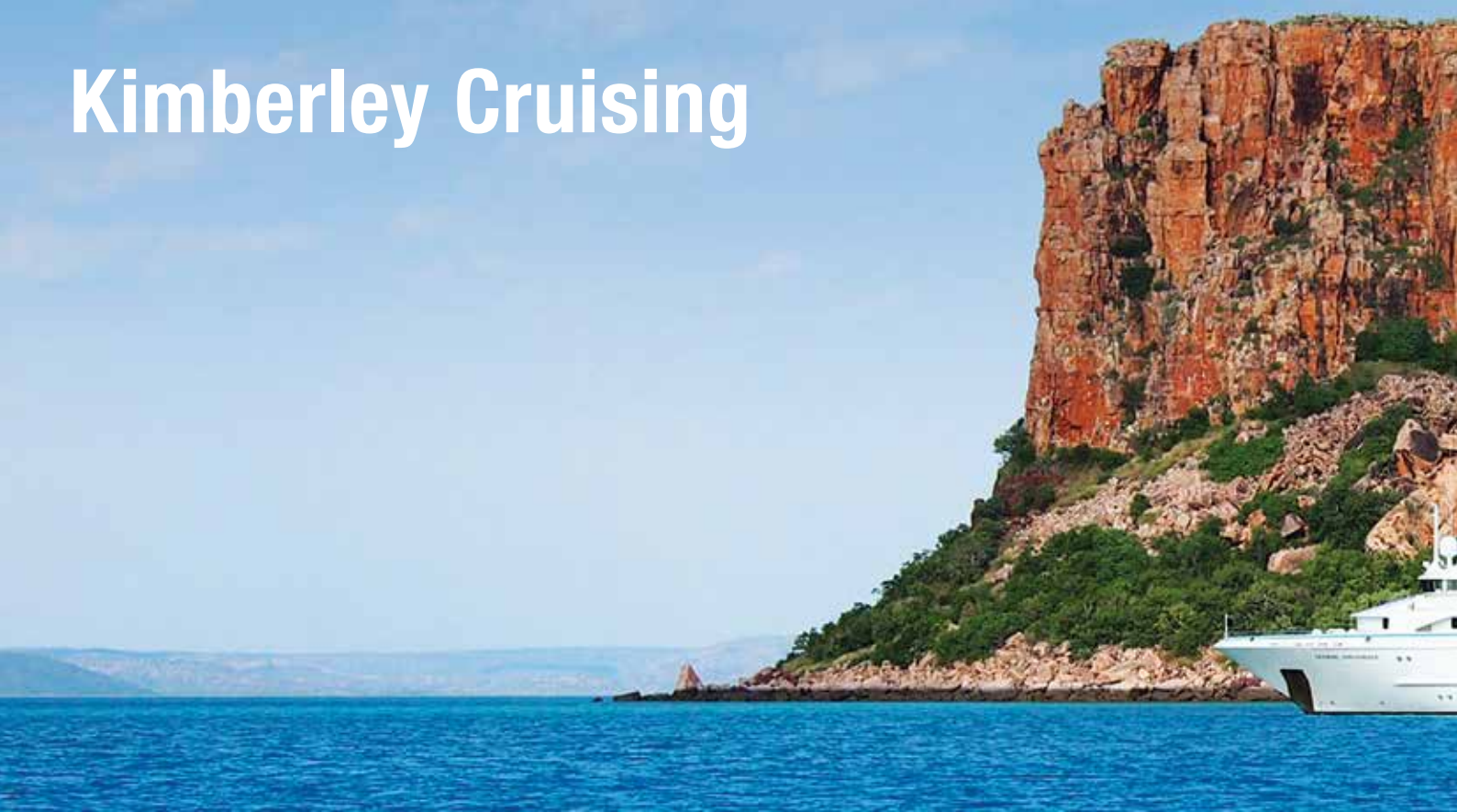

If breathtaking scenery and thrilling experiences are calling your name, then an action-packed adventure cruise of the magnificent Kimberley region may be just what you've been waiting for!

See thundering waterfalls and plunging gorges, ancient cultural history and indigenous rock art. Explore deserted beaches, river inlets and waters famous for an abundance of wildlife. Visit incredible natural attractions and view spectacular scenery that will leave you in awe of this amazing part of Australia to which only a lucky few have ventured.

Witness the natural phenomenon at Montgomery Reef, where white water rapids reveal a vast reef eco-system. Marvel at the tiered waterfall at King Cascade on the Prince Regent River and take a thrilling ride through the Horizontal Falls. Spot crocodiles along the Mitchell River and explore the beaches and ancient rock art on Bigge Island. Just sit back, relax and enjoy the striking scenery that surrounds you.

Of course there's more to The Kimberley coastline than stunning scenery. Reach for the binoculars and marvel at the abundant birdlife. Or embark on an excursion to see some of the oldest Aboriginal rock art galleries on display in natural caves.

A whole new world of underwater wonder is yours to explore at Rowley Shoals Marine Park, 300 kilometres west of Broome. The coral atolls, clear lagoons and incredible marine life are exceptional. Take a dive on Clerke or Mermaid Reef and be on the lookout for everything from colourful coral gardens to various fish species. Come face to face with sea turtles, manta rays and dolphins. It's an underwater playground.

After a full day of exploring the wilderness, dine on sumptuous fresh seafood and enjoy another spectacular Kimberley sunset. Life doesn't get any better than this!

Kimberley Coastal Highlights

Hike inland to waterfalls and be rewarded with a refreshing swim

Tantalise your taste buds with the freshest array of fish and mud crab

Take an exhilarating Zodiac ride to King Cascades

Venture to Talbot Bay in the Buccaneer Archipelago and view the Horizontal Falls by air and boat

Enjoy a helicopter flight over Montgomery Reef and marvel at the sight of the tidal rapids receding to reveal a vast reef eco-system

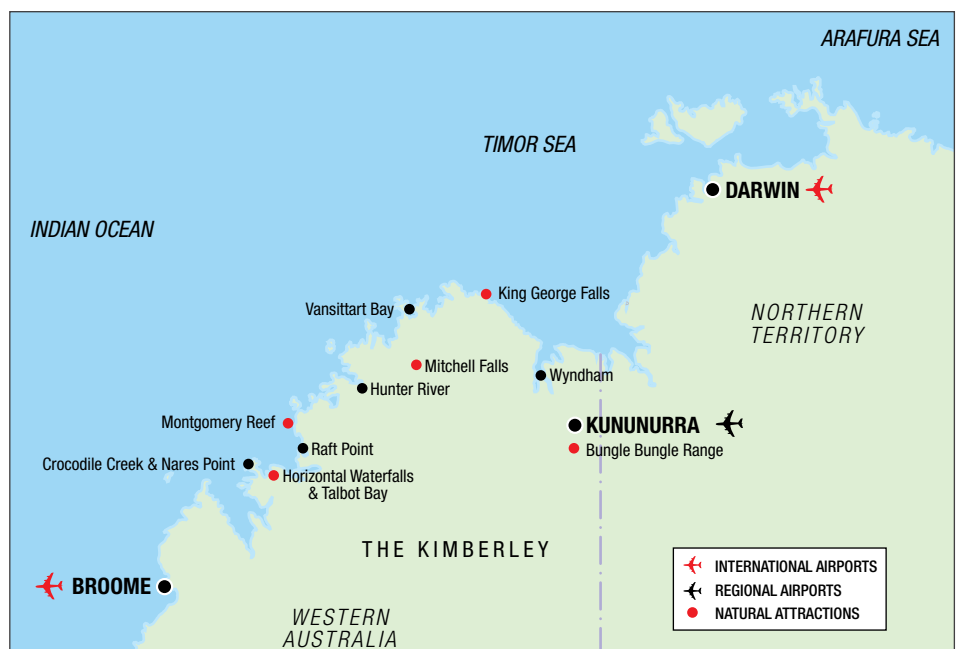



Raft Point

Cruising Tips

With cruises ranging from five to 14 days, there's a cruise experience for everyone. In The Kimberley, small expedition-style ships provide access to remote locations, easily navigating the tidal rivers and rugged coastline. Whether you choose to cruise on a boutique ship with a small group of 14 or a larger vessel that accommodates a maximum of 72, the friendly and knowledgeable crew will make sure you experience all The Kimberley has to offer. Whether you opt for a cabin or a stateroom largely depends on your budget and the level of comfort and amenities you prefer. Staterooms generally have more space and are located on the upper deck. With a vessel and style to suit your needs and a spectacular coast to sail, you're spoilt for choice.

When is the best time to travel?

No matter when you visit The Kimberley coast you will be rewarded with stunning natural beauty, incredible rocky outcrops and amazing

flora and fauna. Cruises generally operate between March and October. The most popular time to travel is in the dry season – usually May through to September – when the temperature is pleasantly warm and there is little chance of rain. Earlier in the season, the waterfalls are generally more spectacular and the vegetation will be lush and green. If you love flora and fauna, then from July to September you'll be rewarded with displays of wildflowers of all colours, shapes and sizes. The weather during this time is sensational. If you're keen on fishing, the Barramundi are abundant during August and September.

Is Adventure Cruising for me?

For those with a sense of adventure, an expedition-style cruise is the perfect choice. Cruise in comfort and style and enjoy the on board facilities while you voyage along the rugged Kimberley coastline. Kimberley cruises are activity based and specifically designed for discerning adventurers. Excursions to shore,

exploring estuaries and fishing expeditions are by tender (small boat), however, there are always crew members on hand to assist guests. Once on land, the walks and hikes are more about being steady on your feet rather than endurance. Some ships have helicopters on board for a bird's eye view of the highest waterfalls. No matter what the day brings, there will always be an activity to suit you, even if that is just sitting on deck and taking in the amazing scenery with a cool drink in hand!

What's included in my cruise cost?

Included in your cruise cost is on board accommodation, all meals and day boat excursions. Other excursions, drinks, items of a personal nature, etc, are not included.

Need more information?

Our team of friendly travel experts are here to help with all your Kimberley cruising questions and can tailor-make a cruise experience just for you.



Kings Cascade

Coral Expeditions



Coral Expeditions is Australia's longest established extended cruise operator and pioneered the concept of small ship expedition style cruising. Choose to cruise aboard the state-of-the-art, 63 metre boutique expedition ship Coral Discoverer or the legendary 35 metre catamaran Coral Expeditions I, both purpose built in Australia for Australian cruising conditions. Each ship offers a choice of spacious accommodation with en suites and air-conditioning throughout. Sundecks, fully stocked bars, lecture lounge plus the 'Xplorer' and a fleet of Zodiacs complete the experience.

Throughout your voyage of discovery, you will explore in the company of an all-Australian crew and team of expert guest lecturers. Gain a thorough understanding of The Kimberley's unique landscapes, flora and fauna and ancient art sites; insights that only true 'local knowledge' can deliver. Experience The Kimberley's big rivers, stunning waterfalls and the tidal phenomena aboard a fleet of inflatable Zodiacs and the unique, specially designed excursion vessel 'Xplorer'. Accommodating all guests in individual padded seating and featuring an on board toilet and a roof for sun protection, aboard the 'Xplorer' you will be able to discover much more of The Kimberley.



10 Night Broome to Darwin Expedition Cruise

When you join Coral Expeditions on a 10 night expedition cruise between Broome and Darwin you won't just see The Kimberley but truly experience it! Discover remarkable Montgomery Reef and the amazing natural phenomenon of the Horizontal Falls of Talbot Bay. Explore the Mitchell Plateau and cruise the King George River with its towering 80 metre twin falls.

ITINERARY:

- Day 1: Depart Broome
- Day 2: Lacepede Islands
- Day 3: Horizontal Falls and Buccaneer Archipelago
- Day 4: Ruby Falls and Raft Point
- Day 5: Doubtful Bay and Montgomery Reef
- Day 6: Prince Regent River and King Cascades
- Day 7: Careening Bay and Bigge Island
- Day 8: Hathaway's Hideaway and Mitchell Falls
- Day 9: Vansittart Bay and Jar Island
- Day 10: King George River and Falls
- Day 11: Arrive Darwin

DEPARTURE INFORMATION:

From Broome

Coral Expeditions I:

2017: Apr 10, May 1, 22, Jul 24, Aug 14, Sep 4, 25

Coral Discoverer:

2017: Jul 10, 31, Aug 21, Sep 11

From Darwin

Coral Expeditions I:

2017: Apr 21, Jul 14, Aug 4, 25, Sep 15

Coral Discoverer:

2017: Apr 7, 28, May 19, Jun 9, 30, Jul 21, Aug 11, Sep 1

Note: Cruise is also available in reverse. The itinerary is an indication of the destinations visited and activities on offer. Throughout the expedition changes may be necessary to maximise your expedition experience. Allowances may need to be made for seasonal variations, weather, tidal conditions and any other event that may affect the operation of the vessel.

Vessel Features:

- Air-conditioning
- Sundeck
- Modern lounges and dining room
- Gift shop
- Comprehensive reference library
- Maximum of 46 guests (Coral Expeditions I)
- Maximum of 72 guests (Coral Discoverer)

Cabin Features:

- Air-conditioning
- Private en suite
- Choice of twin or double beds
- Daily servicing

Includes:

- On board accommodation
- All meals and 24 hour tea and barista style coffee
- Post mix soft drink on board
- House beer and wine with the lunch and dinner services
- Captain's welcome and farewell drinks
- Landing fees
- Services of expedition staff including lectures, briefings and presentations
- Shore excursions aboard the unique 'Xplorer' and fleet of Zodiacs

Available at an Extra Charge:

- Wi-Fi
- Transfers
- Helicopter flight to Mitchell Falls
- Telephone and internet charges
- Laundry charges
- Alcoholic beverages
- Optional activities



Coral Expeditions I



King Cascades

CORAL EXPEDITIONS I



- 6 Deluxe Staterooms
- 4 Staterooms
- 8 Upper Deck Staterooms
- 5 Cabins

CORAL DISCOVERER

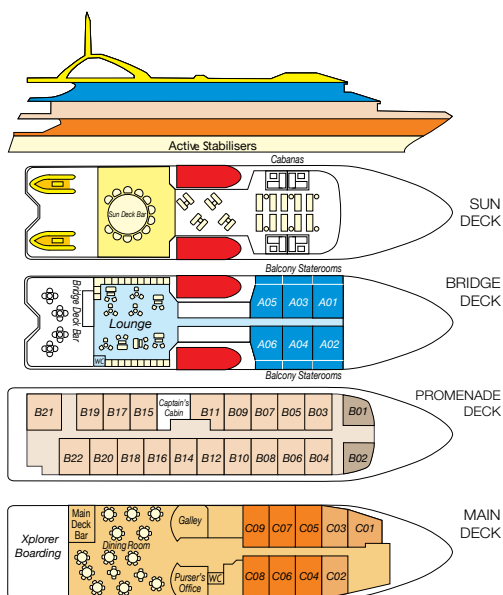

- Main Deck Category B
- Promenade Deck Category B
- Main Deck Category A
- Promenade Deck Category A
- Bridge Deck Balcony



Stateroom, Coral Discoverer



King George Falls



Note: Children: 12 to 18 years – adult prices apply. Not suitable for children under 12 years. A fuel levy may apply. Other Coral Expeditions destinations include: Great Barrier Reef, Cape York and Arnhem Land, New Zealand, Papua New Guinea, Islands of the South Pacific, Spice Islands and Raja Ampat.

PRICE	2017			
CORAL EXPEDITIONS I	CABIN	STATEROOM	UPPER DECK STATEROOM	DELUXE STATEROOM
10 Night Broome to Darwin Expedition Cruise (or reverse)	\$7,980	\$9,180	\$9,680	\$10,180

PRICE	2017				
CORAL DISCOVERER	MAIN DECK B	MAIN DECK A	PROMENADE DECK B	PROMENADE DECK A	BRIDGE DECK
10 Night Broome to Darwin Expedition Cruise (or reverse)	\$9,980	\$10,380	\$10,880	\$11,280	\$12,480

The prices in this brochure are intended as a guide only. Prices are in Australian Dollars and are per person twin share, unless otherwise specified. Please refer to page 4 for an explanation of "From" prices and ask your travel agent for our best price.

The Great Escape Charter Company



Take a journey of discovery with The Great Escape Charter Company to the magnificent Kimberley coast.

MV Great Escape is a 26 metre custom built catamaran, designed to take you on an adventure of exploration to ancient and largely inaccessible parts of Australia's awe inspiring north west coast in complete style. With only 14 guests and a crew of six, the team at Great Escape Charter Company offer intimate and personalised cruises. A specially designed eight person spa is located on the foredeck, the perfect place to enjoy an ice-cold beverage and a spectacular Kimberley sunset. Disconnection is encouraged however satellite Wi-Fi is available as well as real time television.

MV Great Escape operates three tenders offering variety and personalisation to the already small group. The dedicated on board helicopter adds incredible perspective to the many aerial adventure activities included in each itinerary.

4 Night Quintessential Kimberley Coast Escape

This Quintessential Kimberley Coast Escape cruise captures the incredible Kimberley coastline over five days, including Montgomery Reef, Raft Point and the intriguing Aboriginal rock art and the stunning Sale River. Take the opportunity to see the famous Horizontal Falls from the air.

Spend time in the tenders viewing the spectacular waterfalls, swim in a freshwater rock pool and try your hand at fishing. Witness a host of flora and fauna with a good chance of spotting crocodiles. The birdlife is wonderful and the movement of the tides is amazing.

ITINERARY:

- Day 1: Depart Broome
- Day 2: Raft Point, Doubtful Bay
- Day 3: Sale River
- Day 4: Montgomery Reef
- Day 5: Arrive Broome

DEPARTURE INFORMATION: From Broome

- 2017: Aug 6, 14
- 2018: Sep 9

6 & 7 Night Kings Of The Kimberley Northern Gorges

This cruise covers the best of the northern Kimberley Coast between Wyndham and the Mitchell Plateau, including the spectacular Kimberley icon, King George Falls. You can choose to cruise from north to south (6 nights), or in reverse (7 nights). The cruise includes a scenic charter flight across the northern Kimberley, from Kununurra to the Mitchell Plateau or in reverse, and a scenic helicopter flight over the Mitchell Falls.

ITINERARY:

- Day 1: Scenic flight from Kununurra to Mitchell Plateau
- Day 2: Mitchell River
- Day 3: Vansittart Bay
- Day 4: Drysdale River
- Day 5: King George River
- Day 6: Atlantis Bay
- Day 7: Berkeley River
- Day 8: Wyndham to Kununurra

DEPARTURE INFORMATION: From Kununurra (Fly/Cruise)

- 2017: Apr 7, 21
- 2018: Apr 6, 20, May 4

From Kununurra (Cruise/Fly)

- 2017: Apr 1, 15, Jun 24
- 2018: Mar 31, Apr 14, 28

7 Night Southern Kimberley Experience

Travel The Kimberley coast from Broome through to Hunter River/Mitchell Plateau and everywhere in between. Experience the natural majesty of the Prince Regent River, explore ancient tributaries and natural phenomena such as Montgomery Reef and the famous Horizontal Falls.

ITINERARY:

- Day 1: Depart Broome
- Day 2: Buccaneer Archipelago, Horizontal Falls
- Day 3: Raft Point, Doubtful Bay
- Day 4: Montgomery Reef
- Day 5: Camden Harbour
- Day 6: King Cascade
- Day 7: Camp Creek, Careening Bay
- Day 8: Scenic helicopter flight over Mitchell Falls, scenic flight to Broome

Note: Cruise is also available in reverse.

DEPARTURE INFORMATION: From Broome (Cruise/Fly)

- 2017: Jul 8, 23, Aug 18, Sep 6, 21
- 2018: Jul 23, Aug 7, 22, Sep 13

From Broome (Fly/Cruise)

- 2017: Jun 30, Jul 15, 30, Aug 25, Sep 13, 28
- 2018: Jul 30, Aug 14, 29, Sep 20

13 Night Kimberley Classic Adventure

This cruise explores the length of The Kimberley coast between Broome and Wyndham. The Kimberley Classic Adventure is recommended for those who truly want to experience all there is to offer along this magnificent wilderness frontier.

ITINERARY:

- Day 1: Depart Broome
- Day 2: Yampi Sound, Talbot Bay
- Day 3: Horizontal Falls, Raft Point
- Day 4: Doubtful Bay, Sale River
- Day 5: Montgomery Reef, Langii
- Day 6: Camden Harbour, Prince Regent River
- Day 7: King Cascade
- Day 8/9/10: Hunter River Bigge Island/ Mitchell River
- Day 11: Vansittart Bay
- Day 12: King George River
- Day 13: Berkeley River
- Day 14: Arrive Wyndham

Note: Cruise is also available in reverse.

DEPARTURE INFORMATION: From Broome

- 2017: May 13, Jun 10
- 2018: May 26, Jun 23

From Wyndham

- 2017: May 27
- 2018: May 12, Jun 9, Jul 7

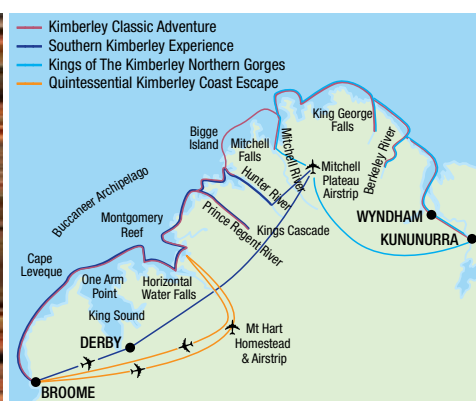

Vessel Features:

- Air-conditioning
- Spa on deck
- Helicopter
- Indoor and alfresco dining
- Coffee machine
- Extensive reading library
- Media library
- Audio visual equipment
- Maximum of 14 guests

Cabin Features:

- Choice of queen bed or twin beds
- Private en suite
- Mini refrigerator • Flat screen TV
- CD/DVD player • Daily servicing

Includes:

- On board accommodation
- All meals on board
- All non-alcoholic beverages on board
- Welcome pack
- Laundry service
- Daily activities and shore excursions
- Great Escape Charter Company gift pack
- Transfers from Broome or Kununurra accommodation/Airport

Available at an Extra Charge:

- Wi-Fi
- Optional helicopter flights
- Provisioning of alcohol
- Satellite phone and fax



UPPER DECK

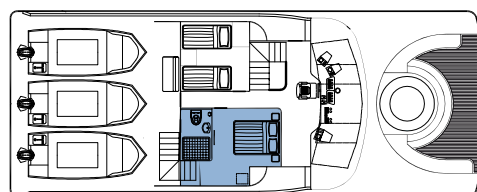

MAIN DECK

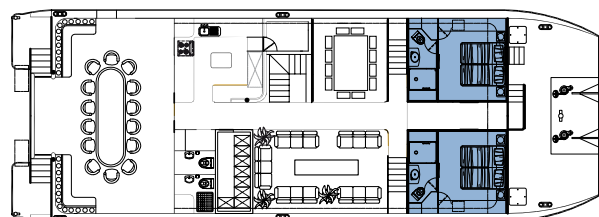

LOWER DECK

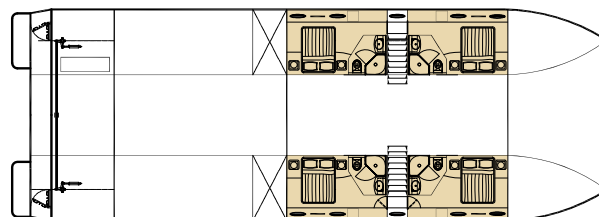

Horizon View Stateroom Panoramic View Stateroom



Note: Children: 0 to 16 years – exclusive charters only. Due to weather, tides or mechanical reasons the itinerary may be subject to change without notice. Guests should have a good range of mobility and reasonable level of fitness. * Reduced prices available for departures in September 2017: Horizon View Stateroom **\$9,868** per person twin share, Panoramic View Stateroom **\$10,820** per person twin share and in September 2018: Horizon View Stateroom **\$10,165** per person twin share, Panoramic View Stateroom **\$11,145** per person twin share.

PRICE	2017		2018	
	HORIZON VIEW STATEROOM	PANORAMIC VIEW STATEROOM	HORIZON VIEW STATEROOM	PANORAMIC VIEW STATEROOM
4 Night Quintessential Kimberley Coast Escape	\$5,244	\$5,769	\$5,244	\$5,796
6 Night Kings of The Kimberley Northern Gorges	\$10,540	\$11,500	\$11,068	\$12,075
7 Night Kings of The Kimberley Northern Gorges	\$12,210	\$13,330	\$12,820	\$13,996
7 Night Southern Kimberley Experience*	\$11,610	\$12,730	\$11,958	\$13,111
13 Night Kimberley Classic Adventure	\$17,810	\$19,890	\$18,700	\$20,885

The prices in this brochure are intended as a guide only. Prices are in Australian Dollars and are per person twin share, unless otherwise specified. Please refer to page 4 for an explanation of "From" prices and ask your travel agent for our best price.

Kimberley Quest



The Kimberley Quest II is a 25 metre expedition vessel which is equipped with its own helipad, spa and has been custom built for the remote Kimberley region, allowing easy access to discover many remote and untouched locations. Accommodating just 18 passengers and with a choice of four cabin styles – each with a private en suite, enjoy the pristine Kimberley wilderness in comfort and style.

Carrying three excursion tenders, days are filled with a myriad of activities, exploring the waterways with experienced guides who are always on hand to share their extensive knowledge of the region and bring your adventure to life. Witness the vast tidal creeks, rugged gorges, massive waterfalls and pristine beaches. With plenty of time to swim in freshwater pools, explore historical sites and witness ancient rock art galleries. Have a go at landing the elusive Barramundi, go croc spotting, beach walking or observe the many species of wildlife – the choice is yours to do as much as you like, or as little as you wish!

7 Night Southern Quest

Many icons of The Kimberley can be found in the southern region. This area is prolific with islands, whirlpools, inlets and pockets of rainforest. Visit the famous Horizontal Waterfalls and Montgomery Reef.

ITINERARY:

- Day 1: Depart Broome
- Day 2: Buccaneer Archipelago, Dugong Bay, Talbot Bay
- Day 3: Collier Bay, Montgomery Reef
- Day 4: Doubtful Bay, Sale River, Raft Point
- Day 5: Langii, Kuri Bay, Camden Harbour
- Day 6: Prince Regent River, King Cascade, Cathedral Falls
- Day 7: Camp Creek, Careening Bay
- Day 8: Hunter River, scenic flight over Mitchell Falls, return flight back to Broome

Note: Cruise is also available in reverse.

DEPARTURE INFORMATION:

From Broome (Cruise/Fly)

- 2017: Jun 13, 27, Jul 20, Aug 14, 29, Sep 12
- 2018: Jun 19, Jul 3, 17, 31, Aug 14, 28

From Hunter River (Fly/Cruise)

- 2017: Mar 28, Jun 20, Jul 4, 27, Aug 21, Sep 5, 19
- 2018: Jun 26, Jul 10, 24, Aug 7, 21, Sep 4

7 Night Northern Quest

Renowned for its massive gorges and river systems, extensive waterfalls, World War II relics and incredible Bradshaw rock art sites, the northern Kimberley is an experience not to be missed. Exploring between Wyndham and the Mitchell River, this cruise visits Kimberley icons such as the King George Falls, Berkeley River and Drysdale River. This seven night northern Kimberley cruise operates just after the wet season when the waterfalls are spectacular.

ITINERARY:

- Day 1: Broome to Mitchell River
- Day 2: Vansittart Bay, WWII DC3 site
- Day 3: Napier Broome Bay
- Day 4: Drysdale River
- Day 5: Glycosmis Falls, Pangali Cove, Koolama Bay
- Day 6: King George River
- Day 7: Berkeley River, Cambridge Gulf
- Day 8: Wyndham Port

Note: Cruise is also available in reverse.

DEPARTURE INFORMATION:

From Wyndham (Cruise/Fly)

- 2017: Mar 21, May 16
- 2018: Apr 10, 24

From Mitchell River (Fly/Cruise)

- 2017: May 23
- 2018: Apr 17, May 1

9 Night Adventure Quest

An extensive exploration of the southern Kimberley, visiting many unknown sights that are rarely visited. Enjoy pristine beaches, swimming holes, historical Aboriginal art sites and Barramundi fishing. This Broome to Broome loop visits icons such as the Horizontal Waterfalls, Montgomery Reef and the King Cascades waterfall. Taking in all there is to offer of the southern region, this quest involves lots of exploring and unforgettable scenery.

ITINERARY:

- Day 1: Broome to Cape Leveque
- Day 2: Buccaneer Archipelago, Dugong Bay, Talbot Bay
- Day 3: Surprise Falls, Secure Bay
- Day 4: Montgomery Reef, Sale River and Raft Point
- Day 5: Doubtful Bay, Red Cone Creek, Camden Sound
- Day 6: Camden Harbour, Rothsay Water
- Day 7: Prince Regent River, King Cascade, Cathedral Falls
- Day 8: Hanover Bay, Booby Island
- Day 9: Heywood & Champagne Island
- Day 10: Arrive Broome

DEPARTURE INFORMATION:

From Broome

- 2017: Jul 11, Aug 3
- 2018: Sep 11, 20

13 Night Ultimate Quest

The ultimate wilderness cruise along the whole Kimberley coast. Cruising between Broome and Wyndham, this adventure has it all. Witness the amazing icons including the King George Falls, Berkeley River and the Horizontal Waterfalls.

ITINERARY:

- Day 1: Broome, Cape Leveque
- Day 2: Buccaneer Archipelago, Dugong Bay, Talbot Bay
- Day 3: Collier Bay, Montgomery Reef, Red Cone Creek
- Day 4: Doubtful Bay, Sale River, Raft Point
- Day 5: Langii, Kuri Bay, Camden Harbour
- Day 6: Prince Regent River, King Cascade, Cathedral Falls
- Day 7: Careening Bay, Bigge Island
- Day 8: Mitchell River, Surveyors Creek
- Day 9: Vansittart Bay, WWII DC3 site
- Day 10: Drysdale River
- Day 11: Glycosmis Falls, Pangali Cove, Koolama Bay
- Day 12: King George River
- Day 13: Berkeley River, Cambridge Gulf
- Day 14: Wyndham, Kununurra

Note: Cruise is also available in reverse.

DEPARTURE INFORMATION:

From Broome

- 2017: Mar 8, Apr 5, May 3
- 2018: Mar 27, May 22

From Wyndham

- 2017: Apr 19, May 31
- 2018: Mar 13, May 8, Jun 5

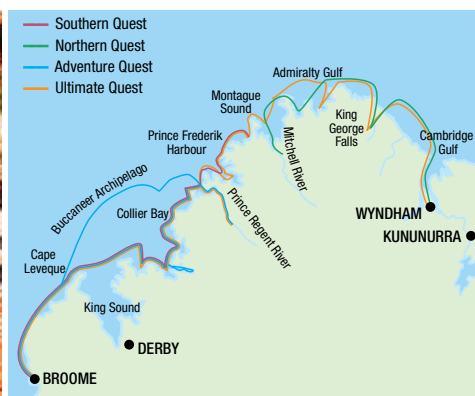
**Vessel Features:**

- Helipad • Spa
- Spacious sundeck
- Indoor and outdoor alfresco areas
- Comprehensive library • Cable TV
- CD/DVD player • Maximum of 18 guests

Cabin Features:

- Air-conditioning • Private en suite • Refrigerator
- Viewing window • 240 volt power • Daily servicing

Includes:

- On board accommodation
- All meals on board
- 24 hour tea and coffee station
- Daily excursions • Experienced guides
- Return transfers from accommodation

Available at an Extra Charge:

- Wi-Fi • Alcoholic beverages and mixers
- Scenic helicopter flights

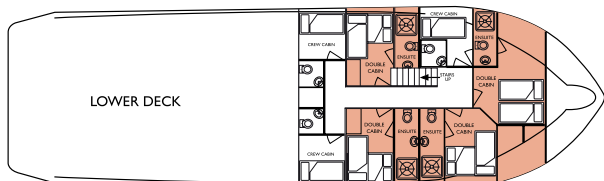
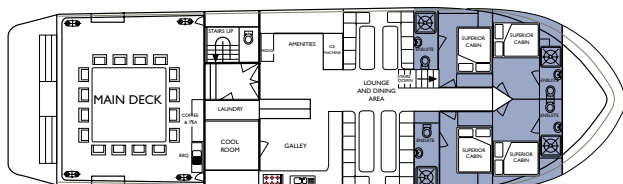
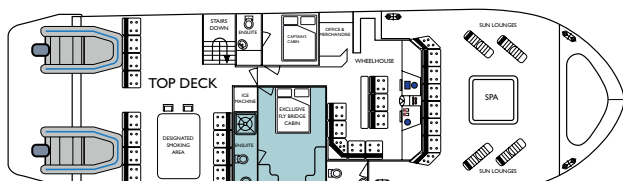

- Double Cabin
- Superior Cabin
- Flybridge Cabin



Note: Children: 0 to 12 years – not catered for. Due to weather, tides or mechanical reasons the itinerary may be subject to change without notice.

PRICE	2017			2018		
CRUISE	DOUBLE CABIN	SUPERIOR CABIN	FLYBRIDGE CABIN	DOUBLE CABIN	SUPERIOR CABIN	FLYBRIDGE CABIN
7 Night Southern/Northern Quest	\$10,933	\$12,824	\$14,238	\$10,933	\$12,824	\$14,238
9 Night Adventure Quest	\$11,706	\$13,597	\$15,009	\$11,706	\$13,597	\$15,009
13 Night Ultimate Quest	\$16,358	\$19,951	\$21,236	\$16,358	\$19,951	\$21,236

The prices in this brochure are intended as a guide only. Prices are in Australian Dollars and are per person twin share, unless otherwise specified. Please refer to page 4 for an explanation of "From" prices and ask your travel agent for our best price.



North Star Cruises Australia – True North



North Star Cruises Australia is the winner of numerous accolades for excellence and offers a variety of Kimberley adventure cruises on board the True North.

All cruises are activity based and specifically designed for the most discerning adventurer. The True North allows guests to experience wilderness in surroundings more akin to one of the world's most exclusive hotels. Guests take advantage of lavish on board vantage points including a sundeck, observation lounge and an alfresco bar. The ship's biologist presents interpretative information on wall-mounted screens in the ship's lounge. A guest limit of 36 and a crew of 22 ensure attention to detail and excellence in service. The True North has a helicopter on board at all times and offers three levels of accommodation. All cabins and staterooms are spacious and feature en suites.

The True North is truly one of the finest adventure cruise ships in the world.

5 Night Coral Atoll Cruise

The Rowley Shoals are perhaps the most exclusive coral environment in the world – less than 300 visitors a year are fortunate enough to give testimony to the brilliance of this remote wilderness. The atoll's crystal clear waters are home to more than 750 species of fish and 250 species of coral – a true Mecca for divers, snorkellers and fishing enthusiasts alike. True North's flexible itinerary caters for all.

ITINERARY:

- Day 1: Depart Broome
- Day 2: Clerke Reef, The Aquarium
- Day 3: Clerke Reef, Bedwell Island
- Day 4: Clerke Reef, The Dinghy Channels
- Day 5: Mermaid Reef, The Cod Hole and the Northern Wall
- Day 6: Arrive Broome

DEPARTURE INFORMATION: From Broome

- 2017: Sep 10, 16, 21
- 2018: Sep 8, 13

7 Night Kimberley Snapshot

For those pressed for time – here is the flagship Kimberley Ultimate itinerary condensed into a single week voyage! This cruise features several Kimberley icons including the King George Falls, the Hunter River, the Prince Regent River, Montgomery Reef and the Horizontal Falls.

ITINERARY:

- Day 1: Depart Broome
- Day 2: Horizontal Falls, Doubtful Bay
- Day 3: Sale River, Montgomery Reef
- Day 4: Prince Regent River, King Cascade
- Day 5: Hunter River, Jackson Falls
- Day 6: Eagle Falls, Koolama Bay
- Day 7: King George Falls, Tranquil Bay
- Day 8: Arrive Wyndham

DEPARTURE INFORMATION: From Broome

- 2017: May 6, 27, Jun 17, Jul 8, 29, Aug 19
- 2018: May 5, 26, Jun 16, Jul 7, 28, Aug 18

10 Night Kimberley Waterfalls

Experience the emotive beauty that accompanies the end of the wet season. Witness The Kimberley's renowned summer storms and spectacular light shows and marvel at the thundering waterfalls and swollen billabongs, while relaxing in style on board the True North.

ITINERARY:

- Day 1: Depart Wyndham
- Day 2: King George River & Falls
- Day 3: Eagle Falls & Bradshaw Art
- Day 4: Surveyors Creek & Mitchell River
- Day 5: Voltaire Passage
- Day 6: Hunter River & Jackson Falls
- Day 7: Melaleuca Falls
- Day 8: Prince Regent River & King Cascade
- Day 9: Raft Point & Montgomery Reef
- Day 10: Horizontal Falls & Talbot Bay
- Day 11: Arrive Broome

DEPARTURE INFORMATION: From Broome

- 2017: Mar 23, 12
- 2018: Mar 22, 11

From Wyndham

- 2017: Apr 2
- 2018: Apr 1

13 Night Kimberley Ultimate

North Star's flagship cruise in the magnificent Kimberley. Experience a wild and beautiful panorama of rugged mountains, spectacular gorges and majestic waterfalls. View unexplained rock art, extraordinary wildlife and monster Barramundi.

ITINERARY:

- Day 1: Depart Wyndham
- Day 2: King George River and Falls, Koolama Bay
- Day 3: Eagles Falls, Vansittart Bay
- Day 4: Vansittart Bay
- Day 5: Mitchell River
- Day 6: Prince Frederick Harbour, Swift Bay
- Day 7: Prince Frederick Harbour, Roe River
- Day 8: Hunter River
- Day 9: Prince Regent River, Melaleuca Falls
- Day 10: Prince Regent River, King Cascade
- Day 11: Sale River, Montgomery Reef
- Day 12: Raft Point
- Day 13: Horizontal Falls, Talbot Bay
- Day 14: Arrive Broome

DEPARTURE INFORMATION: From Wyndham

- 2017: Apr 22, May 13, Jun 3, 24, Jul 15, Aug 5
- 2018: Apr 21, May 12, Jun 2, 23, Jul 14, Aug 4

**Vessel Features:**

- Internet facilities • Sundeck
- Observation lounge
- Ship's lounge • Alfresco bar
- Dining room • Expedition boats (6)
- Helicopter • Maximum of 36 guests

Cabin Features:

- Private en suite • Air-conditioning
- In-cabin entertainment • Satellite phone

Includes:

- On board accommodation
- All meals and non-alcoholic beverages on board
- Daily guided tours and activities (scenic flights extra charge)
- Fishing and snorkelling equipment
- Transfers from/to Broome and Kununurra

Available at an Extra Charge:

- Alcoholic beverages
- Merchandise • Scenic flights



Explorer Class Stateroom

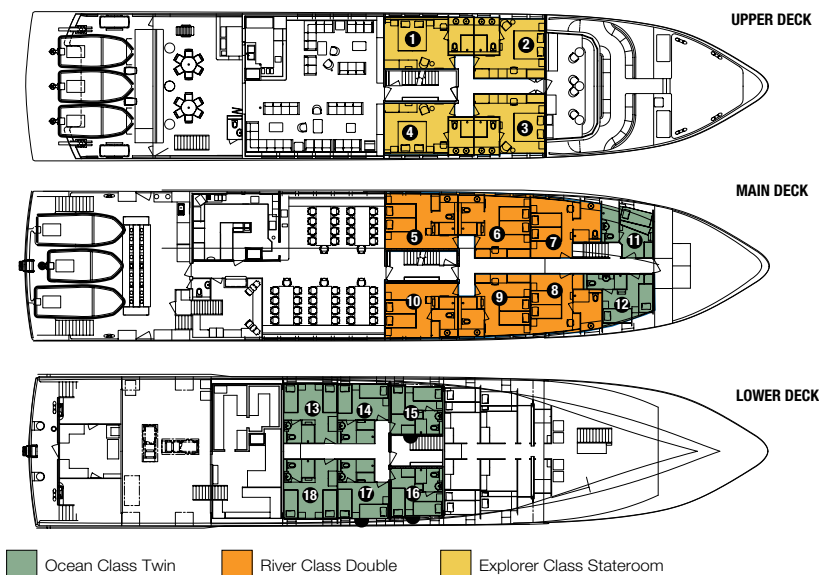

Note: Children: 0 to 12 years – child prices on application. Due to prevailing conditions and local arrangements itineraries are subject to change without notice. Prices also available for other True North destinations including: Abrolhos Islands, Ningaloo Reef and the Monte Bello Islands, West Papua, Papua New Guinea, Sydney and Eyre Peninsula.

PRICE	2017			2018		
	OCEAN CLASS TWIN	RIVER CLASS DOUBLE	EXPLORER CLASS STATEROOM	OCEAN CLASS TWIN	RIVER CLASS DOUBLE	EXPLORER CLASS STATEROOM
5 Night Coral Atoll Cruise	\$5,695	\$7,695	\$8,695	\$5,995	\$7,995	\$8,995
7 Night Kimberley Snapshot	\$12,995	\$15,995	\$17,995	\$13,595	\$16,995	\$18,995
10 Night Kimberley Waterfalls	\$16,595	\$19,995	\$22,995	\$17,995	\$20,995	\$23,995
13 Night Kimberley Ultimate	\$20,995	\$24,995	\$28,995	\$21,995	\$25,995	\$29,995

The prices in this brochure are intended as a guide only. Prices are in Australian Dollars and are per person twin share, unless otherwise specified. Please refer to page 4 for an explanation of "From" prices and ask your travel agent for our best price.



Holiday Packages



Lake Argyle

Planning a holiday to The Kimberley and Broome is easy with our selection of great Holiday Packages. We've put together a range of the most popular getaways including exclusive packages created just for you. Featuring a choice of accommodation options and local experiences, these are a fantastic way to discover The Kimberley region and Broome. If you're looking for the best holiday at the best price, our package deals offer exceptional value for money!

3 Night Seashells Broome Getaway



From price based on 3 night package valid 1 Nov 17 – 23 Dec, 3 Jan – 31 Mar 18. ^Saving is per room.

From **\$219***
per person twin share

Indulge in the peace and tranquillity of this tropical paradise.

Stylish one and two bedroom fully self-contained apartments are nestled among lush and secluded gardens just 300 metres from Cable Beach. All feature well appointed kitchens and laundries, spacious lounge and dining areas, with the one bedroom apartments also featuring a jet bath. Relax in the tropical gardens or by the large temperature controlled free-form island swimming pool, children's paddling pool and comfortable sun lounge areas.

The property is a short stroll from Cable Beach and only five minutes drive from Broome town centre. Enjoy some of the local activities and attractions during your stay, including sunset cruises, scenic flights and camel rides.

Also nearby is an exquisite pearl retail showroom and a variety of alfresco cafés, restaurants, shops and pubs. In downtown Broome there are additional activities including the Sun Picture outdoor cinema, shopping centre, weekend markets and art galleries. Seashells Broome is the perfect place for a relaxing getaway.

Includes:

- 3 nights accommodation in a 1 Bedroom
- Note: Refer to page 38 for further details on this property.

BONUS: FREE Night Offer: Stay 3 nights, pay for 2.



3 Night Broome Experience



SAVE UP TO
\$82[^]



From price based on 3 night package valid 1 Nov – 23 Dec 17, 3 Jan – 31 Mar 18. ^Saving is per room.

From **\$429***
per person twin share

Relax and enjoy yourself in the laidback town of Broome. Spend a few days pre or post your Kimberley cruise exploring the highlights of Broome.

Enjoy a half day tour of Broome including a visit to famous Cable Beach and Chinatown. Discover the ancient sandstone formations at Gantheaume Point before sampling a beer at Matso's Brewery.

Discover how the rare and beautiful Australian South Sea Cultured Pearl is produced at the Willie Creek Pearl Farm. Learn about the intricate processes of today's modern cultured pearling industry.

Includes:

- 3 nights accommodation in a 1 Bedroom at Seashells Broome
- Return transfers from Broome Airport
- Half Day Broome Town and Cable Beach tour
- Half Day Willie Creek Pearl Farm tour



We **love** it!



Self Drive Pack

We provide a Co-Pilot Kit for all Self Drive Holidays (conditions apply).

What's included:

- backpack
- road atlas
- city maps
- driving instructions
- location information

Kids Backpacks

Entertain the kids with a **FREE** backpack complete with a colouring book and pencils.

Available to kids under 12 years, simply request at time of booking.



There's no better way to discover The Kimberley region and Broome than on a self drive holiday. Travelling by road is undoubtedly one of the best ways to explore and our selection of hand-crafted itineraries will take you to some of the most popular locations. Each itinerary incorporates car hire, accommodation and local experiences, along with a personalised Co-Pilot Kit to assist you along the way. Make your next road trip truly memorable with one of our Self Drive Holidays.

4 Day Kimberley Gorges Broome to Broome



Travel along part of the Gibb River Road to some of the most spectacular gorges in The Kimberley, including Bell Gorge, Galvans Gorge, Windjana Gorge and Geikie Gorge.

Day 1: Broome via Derby to Bell Gorge Wilderness Lodge (442km)

Collect your car from Broome and drive to Derby, visit the Boab Prison Tree before beginning your adventure on the Gibb River Road. The destination is Bell Gorge Wilderness Lodge overlooking the King Leopold Escarpment, your accommodation for the next two nights. (D)



Day 2: Bell Gorge and Galvans Gorge

Spend the day exploring some of The Kimberley's most scenic gorges. Enjoy hiking and swimming beneath the waterfall in Bell Gorge, see rock art in Galvans Gorge or swim at Barnett River Gorge. (BD)

Day 3: Windjana Gorge and Tunnel Creek to Fitzroy Crossing (290km)

Head to Windjana Gorge National Park with its 300 metre high cliffs, white sand and Freshwater crocodiles on the banks of the Lennard River. Travel to Tunnel Creek and wade through the 750 metre long tunnel. Continue on to Fitzroy Crossing. Overnight at Fitzroy River Lodge. (B)

From price based on 3 night package valid 1 May – 27 Sep 17. Car hire is based on Group W. Conditions apply.

From **\$1069***
per person twin share

Day 4: Fitzroy Crossing to Broome (395km)

Discover the beauty of Geikie Gorge National Park today with a ranger or Indigenous guided cruise through the gorge (own expense). Return to Broome. The 4WD is booked until the following day and should be dropped off by the same time it was picked up on Day 1 to avoid any additional charges.

Includes:

- 3 nights accommodation
- 4 days 4WD rental with GPS
- Co-pilot self drive kit
- Meals as indicated (B = breakfast, D = dinner)

We love it!

5 Day Kimberley Discovery Broome to Kununurra



Discover The Kimberley region's ancient landscape of stunning rivers and gorges and the signature Bungle Bungle Range.

Day 1: Broome to Fitzroy Crossing (395km)

Collect your car from Broome and head east into The Kimberley to Fitzroy Crossing, gateway to the spectacular Geikie Gorge National Park, some 20 kilometres away.

Regular boat trips are available on the spectacular gorge and are well worth the trip (own expense). Overnight at Fitzroy River Lodge.

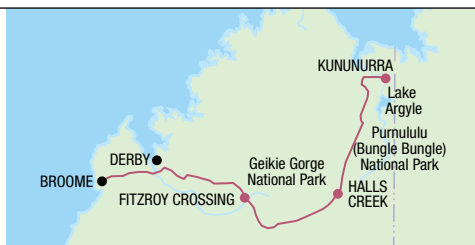

Day 2: Fitzroy Crossing to Halls Creek (290km)

Head to the town of Halls Creek, the site of Western Australia's first gold discovery in 1885. Today, the town serves as a service centre for modern day mining ventures. Overnight at Kimberley Hotel, Halls Creek.

Day 3: Halls Creek to Kununurra (361km)

Travel north through The Kimberley, past the Bungle Bungle Range to Kununurra. The largest diamond mine in the world, the Argyle Diamond Mine, is in the area and tours are available through the mine (own expense). Overnight at Kununurra Lakeside Resort. (B)

From price based on 4 night package valid 1 Nov 17 – 31 Mar 18. Car hire is based on Group C and D. Conditions apply.

From **\$705***
per person twin share

Day 4: Kununurra

Day at leisure to explore this fascinating area. Helicopter and 4WD tours operate from Kununurra into the Bungle Bungle Range (own expense). Overnight at Kununurra Lakeside Resort. (B)

Day 5: Kununurra

A free day to discover more of Kununurra. The vehicle is available all day and should be dropped off tomorrow by the same time as it was picked up on Day 1 to avoid any additional charges.

Includes:

- 4 nights accommodation
- 5 days car rental with GPS
- Co-pilot self drive kit
- Meals as indicated (B=light breakfast)

We love it!

Self Drive Holidays

8 Day Great Northern Adventure Broome to Darwin



Travel through The Kimberley from Broome to Darwin via Kununurra, following the Great Northern Highway. This alternative to the Gibb River Road doesn't require a 4WD, but check road conditions before you travel.

Day 1: Broome to Fitzroy Crossing (390km)

Collect your car from Broome and drive to Fitzroy Crossing. Ranger and Indigenous guided cruises through nearby Geikie Gorge National Park operate from April to October (own expense). Overnight at Fitzroy River Lodge.

Day 2: Fitzroy Crossing to Halls Creek (288km)

Drive to Halls Creek, the site of Western Australia's first gold rush and the access point for a number of natural attractions including China Wall and Caroline's Pool. Overnight at Kimberley Hotel, Halls Creek.

Day 3: Halls Creek to Kununurra (359km)

Travel via Turkey Creek to Kununurra, a vibrant town and hub of the East Kimberley. Scenic flights over the Bungle Bungle Range are available from Turkey Creek (own expense). Overnight at Kununurra Lakeside Resort. (B)

Day 4: Kununurra

Consider a tour to the Argyle Diamond Mine with a scenic flight over Lake Argyle and the Bungle Bungles, or cruise on the Ord River from Kununurra to Lake Argyle (own expense). Head to Kelly's Knob Lookout to watch a spectacular Kimberley sunset. Overnight at Kununurra Lakeside Resort. (B)

Day 5: Kununurra to Katherine (520km)

Depart Kununurra and enjoy a stop at Lake Argyle before heading across the Northern Territory border, journey via Timber Creek and Victoria River to Katherine. Overnight at ibis Styles Katherine.

From price based on 4 night package valid 1 Jan – 31 Mar 18. Car hire is based on Group C and D. Conditions apply.

From \$1095*
per person twin share

Day 6: Katherine

Enjoy a cruise through beautiful Katherine (Nitmiluk) Gorge this morning (own expense). Travel to the town of Mataranka and visit Mataranka Homestead and the crystal clear waters of Mataranka Thermal Pool. Overnight at ibis Styles Katherine.

Day 7: Katherine to Litchfield National Park (227km)

Travel north to Batchelor and into Litchfield National Park, one of the Top End's most accessible natural attractions. Overnight at Litchfield Motel. (B)

Day 8: Litchfield National Park to Darwin (113km)

Enjoy more time exploring Litchfield National Park before continuing to Darwin via Territory Wildlife Park (own expense). Darwin is the perfect place to end your adventure. Don't miss the pink, purple and orange hues of a Darwin Harbour sunset!

The car is booked until tomorrow and should be dropped off at the city or airport by the same time as it was picked up on Day 1 to avoid any additional charges.

Includes:

- 7 nights accommodation
- 8 days car rental with GPS
- Co-pilot self drive kit
- Meals as indicated (B = light breakfast)

We love it!

9 Day Gibb River Road 4WD Experience Broome to Broome



Experience the outback adventure of a lifetime on a 4WD journey along the famous Gibb River Road. Visit pioneering towns, explore fascinating national parks and witness spectacular scenery as you travel along the unsealed, former stock route.

Day 1: Broome to Bell Gorge Wilderness Lodge (437km)

Pick up your 4WD vehicle from Broome and drive to Derby. Continue via Windjana Gorge to Bell Gorge Wilderness Lodge, a fantastic base for exploring the Gibb River Road's magnificent gorges. Overnight at Bell Gorge Wilderness Lodge. (D)

Day 2: Bell Gorge Wilderness Lodge

Spend the day exploring some of The Kimberley's most scenic gorges. Enjoy hiking and swimming beneath the waterfall in Bell Gorge, see rock art in Galvans Gorge or swim at Barnett River Gorge. Overnight at Bell Gorge Wilderness Lodge. (BD)

Day 3: Bell Gorge Wilderness Lodge to El Questro (480km)

Explore Galvans, Manning and Barnett Gorges and continue to the one million acre El Questro station. Overnight at Emma Gorge Resort, El Questro. (B)

Day 4: El Questro

Relax and explore El Questro. Discover Zebedee Thermal Springs, Champagne Falls and Chamberlain Gorge. Overnight at Emma Gorge Resort, El Questro.

Day 5: El Questro to Kununurra (85km)

Travel to Kununurra to stock up on supplies. Enjoy a scenic cruise to Lake Argyle (own expense), browse the Argyle diamond showrooms and watch the sun set from Kelly's Knob Lookout. Overnight at ibis Styles Kununurra.

Day 6: Kununurra to Bungle Bungles (326km)

Continue to the safari camp within Purnululu National Park. Allow three hours for the 53 kilometre journey from the highway turn-off. Overnight at Bungle Bungle Safari Camp. (D)

From price based on 4 night package^ valid 1 May – 16 Sep 17. Car hire is based on Group W. Conditions apply.

From \$2275*
per person twin share

Day 7: Bungle Bungles to Halls Creek (163km)

Early start to visit Echidna Chasm then depart Purnululu and travel to Halls Creek via the Great Northern Highway. Visit China Wall and Palm Springs. Overnight at Kimberley Hotel, Halls Creek. (B)

Day 8: Halls Creek to Fitzroy Crossing (290km)

Continue along the highway to Fitzroy Crossing, gateway to Geikie Gorge. Overnight at Fitzroy River Lodge.

Day 9: Fitzroy Crossing to Broome (390km)

Take a boat cruise through Geikie Gorge (own expense) before the journey back to Broome. The 4WD is booked until tomorrow and should be dropped off by the same time as it was picked up on Day 1 to avoid any additional charges.

Includes:

- 8 nights accommodation
- 9 days 4WD rental with GPS
- Co-pilot self drive kit
- Meals as indicated (B = breakfast, D = dinner)

Note: ^\$20 per person Wilderness park permit payable direct. \$12 per vehicle Purnululu National Park entrance fee payable direct.

We love it!



AVIS®

Avis

Why not add Avis to your travel plans and make the most of your holiday by enjoying the flexibility and convenience that an Avis car rental provides.

Situated at all major airport and city locations and offering a wide range of late model vehicles to choose from, all at great rates, renting with Avis is sure to make your holiday escape more enjoyable. All Avis vehicles are air-conditioned and come with 24 hour roadside assistance. Plus you get unlimited kilometres in Metropolitan and Country areas as well as free maps to help you find your destination.

Includes:

- Loss Damage Waiver • Administration Fee • Vehicle Registration Fee • GST
- Concession Recovery Fee/Premium Location Surcharge
- Excess Reduction (Zero Excess option)

Car rentals commencing in Broome and Kununurra include unlimited kilometres. Rentals commencing in Remote locations include 100 kilometres per day with excess kilometres charged at \$27.50 per kilometre.

Does Not Include:

- Excess Reduction • One way rental fees • Fuel

Excess:

An Excess of \$3,080 applies to drivers of all vehicles, with the exception of Group W, which has an Excess of \$5,500. Optional Excess Reduction can be purchased direct for an additional fee of \$22 per day, or \$33 per day for Group W. This fee reduces the Excess to \$418, or \$1,100 for Group W. Or select the Zero Excess option to reduce the Excess to zero.

Conditions:

All prices are based on a 24 hour rental period (e.g. pick-up 9am the first day; drop off 9am the next day). Any time over the 24 hour period will incur an additional charge.

The minimum age for drivers of vehicle groups A, B, C and D is 21 years. Drivers aged 21 to 24 years inclusive are required to pay a \$27.50 per day surcharge, which is payable directly to Avis at the time of rental. For all other vehicle groups, the minimum age for drivers is 25 years. Drivers must hold an open licence and have held that licence for at least 12 months.

Vehicles in particular groups are subject to availability and may vary by location. A similar vehicle to those pictured may be substituted. Not all vehicle types are available at all locations. All vehicles include: air-conditioning, ABS, dual airbags and CD/MP3.

All rentals are subject to a deposit at the time of vehicle collection to cover miscellaneous/optional charges e.g. child seats, petrol. A credit or debit card is required. Avis accepts all major credit cards. Debit cards will be accepted if they meet the following requirements: Be issued by a recognised bank, Display the Visa or Master Card logo and hologram, Display the Cardholder Name and Display the Card Number. Prepaid and Reloadable Debit Cards as well as Travel Cards and EFTPOS cards will not be accepted. Cash deposits will be considered upon request.

Restricted Access:

Group W may be driven on the Gibb River Road (Kimberley) during the period 15 May - 31 Oct 17, conditions apply. Driving on access roads to Aboriginal communities is not permitted without an approved permit.

Note: From price based on per car per day valid 1 Nov 17 – 31 Mar 18. Airport Inclusive prices are valid for collection of vehicles from airports. Not all vehicle types are available at all locations. Check with your travel agent at time of booking.



Group A – Holden Barina (or similar)

- Auto/manual • 5 door hatch
- 4 cylinder • Tilt wheel • USB



Group B – Hyundai i20 (or similar)

- Auto • 5 door hatch
- 4 cylinder • Aux/USB



Group C – Toyota Corolla (or similar)

- Auto • 5 door hatch • 4 cylinder
- Tilt wheel • USB



Group D – Nissan Pulsar (or similar)

- Auto • 4 door sedan • 4 cylinder
- Cruise control • Aux/USB



Group E – Toyota Camry (or similar)

- Auto • 4 door sedan • 4/6 cylinder
- USB • Tilt wheel • Cruise control



Group F – Holden SV6 Wagon (or similar)

- Auto • 5 door wagon • 6 cylinder
- Power steering • Aux/USB
- Tilt wheel • Cruise control
- Traction control



Group P – Holden SV6 Sports Sedan (or similar)

- Auto • 4 door sedan • 6 cylinder
- Power steering • Aux/USB • Tilt wheel
- Cruise control • Traction control



Group K – Nissan X-Trail (or similar)

- Auto • 5 door • 4/6 cylinder • Bluetooth
- Power steering • USB • Tilt wheel



Group V – Hyundai iMax (or similar)

- Auto • 5 door van • 4/6 cylinder
- Aux/USB • Tilt wheel
- Dual sliding doors



Group W – Mitsubishi Pajero (or similar)

- Auto • 5 door 4WD • 4/6 cylinder
- Power steering • Aux/USB • Tilt wheel

We love it!

Overnight Bag Medium Suitcase Large Suitcase

PRICE PER CAR PER DAY FROM		STANDARD						AIRPORT INCLUSIVE					
GROUP	CAR TYPE	BASIC EXCESS			ZERO EXCESS			BASIC EXCESS			ZERO EXCESS		
		1-3 DAYS	4-6 DAYS	7+ DAYS	1-3 DAYS	4-6 DAYS	7+ DAYS	1-3 DAYS	4-6 DAYS	7+ DAYS	1-3 DAYS	4-6 DAYS	7+ DAYS
A	Holden Barina	\$77	\$73	\$70	\$99	\$94	\$91	\$97	\$91	\$87	\$118	\$113	\$108
B	Hyundai i20	\$84	\$79	\$76	\$105	\$101	\$98	\$105	\$99	\$95	\$126	\$121	\$117
C	Toyota Corolla	\$88	\$84	\$80	\$110	\$106	\$102	\$111	\$105	\$100	\$132	\$127	\$122
D	Nissan Pulsar	\$92	\$84	\$83	\$113	\$106	\$104	\$114	\$105	\$103	\$136	\$127	\$125
E	Toyota Camry	\$96	\$89	\$86	\$117	\$110	\$107	\$120	\$111	\$107	\$141	\$132	\$129
K	Nissan X-Trail	\$100	\$97	\$92	\$121	\$118	\$113	\$135	\$124	\$120	\$156	\$145	\$141
F	Holden SV6 Wagon	\$108	\$99	\$96	\$129	\$120	\$117	\$135	\$124	\$120	\$156	\$145	\$141
P	Holden SV6 Sports Sedan	\$108	\$99	\$96	\$129	\$120	\$117	\$125	\$121	\$115	\$146	\$142	\$136
V	Hyundai iMax	\$122	\$112	\$109	\$144	\$133	\$131	\$153	\$140	\$136	\$174	\$161	\$158
W	Mitsubishi Pajero	\$134	\$121	\$116	\$184	\$171	\$166	\$167	\$151	\$145	\$217	\$201	\$195

Exploring The Kimberley & Broome



Budget

Budget Rent a Car is renowned for meticulously maintained vehicles and quality service. Offering a wide range of cars, 4WDs and minivans Budget has the right vehicle choice for your holiday needs.

Budget's car hire fleet is constantly being updated to ensure you enjoy the best in comfort and safety in late model vehicles and at competitive prices. Driving is one of the best ways to see the sights of Australia, and Budget offers customers the convenience of having locations at airports and cities Australia wide so you are never far from a pick up point or friendly service.

Includes:

- Loss Damage Waiver • Administration Fee • Vehicle Registration Fee • GST
- Concession Recovery Fee/Premium Location Surcharge
- Excess Reduction (Zero Excess option)

Car rentals commencing in Remote locations include 100 kilometres per day with excess kilometres charged at \$27.50 per kilometre.

Does Not Include:

- Excess Reduction • One Way rental fees • Fuel

Excess:

An Excess of \$4,400 applies to drivers of all vehicles, with the exception of Group W, which has an Excess of \$5,500. Optional Excess Reduction can be purchased direct for an additional fee of \$27.50 per day, or \$33 per day for Group W. This fee reduces the Excess to \$605, or \$1,100 for Group W. Or select the Zero Excess option to reduce the excess to zero.

Conditions:

All prices are based on a 24 hour rental period (e.g. pick-up 9am the first day; drop off 9am the next day). Any time over the 24 hour period will incur an additional charge.

The minimum age for drivers of vehicle groups A, B, C and D is 21 years. Drivers aged 21 to 24 years inclusive are required to pay a \$16.50 per day surcharge, which is payable to Budget at time of rental. For all other vehicle groups, the minimum age for drivers is 25 years. Drivers must hold an open licence and have held that licence for at least 12 months.

Vehicles in particular groups are subject to availability and may vary by location. A similar vehicle to those pictured may be substituted. Not all vehicle types are available at all locations. All vehicles include: air-conditioning, ABS, dual airbags and CD/MP3.

All rentals are subject to a deposit at the time of vehicle collection to cover miscellaneous/optional charges e.g. child seats, petrol. A credit or debit card is required. Budget accepts all major credit cards. Debit cards will be accepted if they meet the following requirements: Be issued by a recognised bank, Display the Visa or Master Card logo and hologram, Display the Cardholder Name and Display the Card Number. Prepaid and Reloadable Debit Cards as well as Travel Cards and EFTPOS cards will not be accepted. Cash deposits will be considered upon request.

Restricted Access:

Vehicles may not be driven on the Gibb River Road, Cape Levegue Road, Windjana Gorge or in the Bungle Bungle National Park. Driving on access roads to Aboriginal communities is not permitted without an approved permit.

Note: From prices based on per car per day valid 1 Nov 17 – 31 Mar 18. Airport Inclusive prices are valid for collection of vehicles from airports. Not all vehicle types are available at all locations. Check with your travel agent at time of booking.



Group A – Holden Spark (or similar)

- Auto/manual • 5 door hatch
- 4 cylinder • Tilt wheel



Group B – Hyundai Accent (or similar)

- Auto • 5 door hatch
- 4 cylinder • Tilt wheel



Group C – Hyundai i30 (or similar)

- Auto • 5 door hatch • 4 cylinder
- Bluetooth



Group D – Hyundai Elantra (or similar)

- Auto • 4 door sedan • 4 cylinder
- Cruise control • Aux/USB • Bluetooth



Group E – Toyota Camry (or similar)

- Auto • 4 door sedan • 4/6 cylinder
- Bluetooth • Central locking
- Tilt wheel • Cruise control



Group F – Holden SV6 Wagon (or similar)

- Auto • 5 door wagon
- 4/6 cylinder • Aux/USB • Tilt wheel
- Cruise control • Central locking



Group P – Holden SV6 Sports Sedan (or similar)

- Auto • 4 door sedan • 4/6 cylinder
- Bluetooth • Traction control



Group K – Toyota RAV4 (or similar)

- Auto • 5 door • AWD • 4 cylinder
- Bluetooth • Central locking
- Power steering • Tilt wheel



Group V – Hyundai iMax (or similar)

- Auto • 5 door van • 4/6 cylinder
- Power steering • Dual sliding doors



Group W – Holden Colorado (or similar)

- Auto • 5 door • 4WD
- 4/6 cylinder • Bluetooth • Central locking



Overnight Bag Medium Suitcase Large Suitcase

PRICE PER CAR PER DAY FROM		STANDARD						AIRPORT INCLUSIVE					
		BASIC EXCESS			ZERO EXCESS			BASIC EXCESS			ZERO EXCESS		
GROUP	CAR TYPE	1-3 DAYS	4-6 DAYS	7+ DAYS	1-3 DAYS	4-6 DAYS	7+ DAYS	1-3 DAYS	4-6 DAYS	7+ DAYS	1-3 DAYS	4-6 DAYS	7+ DAYS
A	Holden Spark	\$73	\$69	\$66	\$95	\$91	\$88	\$91	\$86	\$83	\$113	\$106	\$104
B	Hyundai Accent	\$79	\$75	\$72	\$100	\$96	\$94	\$99	\$94	\$90	\$120	\$115	\$112
C	Hyundai i30	\$83	\$79	\$76	\$105	\$101	\$97	\$104	\$99	\$95	\$125	\$121	\$116
D	Hyundai Elantra	\$86	\$79	\$78	\$107	\$101	\$99	\$107	\$99	\$97	\$129	\$121	\$119
E	Toyota Camry	\$90	\$83	\$81	\$111	\$105	\$102	\$112	\$104	\$101	\$134	\$125	\$122
K	Toyota RAV4	\$92	\$90	\$85	\$114	\$111	\$107	\$115	\$112	\$107	\$137	\$134	\$128
F	Holden SV6 Wagon	\$100	\$92	\$90	\$122	\$114	\$111	\$125	\$116	\$112	\$147	\$137	\$134
P	Holden SV6 Sports Sedan	\$100	\$92	\$90	\$122	\$114	\$111	\$125	\$116	\$112	\$147	\$137	\$134
V	Hyundai iMax	\$114	\$104	\$102	\$135	\$126	\$123	\$142	\$130	\$127	\$163	\$152	\$149
W	Holden Colorado	\$122	\$110	\$107	\$172	\$160	\$157	\$153	\$138	\$133	\$203	\$188	\$183



2 Day Bungle Bungle Explorer

HIGHLIGHTS:

- Purnululu National Park
- Echidna Chasm
- Cathedral Gorge
- Mini Palms Gorge
- Argyle Diamond Mine

Day 1: Kununurra to Purnululu National Park

From Kununurra, enjoy a scenic flight over the mighty Ord River and Lake Argyle, the rugged Osmond Ranges and an incredible bird's eye view over the Bungle Bungle Range before landing at Bellburn Airstrip.

Journey to the southern end of Purnululu National Park to explore Piccaninny Creek with its wondrous views of the Bungle Bungle Range from the lookout or walk to the famous Beehive Domes. Enjoy a picnic lunch while basking in the incredible atmosphere of Cathedral Gorge. Return to camp and relax in your cabin or enjoy a sunset drink on the deck before dinner. Overnight at Bungle Bungle Savannah Lodge. (LD)

Day 2: Purnululu National Park to Kununurra

After a fully cooked breakfast at the Bungle Bungle Savannah Lodge, head off to explore the northern end of the National Park including Echidna Chasm and Mini Palms Gorge.

Walk the Mini Palms trail to a viewing platform to see a palm filled valley surrounded by 150 metre high cliffs – make sure to look out for the dwarfed Livistona palms.

After lunch, embark on a second walk to Echidna Chasm. Enjoy a two kilometre walk along a rocky creek bed into the base of a spectacular 200 metre high chasm with varying colour hues.

Returning to the Savannah Lodge for afternoon tea, board your aircraft for the return flight to Kununurra which includes views of the Argyle Diamond Mine and the Ragged and Carr Boyd Ranges. (BL)

Includes:

- 1 night cabin accommodation with en suite
- Return scenic flights from Kununurra
- 4WD touring
- Meals as indicated (B = breakfast, L = lunch, D = dinner)
- National park fees
- Return transfers from Kununurra accommodation

Operator: East Kimberley Tours

Departs: Daily from Kununurra at 8:15am (Apr – Nov)

Returns: 5pm

Note: Sole use prices also available.

PRICE:	
Adult twin share	\$1855
Child 3-12 years	\$1650



2 Day Cape Leveque Experience

HIGHLIGHTS:

- Cape Leveque
- Cygnet Bay Pearl Farm
- Beagle Bay Pearl Shell Church Altar
- One Arm Point Aquaculture Hatchery
- Island of the Giant Tide

Day 1: Broome to Buccaneer Archipelago

Explore the Dampier Peninsula and its extraordinary blend of pristine beaches and dramatic coastlines, rich in traditional Indigenous culture. Stop for morning tea at the Beagle Bay Aboriginal Community, home of the Beagle Bay Church with its pearl shell altar. Then arrive at the remote Cygnet Bay Pearl Farm, the oldest pearl farm in Australia. After a picnic lunch, enjoy an insight into this remote pearling industry on the farm tour. Embark on a unique cruise through the Islands of the Giant Tides. Experience the remarkable tidal flows of King Sound. In the evening arrive at the remote private safari camp, nestled on the beach overlooking the bay. Swim at the beach, explore the mangroves or catch a fish for dinner before a warm Kimberley sunset. (LD)

Day 2: Buccaneer Archipelago to Broome

This morning travel to the One Arm Point Community perched on the tip of the Dampier Peninsula. Tour the community's aquaculture hatchery, complete with Barramundi, pearl and trochus shell. Enjoy fresh damper cooked over the fire, while learning about the traditions, lifestyle and culture of the area from a local guide. Arrive at beautiful Kooljaman at Cape Leveque. Choose to head off on a snorkelling adventure, walk one of the many trails in the surrounding area or enjoy the pristine beaches and rugged red coastline. Witness the wildlife as you head back to Broome. (BL)

Includes:

- 1 night camping accommodation
- Giant Tides cruise
- One Arm Point Aquaculture Hatchery tour
- Cygnet Bay Pearl Farm tour
- Meals as indicated (B = breakfast, L = lunch, D = dinner)
- Admission fees
- National park fees
- Return transfers from Broome accommodation

Operator: Kimberley Wild Expeditions

Departs: From Broome at 6:30am
Sat (29 Apr – 30 Sep 17)
Thu (11, 25 May – 14 Sep 17)
Tue (6 Jun, 4, 18 Jul 17)

Returns: 6pm

Note: Camping Plus includes a combination of camping and Safari Tent accommodation. Sole use prices also available.

PRICE:	CAMPING	CAMPING PLUS
Adult twin share	\$795	\$845
Child 4-12 years	\$695	\$745



7 Day Broome to Darwin

HIGHLIGHTS:

- Geikie Gorge
- Purnululu National Park
- Gibb River Road
- Nitmiluk Gorge
- Litchfield National Park

Day 1: Broome to Fitzroy Crossing

Depart Broome this morning and travel towards Derby before turning onto the Gibb River Road. Visit the Napier Range, Tunnel Creek and Windjana Gorge. Stay the night at Fitzroy Crossing. (LD)

Day 2: Fitzroy Crossing to Mabel Downs Station

Geikie Gorge before heading to Halls Creek. Travel to Mabel Downs Station stay the next two nights at Bungle Bungle Station Stay. (BLD)

Day 3: Purnululu National Park

Spend the day in Purnululu National Park home of the Bungle Bungles, Cathedral Gorge, Piccaninny Creek and Echidna Chasm. Enjoy a Drovers Dinner under a canopy of a million stars. (BLD)

Day 4: Mable Downs Station to Kununurra

See the beautiful scenery, as you drive through the Carr Boyd Ranges. This afternoon cruise on Lake Argyle. Take a dip in these refreshing waters followed by a relaxing barbecue on board. Stay the next two nights at Ivanhoe Village. (BLD)

Day 5: Gibb River Road

Today explore the Gibb River Road. Visit Zebedee Springs and Emma Gorge on El Questro Station. Cross the iconic Pentecost Crossing and enjoy lunch at Home Valley Station. After, climb to the top of the Bastion Range and see the 5 major rivers of the East Kimberley entering the Cambridge Gulf. (BLD)

Day 6: Kununurra to Katherine

Passing through cattle stations onto the Northern Territory plateau and cross Victoria River, Nitmiluk Gorge. Stay overnight at Knotts Crossing. (BLD)

Day 7: Katherine to Darwin

Heading north towards the stunning Litchfield National Park enjoy a swim and spend time exploring this spectacular region. This afternoon head to Darwin where your tour will conclude. (BL)

Includes:

- 1 night motel room accommodation
- 2 nights cabin accommodation with en suites
- 3 nights safari tent accommodation with en suite
- Geikie Gorge Cruise • National park fees
- Bungle Bungle Full Day 4WD Tour
- Lake Argyle Cruise • Nitmiluk Sunset Cruise
- Meals as indicated (B = breakfast, L = lunch, D = dinner)
- Expert guide • Transfers to Broome Airport

Operator: Kimberley Outback Tours

Departs: From Broome at 6:30am,
• May 29 • Jun 26 • Jul 3[^], 24[^] • Aug 7

Concludes: Darwin at 5pm

Note: [^] Indicates reverse itinerary.

PRICE:	
Adult twin share	\$3795

Exploring The Kimberley & Broome

3 Day Essential Kimberley by Private Aircraft



HIGHLIGHTS:

- Litchfield National Park
- Adelaide River War Cemetery
- Katherine Gorge
- Lake Argyle
- Argyle Diamond Mine
- Bungle Bungle Ranges
- Horizontal Falls
- Buccaneer Archipelago
- Cape Leveque

Day 1: Darwin to Kununurra

Your adventure begins at Darwin Airport, where your Australian Air Holidays tour guide will welcome you to the three day flightseeing adventure. A high wing private Fokker 50 aircraft will fly you from Darwin over Litchfield National Park, Florence Falls, Wangi Falls and Adelaide River War Cemetery to Katherine. Before landing, enjoy the spectacular scenic flight over the thirteen gorges which make

up Katherine Gorge. On the ground join a Nitmiluk Gorge Cruise on the Katherine River. Cruise on two of the thirteen magnificent gorges which wind through 12 kilometres with sheer rock faces up to 70 metres high. Enjoy lunch at the Gorge then visit the indigenous Top Didj Gallery en route to the airport for the onward flight to Kununurra. Stay the next two nights at Kimberley Grande Resort. Sit back and relax with a three course dinner. (LD)

Day 2: Kununurra

Today you will take a fascinating tour of the Ord River. The damming of the Ord River created Lake Argyle, which holds 35 times more water than Sydney Harbour. See the incredible irrigation and the acclaimed sandalwood factory. Travel on to historic Durack Homestead rebuilt on its present site when Lake Argyle was created. Drive across the Dam wall and then enjoy a picnic lunch. Next join a stunning 55 kilometre scenic cruise on the Ord River back to Kununurra. (BLD)

Day 3: Kununurra to Broome

Keep your cameras at the ready today for the incredible and stunning scenery! Fly from Kununurra over the massive open cut Argyle Diamond Mine and the 800 square kilometre Lake Argyle. Continue your scenic flight over the famous Bungle Bungle Range with several 'low and slow' circuits of its multi-striped dome formations. Land at Fitzroy Crossing and cruise Geikie Gorge, carved by the Fitzroy River through part of an ancient limestone barrier reef which snakes across the West Kimberley. Fly from Fitzroy Crossing and descend to see the Horizontal Falls, the 'thousand islands' of the Buccaneer Archipelago and Cape Leveque. Then follow the famous Kimberley Coast to Cable Beach before landing in Broome. Your tour concludes at Broome Airport. (BL)

Includes:

- 2 nights accommodation
- Nitmiluk Gorge Cruise
- Kununurra Agricultural Tour
- Lake Argyle and Ord River Cruise
- Geikie Gorge Cruise
- One way flights from Darwin to Kununurra, Kununurra to Broome on a private aircraft
- Meals as indicated (B = breakfast, L = lunch, D = dinner)
- National park fees

Operator: Australian Air Holidays

Departs: From Darwin Airport at 8:30am,
• Jun 1, 26 • Jul 2
From Broome Airport at 7am,
• May 28^ • Jun 4^ • Jul 5^

Returns: Broome Airport 4pm
Darwin Airport 7pm

Note: Price based on 2 adults travelling. Passengers must be a minimum of 12 years of age. ^Itinerary operates in reverse.

PRICE:

Adult twin share

\$3385



Exploring The Kimberley & Broome



7 Day Taste of The Kimberley

HIGHLIGHTS:

- Gibb River Road • Windjana Gorge
- Tunnel Creek • Mimbi Caves
- Purnululu National Park
- Fitzroy Crossing
- Geikie Gorge Cruise
- Tableland Track (the untouched Kimberley)

Day 1: Broome to Fitzroy Crossing

Depart Broome and travel to Derby, the site of the largest tidal variance in Australia. Learn of Derby's role in World War II and take a brief stop at the 1500 year old Boab Prison Tree. Enjoy a relaxing cruise along Geikie Gorge. Overnight at Fitzroy Crossing. (LD)

Day 2: Fitzroy Crossing to Mabel Downs Station

This morning explore the little known Mimbi Caves. This spectacular Cave system was formed in the ancient Devonian Reef system and features crystal clear pools and ancient rock art. After lunch, journey to Mabel Downs Station located right at the turn off to Purnululu National Park. Relax in the tranquil surrounds and enjoy a bush sunset. Stay the next two nights at Mabel Downs Station, Bungle Bungle Station Stay. (BLD)

Day 3: Purnululu National Park

Spend a full day exploring Purnululu National Park, home of the Bungle Bungle Domes. Walk between the beehive domes into Cathedral Gorge, a large natural amphitheatre. Hike along Piccaninny Creek for an up close view of the domes. Travel to Echidna Chasm and walk along the palm-fringed trail between towering cliffs. (BLD)

Day 4: Purnululu National Park to Trilimti

Today, travel off the beaten track for a truly unique experience. Travel the remote and beautiful Tableland Track that passes through the Durack Range. Spend the night in this beautiful region at a remote camp, Trilimti. (BLD)



Day 5: Trilimti to Bell Gorge

Continue the adventure and explore little known gorges and escarpments with the possibility of swimming in a waterhole that no other tourists visit. Rejoin the Gibb River Road. Stay the night at Imintji Bell Gorge Camp. (BLD)

Day 6: Bell Gorge to King Leopold Ranges

Start the day by exploring the iconic gorges of the Gibb River Road. Visit Bell Gorge and take a relaxing and refreshing dip in the magical waters of The Kimberley. Stay the night at Mt Hart Homestead. (BLD)

Day 7: King Leopold Ranges to Broome

Head to the ancient limestone reef, now known as the Napier Range. See the results of water carving its way through the limestone for millions of years, creating Tunnel Creek and Windjana Gorge. Return to Broome in the afternoon. (BL)

Includes:

- 5 nights safari tent accommodation with en suite
- 1 night remote bush lodge with shared facilities
- Geikie Gorge Cruise
- Mimbi Caves tour
- Full day Bungle Bungles 4WD tour
- Meals as indicated (B = breakfast, L = lunch, D = dinner)
- National park fees
- Return transfers from Broome Airport

Operator: Kimberley Outback Tours

Departs: Wed from Broome at 6:30am
(May – Sep)

Returns: 5pm

PRICE:

Adult twin share	\$3795
Child 4-12 years	\$3795



10 Day Wild Kimberley Loop

HIGHLIGHTS:

- Windjana Gorge
- Tunnel Creek
- Bell Gorge
- Manning Falls
- El Questro
- Lake Argyle
- Bungle Bungle Range
- Geikie Gorge

Day 1: Broome to Windjana and Tunnel Creek

Travel to the Derby Boab Prison Tree. Continue to Windjana Gorge and enjoy a picnic lunch. Explore Tunnel Creek with a local Indigenous Bunuba guide. Camp at Windjana Gorge. (LD)

Day 2: Windjana Gorge to Bell Gorge

Discover the wonder of Windjana Gorge. See Freshwater crocodiles, local birdlife and Indigenous bush tucker. Travel on to Bell Gorge. (BLD)

Day 3: Bell Gorge to Mt Barnett Station

Experience the waters of Galvans Gorge and stunning Adcock Gorge. Swim in deep clear pools, relax and uncover local wildlife at Manning Falls. Overnight at Mt Barnett Cattle Station. (BLD)

Day 4: Mt Barnett Station to El Questro

Continue along the Gibb River Road to El Questro. Take a dip in the Zebedee Springs, walk into Emma Gorge or cruise Chamberlain Gorge. Spend the next two nights camping at El Questro. (BLD)

Day 5: El Questro

A full day to enjoy the activities on offer at El Questro. (BL)

Day 6: El Questro to Lake Argyle

Free time in Kununurra before travelling to Lake Argyle. Take an optional Sunset cruise (own expense). Camp at Lake Argyle. (B)



Day 7 and 8: Lake Argyle to Purnululu National Park

Lunch in Kununurra before heading down the Great Northern Highway to Purnululu National Park. Discover the Bungle Bungles, Echidna Chasm and Cathedral Gorge. Stay the next two nights at the private Bungle Bungle Safari Camp. (BLD)

Day 9: Bungle Bungles to Fitzroy Crossing

Travel to Halls Creek. Enjoy lunch at Marys Pool and visit Laarri Aboriginal Art Gallery. Camp tonight at Fitzroy Crossing. (BL)

Day 10: Fitzroy Crossing to Broome

Start the day with a cruise through the majestic Geikie Gorge. After, stop at Old Fitzroy Crossing and enjoy lunch by the river before returning to Broome. (BL)

Includes:

- 7 nights camping
- 2 nights camping with shared facilities at Bungle Bungle Safari Camp
- Geikie Gorge Cruise
- Meals as indicated (B = breakfast, L = lunch, D = dinner)
- National park fees
- Return transfers from Broome accommodation

Operator: Kimberley Wild Expeditions

Departs: From Broome at 6:55am,
Mon (1 May – 2 Oct 17),
Sat (13, 27 May – 16 Sep 17),
Thu (8 Jun, 6, 20 Jul, 3 Aug 17)

Returns: 6:30pm

Note: Camping Plus includes a combination of camping and Safari Tent accommodation. Camping Plus sole use price also available.

PRICE:	CAMPING	CAMPING PLUS
Adult twin share	\$2995	\$3395
Child 4-12 years	\$2895	\$3295

Exploring The Kimberley & Broome

11 Day Kimberley, Darwin to Broome



HIGHLIGHTS:

- Darwin
- Litchfield National Park
- Nitmiluk Gorge
- Hidden Valley National Park • Lake Argyle
- Chamberlain Gorge • Argyle Diamond Mine
- Geikie Gorge • Cable Beach

Day 1: Darwin

Your Kimberley adventure begins on arrival into Darwin. Transfer to the hotel and then board the Charles Darwin catamaran for some dining and relaxation. Enjoy the sunset as you cruise. (D)

Day 2: Darwin

Set off exploring the northernmost capital, Darwin. Visit the East Point Military Museum & the Defence of Darwin Experience. Enjoy some free time to explore before heading to the Museum of the Northern Territory. Dine tonight overlooking the water at Stokes Hill Wharf. (BD)

Day 3: Darwin to Katherine

Travel to Batchelor, the gateway to Litchfield National Park. Visit the fascinating magnetic termite mounds and Florence and Wangi Falls. Continue on to Adelaide River and view the War Cemetery, the resting place of World War II service men and women, before arriving into Katherine. Stay the next two nights at Knotts Crossing Resort. (BLD)

Day 4: Nitmiluk Gorge to Katherine

Head off to Nitmiluk Gorge and enjoy a two hour cruise through striking rock walls. Embark on a trek between the two gorges (a reasonable level of fitness and sturdy footwear is required). In the afternoon visit Katherine Museum and enjoy some cultural interaction at the Top Didj Art Gallery. (BLD)

Day 5: Katherine to Kununurra

Today travel to Victoria River and Timber Creek before crossing into Western Australia and the town of Kununurra. Stay the next two nights at the ibis Styles Kununurra. (BLD)

Day 6: Kununurra

Choose to add on a spectacular two hour sunrise flight over the Bungle Bungles before your visit to the Hidden Valley National Park (own expense). Enjoy a short walk among the 350 million year old rock formations. Cross the retaining wall of Lake Argyle to join the Triple J cruise downstream from Lake Argyle along the Ord River to Kununurra. (BLD)

Day 7: Kununurra to El Questro

Travel along the Gibb River Road to El Questro. Journey through the park to Emma Gorge Resort and spend some time exploring the Resort before joining a cruise into nearby Chamberlain Gorge. Only accessible by boat, this waterhole teems with wildlife and spectacular views. Stay in tented cabins (with private en suites) and enjoy dinner with views over the nearby range. (BLD)

Day 8: El Questro to Halls Creek

Today, travel to the Argyle Mine, the world's largest open cut diamond mine. View the mine site, tour the process plant and learn about the technology employed in diamond extraction. Following lunch in the staff village visit the History Museum. Continue to Halls Creek. Overnight at the Kimberley Hotel. (BLD)

Day 9: Fitzroy Crossing to Broome

Start early this morning for Fitzroy Crossing, and join the Fitzroy River Geikie Gorge Cruise. Following your cruise continue to the coastal township of Broome. Stay the next two nights at the Oaks Cable Beach Sanctuary. (BLD)

Day 10: Broome, Cable Beach

Visit the Broome Historical Society Museum this morning. In the afternoon, visit Chinatown and Gantheaume Point, home to Broome's Dinosaur Footprints. Alternatively choose to take a tour to Willie Creek Pearl Farm or ride a camel on Cable Beach (own expense). Prior to dinner, stroll along the famous Cable Beach and enjoy the sunset. (BD)

Day 11: Broome

Free time this morning to enjoy a morning stroll or some last minute shopping. Your tour concludes at Broome Airport. (B)

Includes:

- 10 nights accommodation
- Darwin Harbour Sunset Cruise
- Nitmiluk Gorge Cruise
- Lake Argyle and Ord River Cruise
- Chamberlain Gorge Cruise
- Geikie Gorge Cruise
- Meals as indicated (B = breakfast, L = lunch, D = dinner)
- One way transfer from Darwin Airport
- One way transfer to Broome Airport

Operator: Seniors Coach Tours at 2pm

Departs: From Darwin Airport at 2pm,
• Jun 1, 8, 22, 29 • Jul 13 • Aug 24

Concludes: Broome at 1pm

Note: Sole use prices also available.

PRICE:

Adult twin share

\$4875

Exploring The Kimberley & Broome

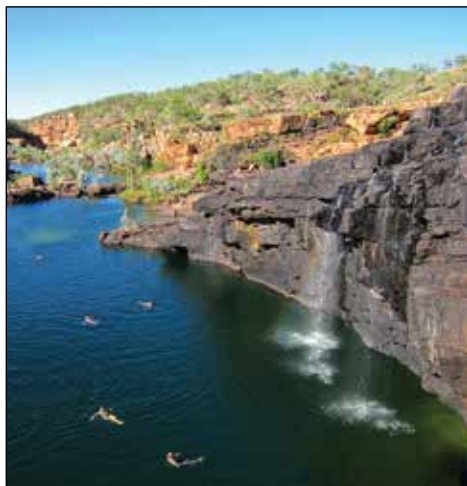

12 Day Kimberley Explorer

HIGHLIGHTS:

- Cruise the Islands of the Giant Tides
- Cape Leveque • Windjana Gorge • Bell Gorge
- Tunnel Creek • Lake Argyle • Bungle Bungle Range

Day 1: Broome to Cape Leveque

Depart Broome and journey to The Dampier Peninsula. Visit the Cygnet Bay Pearl Farm and learn about the pearling business. Join a cruise through the Islands of the Giant Tides. Camping overnight. (LD)

Day 2: Cape Leveque to Broome

This morning travel to the One Arm Point Community. View the Buccaneer Archipelago and the tidal flows of The Kimberley. Overnight in Broome. (BL)

Day 3: Broome to Windjana Gorge

Travel via Derby and the Boab Prison Tree. Explore Tunnel Creek. Camp at Windjana Gorge for the night. (LD)

Day 4: Windjana Gorge and Bell Gorge

Spend the morning searching for Freshwater crocodiles, local birdlife and Indigenous bush tucker. After, head off for Bell Gorge. Stay the next two nights at Mt Barnett Cattle Station. (BLD)

Day 5: Galvins Gorge, Adcock Gorge & Mt Barnett Station

Spend the morning Galvins and Adcock Gorge. Explore the streams and pools of Manning Falls. (BLD)

Day 6: Mt Barnett Station to El Questro

A morning trek into Manning Falls journey up the Gibb River Road to the iconic El Questro. Stay the next two nights camping at El Questro. (BLD)

Day 7: El Questro

A full day to enjoy the activities on offer at El Questro. (BL)

Day 8: El Questro to Lake Argyle

Continue the journey to Kununurra. Depart Kununurra for Lake Argyle, choose to enjoy a sunset cruise on the lake (own expense). Camp at Lake Argyle. (B)

Day 9 and 10: Lake Argyle to Bungle Bungles

Journey to Purnululu National Park, home of the Bungle Bungles. Stay the next two nights at the private Bungle Bungle Safari Camp. (BLD)

Day 11: Bungle Bungles to Fitzroy Crossing

Travel to the gold rush town of Halls Creek to see the China Wall. Enjoy lunch at Mary's Pool. Camp at Fitzroy Crossing. (BL)

Day 12: Fitzroy Crossing to Broome

Start the day with a morning cruise through the Geikie Gorge. Explore Old Fitzroy Crossing and enjoy lunch by the river before returning to Broome. (BL)

Includes:

- 11 nights camping accommodation
- Meals as indicated (B = breakfast, L = lunch, D = dinner)
- National park fees
- Return transfers from Broome accommodation

Operator: Kimberley Wild Expeditions

Departs: From Broome at 7:30am, Sat (Apr – Sep), Thu (11, 25 May – 14 Sep 17), Tue (Jun 6, Jul 4, 18)

Returns: 6:30pm

Note: Camping Plus includes a combination of camping, Safari Tent and hotel accommodation. Sole use prices for Camping Plus option also available.

PRICE:	CAMPING	CAMPING PLUS
Adult twin share	\$3595	\$4095
Child 4-12 years	\$3495	\$3995

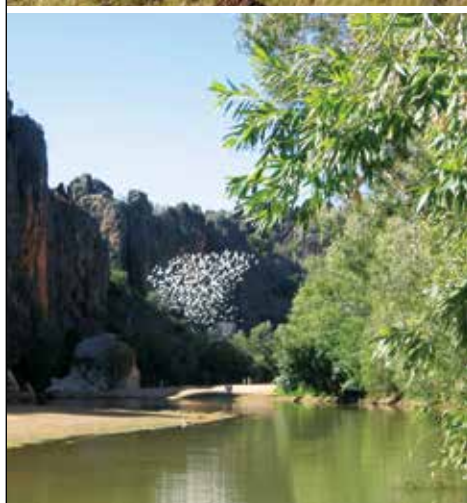

14 Day Kimberley Trail

HIGHLIGHTS:

- Windjana Gorge • Tunnel Creek • El Questro
- Bungle Bungle Range • Cathedral Gorge
- Nitmiluk Gorge • Edith Falls

Day 1: Broome to Windjana Gorge

Visit the Boab Prison Tree then continue on to Windjana Gorge and explore Tunnel Creek. Camp at Windjana Gorge. (LD)

Day 2: Bell Gorge

Explore Bell Gorge, boasting waterfalls and clear pools. Camp overnight. (BLD)

Day 3: Galvans Gorge and Mt Elizabeth

Discover Galvans Gorge and Adcock Gorge. After, explore Mt Elizabeth homestead. Camp at Mt Elizabeth Homestead. (BLD)

Day 4 and 5: Mitchell Plateau

Take on 4WD country along Kalumburu Road. Turn onto the Mitchell Plateau Track. Camp the next two nights in the national park. (BLD)

Day 6: Drysdale Station

Journey along the Gibb River Road to Drysdale Station, a family owned cattle station. Camp riverside at Miners Pool. (BL)

Day 7: Drysdale Station to El Questro

Continue the journey up the Gibb River Road to El Questro. Camp the next two nights at El Questro. (BLD)

Day 8: El Questro

Full day at El Questro. Swim in the Zebedee Springs or a trek into El Questro Gorge. (BL)

Day 9: El Questro to Purnululu National Park

Travel along the Great Northern Highway to Purnululu National Park. Stay the next two nights at Bungle Bungle Safari Camp. (BD)

Day 10: Purnululu National Park

Explore the Bungle Bungle Domes, Echidna Chasm and Cathedral Gorge. (BLD)

Day 11: Purnululu National Park to Kununurra

Travel north to Kununurra and enjoy an Ord River cruise. Camp the next two nights in Kununurra. (BLD)

Day 12: Kununurra

Take in the sights of Kununurra and discover what this outback town has to offer. (B)

Day 13: Kununurra to Katherine

Travel along the Victoria Highway, cross into the Northern Territory and on to Katherine. Camp overnight. (BLD)

Day 14: Katherine to Darwin

Cruise through Nitmiluk Gorge and after, swim at Edith Falls. Travel on to Darwin where your tour concludes. (BL)

Includes:

- 13 nights camping
- Lake Argyle and Ord River Cruise
- Meals as indicated (B = breakfast, L = lunch, D = dinner)
- National park fees
- One way transfer from Broome accommodation
- One way transfer to Darwin accommodation

Operator: Kimberley Wild Expeditions

Departs: From Broome at 6:30am • May 1, 15 • Jun 4, 19 • Jul 10, 24 • Aug 14, 28

Concludes: Darwin at 6pm

Note: Camping Plus includes a combination of camping and Safari Tent accommodation. Camping Plus sole use prices also available.

PRICE:	CAMPING	CAMPING PLUS
Adult twin share	\$3995	\$4690
Child 4-12 years	\$3895	\$4590

Exploring The Kimberley & Broome

13 Day Kimberley, Kakadu and Darwin



HIGHLIGHTS:

- Cable Beach
- Willie Creek Pearl Farm • Geikie Gorge
- Argyle Diamond Mine • Hidden Valley National Park
- Lake Argyle • Ord River
- Nitmiluk Gorge • Kakadu National Park

Day 1: Broome

Begin your adventure in Broome. Spend today exploring Chinatown and visit Gantheaume Point, home to Broome's Dinosaur Footprints. Stroll world famous Cable Beach and enjoy the sunset. Stay the next two nights at Oaks Cable Beach Sanctuary. (D)

Day 2: Broome

Start the day at Willie Creek Pearl Farm, learn of this fascinating industry, then cruise the waters of Willie Creek. After, visit the Courthouse, and spend some time browsing the shops and galleries. (BLD)

Day 3: Broome to Fitzroy Crossing

Today, set off for Derby and stop for lunch at Willare Bridge Roadhouse. On arrival in Derby enjoy a tour of the town. View the famous Boab Prison Tree and the Derby Wharf. Continue to Fitzroy Crossing. Overnight at Fitzroy River Lodge. (BLD)

Day 4: Fitzroy Crossing to Halls Creek

This morning enjoy the Fitzroy River Geikie Gorge cruise. See the gorge carved by water leaving the colourful sculptured cliffs. Lunch in Fitzroy Crossing before continuing on to Halls Creek. Overnight at the Kimberley Hotel. (BLD)

Day 5: Halls Creek to Kununurra

Depart Halls Creek after an early breakfast and travel to the Argyle Mine. View the mine site, tour the process plant and learn about the technology employed in diamond extraction. Following lunch

in the staff village visit the History Museum then head to Kununurra. Stay the next two nights at ibis Styles. (BLD)

Day 6: Kununurra

Choose to book a spectacular sunrise Bungle Bungle plane flight before visiting Hidden Valley National Park (own expense). See Durack Homestead and cross the retaining wall of Lake Argyle. Join the Triple J cruise downstream from Lake Argyle along the Ord River to Kununurra. (BLD)

Day 7: Kununurra to Katherine

Leave Kununurra this morning and continue the journey to Timber Creek. From Timber Creek travel to Victoria River before reaching Katherine. Stay the next two nights at Knotts Crossing Resort. (BD)

Day 8: Nitmiluk Gorge, Katherine

Head to Nitmiluk National Park and enjoy a two hour cruise. Visit Katherine Museum this afternoon. (BLD)

Day 9: Katherine to Kakadu

Depart Katherine and travel to Pine Creek, gateway to Arnhem Land. Enter Kakadu National Park and stop for lunch in Cooida followed by a cruise along the Yellow Water Billabong. After your cruise continue through the park. Stay the next two nights at Aurora Kakadu. (BLD)

Day 10: Kakadu National Park

Today explore the region's cultural heritage at Bowali Visitor Centre and Marrawuddi Gallery. View some of Kakadu's most famous rock art at Burrunggui (Nourlangie Rock) before returning to Jabiru for lunch (own expense). Travel north to Ubirr and the Mamukala Wetlands. (BD)

Day 11: Kakadu to Darwin

Travel along the Arnhem Highway to arrive at

Adelaide River. After lunch, board the Adelaide River Queen for your Jumping Crocs Cruise. After, pass through Humpty Doo before arriving in Darwin. Stay the next two nights the Darwin Central Hotel. Dinner tonight at Stokes Hill Wharf. (BLD)

Day 12: Darwin

Leisurely explore Darwin today. Visit Parliament House, the Museum of the Northern Territory, East Point Military Museum and the Defence of Darwin Experience. Enjoy dinner on board the Charles Darwin catamaran. (BD)

Day 13: Darwin

Free time this morning. Your tour concludes at Darwin Airport. (B)

Includes:

- 12 nights accommodation
- Geikie Gorge Cruise
- Lake Argyle and Ord River Cruise
- Nitmiluk Gorge Cruise
- Yellow Water Cruise • Jumping Crocs Cruise
- Darwin Harbour Sunset Cruise
- Meals as indicated (B = breakfast, L = lunch, D = dinner)
- One way transfer from Broome Airport
- One way transfer from Darwin Airport

Operator: Seniors Coach Tours

Departs: From Broome Airport at 12 midday,
• Jun 14 • Jul 5, 26

Concludes: Darwin Airport at 1pm

Note: Sole use prices also available.

PRICE:

Adult twin share

\$5845

13 Day Broome to Broome, Across the Gibb

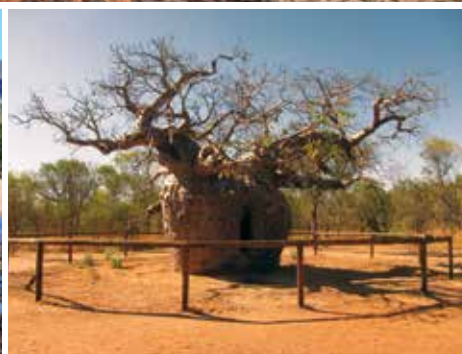

HIGHLIGHTS:

- Gibb River Road
- Fitzroy River
- Mimbi Caves
- Purnululu National Park

Day 1: Broome to Fitzroy River

Depart Broome and journey to Derby, the site of the largest tidal variance in Australia. Spend some time at the 1500 year old Boab Prison Tree. Overnight at Fitzroy River. (LD)

Day 2: Fitzroy River to Mabel Downs Station

This morning explore the little known Mimbi Caves. This spectacular Cave system was formed in the ancient Devonian Reef system. In the afternoon travel to Mabel Downs Station and stay the next two nights at Bungle Bungle Station Stay. (BLD)

Day 3: Purnululu National Park

Spend the full day in the World Heritage Listed Purnululu National Park, home of Cathedral Gorge, Piccaninny Creek and Echidna Chasm. (BLD)

Day 4: Purnululu National Park to Kununurra

Today it's on to Kununurra, the youngest town in Western Australia. After lunch, take a cruise along the length of Lake Kununurra including afternoon tea on the banks of the mighty Ord River. Stay the next two nights at Ivanhoe Village. (BLD)

Day 5: Kununurra

Enjoy the day exploring Kununurra. Wander the town visiting the various galleries and diamond stores or choose to add your own adventure – fly to Mitchell Falls, try some Barra Fishing or take a cruise on Lake Argyle (extra charge). (BLD)

Day 6: Kununurra to Home Valley Station

Visit one of the oldest towns in Western Australia, Wyndham. Climb to the top of the Bastion Range and view the five major rivers of the East Kimberley enter the Cambridge Gulf. Stay the next two nights at Home Valley Station. (BLD)

Day 7: Home Valley Station

Start today's adventure is along Gibb River Road. There is an opportunity to soak in the warm waters of Zebedee Springs and the icy waters of Emma Gorge. Cross the iconic Pentecost River as you return to Home Valley Station.

Day 8: Home Valley Station to King Leopold Ranges

Hike and swim your way along the Gorges of the Gibb River Road, experience these magical waters of The Kimberley. Stay the next two nights at Imintji Bell Gorge Camp. (BLD)

Day 9: Bell Gorge

Today, relax and enjoy the stunning beauty of Bell Gorge. Soak up the atmosphere of this peaceful place. (BLD)

Day 10: King Leopold Ranges to Mt Hart Homestead

Bask in the beauty of the King Leopold Ranges, often referred to as the most beautiful region of the Gibb River Road. Spend the day exploring, hiking and swimming before enjoying a spectacular Kimberley sunset. Stay the night at Mt Hart Homestead. (BLD)

Day 11: Mt Hart Homestead to Fitzroy Crossing

Visit the ancient limestone reef, now the Napier Range. See the results of water carving its way through the limestone for millions of years, resulting in Tunnel Creek and Windjana Gorge. Stay overnight at Fitzroy Crossing. (BLD)

Day 12: Fitzroy Crossing to Broome

Join a relaxing and spectacular cruise on Geikie Gorge. After, travel back to Broome and check in to your hotel on Roebuck Bay. Take a walk around Chinatown or browse the selection of local pearls. Overnight in Broome. (BLD)

Day 13: Broome

Start the day with a walk on Cable Beach. After breakfast tour Broome, a town rich in history from both its early pearling days and World War II. Today Broome is a modern town servicing the vast Kimberley region. Your tour ends at midday. (B)

Includes:

- 7 nights safari tent accommodation with en suite
- 3 nights hotel accommodation with en suite
- 2 nights cabin accommodation with en suite
- Geikie Gorge Cruise
- Mimbi Caves tour
- Full day Bungle Bungle Ranges 4WD tour
- Ord River Cruise
- Meals as indicated (B = breakfast, L = lunch, D = dinner)
- National park fees
- Return transfers from Broome Airport

Operator: Kimberley Outback Tours

Departs: Mon from Broome at 6:30am (May – Sep)

Returns: 12 noon

PRICE:

Adult twin share	\$7995
Child 4-12 years	\$7995

Broome & Surrounds



Cable Beach

It's easy to be captivated by the laidback seaside town of Broome, known as the southern gateway to The Kimberley region. Breathtaking beaches, a fascinating history as a pearling port and a laidback atmosphere are major drawcards.

No visit would be complete without spending some time on spectacular Cable Beach, 22 kilometres of pristine white sand lapped by the warm waters of the Indian Ocean. Witness a breathtaking Cable Beach sunset and take a camel ride along the beach - these are quintessential Broome experiences!

Broome's colourful pearling history has provided many of the town's attractions including the Japanese Cemetery and Chinatown, where pearl showrooms now line the streets. Catch a film at Sun Pictures, the oldest operating open air cinema in the world.

If you're lucky enough to be in town for the three days after the full moon from March to October each year, don't miss the Staircase to the Moon. This beautiful natural phenomenon is caused by the reflection of the rising full moon off the exposed mudflats.

Nearby Gantheaume Point is the place where turquoise waters meet striking red cliffs. Take a walk in 130 million year old dinosaur footprints at low tide or go on a four wheel drive adventure to remote Cape Leveque on the tip of the Dampier Peninsula. It's known for its Aboriginal heritage and dramatic coastal scenery.

Along the coastline is the Buccaneer Archipelago. For the adventurous, take a scenic flight over this stunning landscape and see the incredible range of colours the Buccaneer Archipelago has to show.

Our Favourites

Experience a sunset camel ride along the white sand of Cable Beach

Visit a local pearl farm or the pearl showrooms in Chinatown

Stroll through the famous Courthouse Markets on a Saturday morning

Watch a movie under the stars at the world's oldest open air cinema – Sun Picture Outdoor Cinema

Enjoy a beer overlooking Roebuck Bay at Matso's Brewery



FIND YOUR ACCOMMODATION

REF.	APARTMENTS	PAGE
1	The Billi Resort ★★★★★	37
2	Blue Seas Resort ★★★★★	37
3	Moonlight Bay Suites ★★★★★	36
4	Oaks Broome ◆◆◆◆◆	38
5	Oaks Cable Beach Sanctuary ◆◆◆◆◆	38
6	Seashells Broome ★★★★★	38
REF.	HOTELS	PAGE
7	Cable Beach Club Resort & Spa ◆◆◆◆◆	37
8	Kimberley Sands Resort and Spa ★★★★★	39
9	Mangrove Hotel ◆◆◆◆◆	36
10	Mercure Broome ◆◆◆◆◆	36
11	The Pearle of Cable Beach ◆◆◆◆◆	40
12	Ramada Eco Beach Resort ★★★★★	40



Buccaneer Archipelago



Broome Sightseeing Pass

Discover the beauty of The Kimberley region with a Broome Sightseeing Pass. There are 3 packages available which offer you a saving on the standard individual prices:

Broome Sightseeing Pass 1 Includes:

- Meet and Greet Airport Transfers
- Half Day Broome Town & Cable Beach tour (see page 34 for details)

Broome Sightseeing Pass 2 Includes:

- Meet and Greet Airport Transfers
- Half Day Broome Town & Cable Beach tour (see page 34 for details)
- One day tour from the following options: Full Day Cape Leveque and Aboriginal Communities[^] or Full Day Windjana Gorge and Tunnel Creek Adventure (see page 35 for details)

Broome Sightseeing Pass 3 Includes:

- Meet and Greet Airport Transfers
- Half Day Broome Town & Cable Beach tour (see page 34 for details)
- Both day tours listed below: Full Day Cape Leveque and Aboriginal Communities[^] and Full Day Windjana Gorge and Tunnel Creek Adventure (see page 35 for details)

Operator: ADAMS Pinnacle Tours

Note: [^]Fly option is not included. All tours are subject to availability. Prices valid 15 May – 1 Sep 17.

We love it!

PRICE:	ADULT	CHILD 4-12 YEARS
Broome Sightseeing Pass 1	\$100	\$60
Broome Sightseeing Pass 2	\$325	\$199
Broome Sightseeing Pass 3	\$539	\$339



Broome Sightseeing

Spend the morning exploring Broome's past and present at various locations. View the sprawling Cable Beach and experience spectacular Gantheaume Point. Wander through the Japanese Cemetery and learn about the history of the hard hat divers. Stop at scenic Town Beach before learning about Matso's Brewery. Drive by Sun Pictures, Streeter's Jetty and finish at Broome's last remaining wooden pearling luggers for a high tea experience.

Includes:

- Beer sample voucher for Matso's Broome Brewery
- Local guide • Pearling Masters High Tea
- Maximum 20 passengers
- Return transfers from Broome accommodation

Operator: Broome Sightseeing Tours

Departs: From Broome at 8:30am
Daily (Apr – Oct), On request (Nov – Mar)

Returns: 11am

PRICE:	
Adult	\$80
Child 6-16 years	\$75



Willie Creek Pearl Farm

Learn how the rare and beautiful Australian South Sea Pearl is produced at the Willie Creek Pearl Farm in Broome. Gain an insight into the modern Australian pearling process, from the seeding of an oyster shell, to the harvesting and grading of a pearl, right through to the final stunning product on display in the showroom. Cruise the azure waters of Willie Creek to view oyster panels suspended in their natural environment.

Includes:

- Pearl farm tour
- Boat cruise
- Seeding demonstration
- Jewellery showroom visit
- Morning or afternoon tea
- Return transfers from Broome accommodation

Operator: Willie Creek Pearl Farm

Departs: From Broome on request
Daily (Mar – Oct), Sun to Fri (Nov – Feb)

Duration: 4 hours



PRICE:	
Adult	\$105
Child 6-16 years	\$55

Broome & Surrounds



Half Day Broome Town & Cable Beach Tour

Discover all that Broome has to offer on this half day tour. Gain an insight into the heritage of this charming town and colourful alfresco lifestyle. Start at Broome's Chinatown with fascinating stories of this multi-cultural precinct. Stop at the famous Sun Pictures, the world's oldest operating picture gardens. Visit Cygnet Bay Pearl Farm to hear all about the history of pearling in Broome, before heading through Old Broome past old Pearling Masters' homes. Enjoy a beer tasting hosted by one of Matso's knowledgeable staff, including their famous ginger beer. Visit the Japanese Cemetery and Broome Port before arriving at Gantheaume Point, known for dinosaur footprints and Anastasias Pool.

Finish your day at Cable Beach, with light refreshments and nibbles to enjoy as you watch the spectacular and unique Western Australian sunset.

Includes:

- Pearl Shop
- Matso's Broome Brewery and tasting
- Light refreshments and nibbles
- Expert guide
- Return transfers from Broome accommodation

Operator: ADAMS Pinnacle Tours

Departs: Mon, Wed, Fri from Broome at 12:30pm (May – Aug)

Returns: 6:30pm

We love it!

PRICE:

Adult	\$89
Child 4-12 years	\$50



Broome Sights with Camel Ride

Take in the highlights of Broome, including Chinatown, Sun Pictures, Roebuck Bay and Old Broome. Pass by the old Pearling Masters' homes and stop to refresh at Matso's Broome Brewery. Also see Gantheaume Point and the Japanese Cemetery. Then embark on one of Broome's famous camel rides along Cable Beach at sunset.

Includes:

- Camel ride along Cable Beach
- Visit to Chinatown, Sun Pictures and Japanese Cemetery, Gantheaume Point
- Matso's Broome Brewery • Expert guide
- Return transfers from Broome accommodation

Operator: Kimberley Wild Expeditions

Departs: Mon to Sat from Broome at 12 noon (Apr – Oct)

Returns: 6pm



PRICE:	WITH CAMEL	
Adult	\$99	\$169
Child 4-12 years	\$59	\$129



Buccaneer Explorer Scenic Flight

Enjoy panoramic views of Cable Beach heading north across the Dampier Peninsula in a high-wing scenic aircraft. View the spectacular colours of the Buccaneer Archipelago over Talbot Bay and the tidal Horizontal Falls. Enjoy 30 minutes at Cape Leveque, the northern most point of the Dampier Peninsula. Return along the spectacular coastline to Broome.

Includes:

- Scenic flight over the Buccaneer Archipelago
- Stopover at Cape Leveque including refreshments
- Personal headsets for pilot commentary
- Return transfers from Broome accommodation

Operator: King Leopold Air

Departs: Tue, Thu from Broome at 7:30am, 11:30am (May – Nov), On request (Dec – Apr)

Returns: 12 noon, 5:30pm

PRICE:	
Adult	\$595
Child 3-13 years	\$495



Mitchell Falls Explorer

Fly to an inaccessible and remote ancient land see the spectacular Prince Regent Nature Reserve and the stunning Mitchell Falls. Fly over Walcott Inlet estuary, Harding Range and King Cascade before landing at Mitchell Plateau. Enjoy a stopover and a swim at Kooljaman, Cape Leveque, then a coastal flight along Dampier Peninsula on return to Broome.

Includes:

- Scenic flight over Mitchell Falls
- Stopover at Cape Leveque including refreshments
- Personal headset for pilot commentary
- Return transfers from Broome accommodation

Operator: King Leopold Air

Departs: Tue, Thur from Broome at 7:30am

Returns: 5pm



PRICE:	
Adult	\$1060
Child 3-13 years	\$960



Full Day Cape Leveque

Journey to the tip of the Dampier Peninsula to experience the remote coastal wilderness area of Cape Leveque and local Aboriginal Communities. Heading north on the Cape Leveque Road, travel over rugged terrain on the unsealed sections of the road stopping at Beagle Bay Aboriginal Community. Visit the famous Sacred Heart Church with its exquisite Pearl Shell Altar, built in 1918 by the Pallotine Monks. Stop at Lombadina, where the traditional owners will take you on a guided walk of the community, sharing knowledge about bush foods and medicines, traditional hunting, fishing techniques and their special relationship with the land and the ocean. Next stop is Cygnet Bay Pearl Farm, Australia's oldest operating Pearl Farm, situated on the tip of the Dampier Peninsula. Enjoy a chef prepared lunch followed by a Pearl Farm Tour. Take an afternoon swim in the beautiful turquoise waters of Kooljaman. Sit back and relax or stroll along the beautiful beach where the sands are white and the scenery is amazing. Choose to take the scenic flight option down the beautiful coast, or head back to Broome on the coach.

Includes:

- Cygnet Bay Pearl Farm Tour • Cape Leveque
- Expert guide • Air-conditioned 4WD vehicle
- Return transfers from Broome accommodation

Operator: ADAMS Pinnacle Tours

Departs: Tues, Fri, Sun from Broome at 7am (May to Aug)

Returns: Flight option 5pm, 4WD option 7:30pm

Note: Flight option must be pre booked and individual weights must be advised at the time of booking.

We love it!

PRICE:	WITH FLIGHT	
Adult	\$269	\$499
Child 4-12 years	\$169	\$409

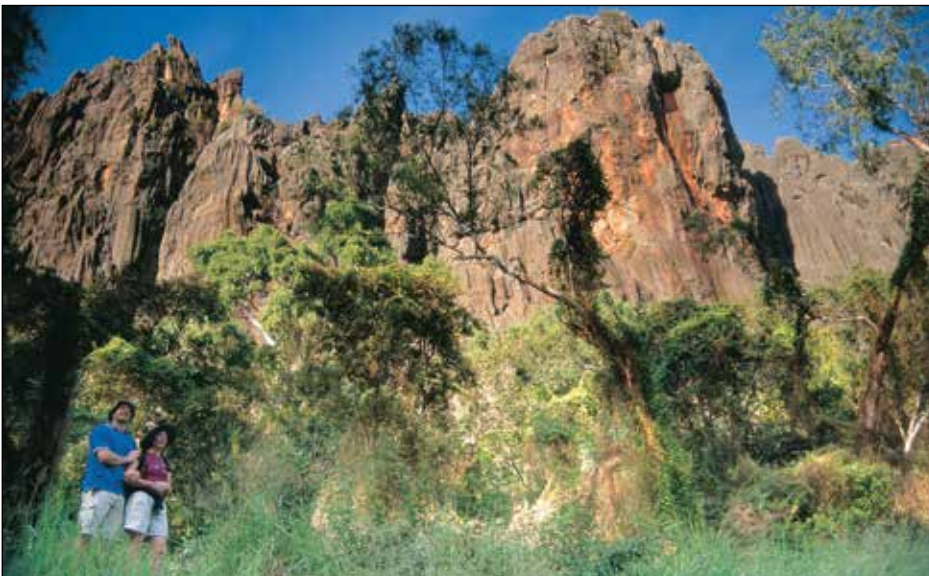

Full Day Windjana Gorge

Head north over the Willare Bridge, cross the mighty Fitzroy River and enjoy a morning tea break. From here, stop at one of The Kimberley's most famous landmarks the massive ancient Boab Prison Tree, once used to house convicts. While here view Myalls Bore. Heading east through Kimberley cattle country continue along the famous Gibb River Road arriving at Windjana Gorge for a scrumptious picnic lunch. Regarded as a classic world geological feature, the gorge is also a renowned Freshwater crocodile spotting site. Keep an eye out for wildlife hiding in the Lennard River that runs through Windjana Gorge. The limestone walls rise more than 100 metres and the gorge is home to fossils of shells and sea creatures. Afterwards, head to Tunnel Creek, a 750 metre long flooded cavern. On this great adventure walk, wade through knee to thigh high water and hear the story of Jandamarra. The tunnel features many beautiful formations including stalactites and stalagmites, and is also home to a variety of bats, olive pythons and Freshwater crocodiles. Enjoy a swim at the end of the tunnel in a waterhole before heading back for afternoon tea (own expense) and then onwards back to Broome.

Includes:

- Prison Boab Tree • Expert guide • National park fees
- Air-conditioned 4WD vehicle • Packed lunch
- Return transfers from Broome accommodation

Operator: ADAMS Pinnacle Tours

Departs: Mon from Broome at 7am (May – Aug)

Returns: 10pm

Note: A moderate level of fitness and mobility is required for this tour. There will be walking over uneven ground, climbing rocks and wading through water.

We love it!

PRICE:		
Adult	\$249	
Child 4-12 years	\$149	

Broome & Surrounds

Mangrove Hotel



From price based on 1 night in a **Garden View Room** or **Superior Poolside Room**, valid 16 Oct 17 – 31 Mar 18.

From **\$84***
per person per night

47 Carnarvon Street, Broome

MAP PAGE 32 REF. 9

Set among lush tropical gardens with stunning views of Roebuck Bay, this breathtaking hotel offers stylish boutique accommodation. Enjoy the tranquil poolside guestrooms, delicious dining venues and unparalleled service and staff. For an unforgettable experience, witness the rare Staircase to the Moon right from the hotel's grounds! (Staircase to the Moon is seasonal and dependent on weather/tide conditions)

Property Features: Pools (2), Spas (2), Cabanas, Restaurants (2), Bars (2), Gymnasium, Guest laundry, Parking (free), Courtesy airport transfers (available if pre-booked).

Room Features: Air-conditioning, Fan, Tea/coffee making facilities, Mini bar, Cable TV, In-room movies (free), Docking station, Ironing facilities, Hair dryer, Safe.

Children: 0 to 11 years – free when sharing with an adult and using existing bedding.

Max Capacity: Bayside Premier – 2, Garden View/Superior Poolside – 3.

Distances: Roebuck Bay across road, Town centre 500m, Cable Beach 6.5km.



Mercure Broome



From price based on Stay 5, Pay 4 in a **Superior Room**, valid 1 – 30 Apr, 1 Oct 17 – 31 Mar 18.

From **\$69***
per person per night

1 Weld Street, Broome

MAP PAGE 32 REF. 10

Mercure Broome is walking distance from the heart of Broome and only 10 minutes drive from spectacular Cable Beach, making it the ideal location to explore Broome and its surrounds. The hotel is set in tropical gardens surrounded by the sparkling blue waters of Roebuck Bay. Enjoy a relaxing day by the pool and at the end of the day, take in a glorious sunset. The perfect atmosphere for relaxation or adventure.

Property Features: Pool, Restaurant, Bars (2), Room service (limited), Bottle shop, Barbecue area, Tennis court, Guest laundry, Parking (free).

Room Features: Wi-Fi (extra charge), Air-conditioning, Fan, Tea/coffee making facilities, Cable TV, In-room movies, Ironing facilities, Hair dryer, All rooms non smoking.

Children: 0 to 2 years – cot/bed charge payable direct. 3 to 15 years – up to 2 children free when sharing with 2 adults and using existing bedding.

Max Capacity: Deluxe with Balcony/Superior – 2.

Distances: Roebuck Bay 200m, Town centre 1km, Cable Beach 7km.

BONUS: FREE Night Offer: Stay 5 nights, pay for 4, valid 1 – 30 Apr, 1 Oct 17 – 31 Mar 18.

Moonlight Bay Suites



From price based on Stay 4, Pay 3 in a **1 Bedroom Bay View Suite**, valid 1 – 30 Apr, 1 Nov 17 – 31 Mar 18.

From **\$67***
per person per night

51 Carnarvon Street, Broome

MAP PAGE 32 REF. 3

Moonlight Bay Suites is ideally situated on the water's edge of the spectacular Roebuck Bay and only minutes away from Broome's Chinatown. Set among landscaped tropical gardens, this resort offers spacious one and two bedroom apartments. Many of the apartments feature views of Roebuck Bay.

Spend your days relaxing and unwinding around the 28 metre outdoor pool or treat yourself to a massage at Coco Beauty Broome.

Property Features: Pool, Barbecue area, Room service (limited), Coco Beauty Broome, Gymnasium, Guest laundry, Non smoking, Parking (free).

Room Features: Air-conditioning, Fan, Kitchen with microwave, Dishwasher (2 Bedroom Deluxes), Cable TV, In-room movies (free), Ironing facilities, Hair dryer.

Children: 0 to 11 years – up to 2 children free when sharing with 2 adults and using existing bedding.

Max Capacity: 1 Bedroom/1 Bedroom Bay View – 3, 2 Bedroom/2 Bedroom Deluxe – 5.

Distances: Cable Beach across road, Town centre 1km.



EXCLUSIVELY FOR YOU

FREE Night Offer: Stay 4 nights, pay for 3, valid 1 – 30 Apr, 1 Nov 17 – 31 Mar 18.



2 Bedroom Deluxe

The Billi Resort

★★★★☆



From price based on 1 night in a **Studio** or **Luxury Queen Eco Tent**, valid 1 Nov – 17 Dec 17, 5 Jan – 31 Mar 18.

From \$73*
per person per night

23 Coucal Street, Cable Beach

MAP PAGE 32 REF. 1

Offering a private and intimate tropical setting, this boutique resort features superb self-contained villas and eco tent accommodation. Each holiday house has a bright and airy finish nestled under a superb canopy of trees and connected to a stunning central pool area. Hop on a free resort bike and take a ride around town, or lounge by the pool and soak up the natural beauty of the resort. The Billi is ideal for that private escape.

Property Features: Internet facilities, Pool, Sundeck, Barbecue area, Bicycle hire (free), Guest laundry (free), Parking (free).

Room Features: Air-conditioning (except Luxury Queen Eco Tents), Fan, Balcony, Limited cooking facilities (Eco Tents), Kitchen with microwave and dishwasher (Studios and Villas), CD/DVD player, Docking station (Apple), All rooms non smoking.

Children: 0 to 11 years – free when sharing with 2 adults and using existing bedding.

Max Capacity: Studio/Luxury Queen Eco Tent/1 Bedroom Villa – 2, Luxury King Eco Tent/2 Bedroom Villa – 4.

Distances: Cable Beach 1km, Town centre 7km.



Blue Seas Resort

★★★★☆



From price based on 5 nights in a **1 Bedroom**, valid 1 Nov 17 – 31 Mar 18.

From \$68*
per person per night

10 Sanctuary Road, Cable Beach

MAP PAGE 32 REF. 2

Located just a short walk to the white sands of Cable Beach is the Blue Seas Resort. You'll be staying in comfort and style in one of the spacious self-contained apartments. Each apartment features a verandah or balcony overlooking the crystal clear waters of one of two inviting swimming pools. With many choices for leisure activities in an exotic tropical setting you'll enjoy Blue Seas Resort.

Property Features: Pools (2 heated), Spa, Barbecue area, Guest lounge, Guest laundry, Parking (free), Local shuttle bus (extra charge).

Room Features: Air-conditioning, Fan, Balcony, Kitchen with microwave and dishwasher, Barbecue, In-room movies (free), CD/DVD player, Washer/dryer, Ironing facilities, Hair dryer, All rooms non smoking.

Children: 0 to 11 years – free when sharing with 2 adults and using existing bedding.

Max Capacity: 1 Bedroom – 4.

Distances: Cable Beach 500m, Town centre 6.5km.



Cable Beach Club Resort & Spa

◆◆◆◆◆

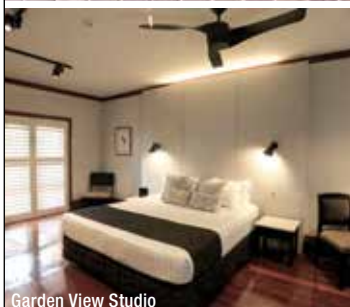

Garden View Studio



From price based on 1 night in a **Garden View Studio**, valid 1 Nov 17 – 28 Mar 18.

From \$130*
per person per night

Cable Beach Road, Cable Beach

MAP PAGE 32 REF. 7

A tropical oasis overlooking Cable Beach, just minutes from the pearly town of Broome.

The property is set on 21 acres of tranquil gardens with studio and bungalow accommodation styled with an extraordinary fusion of Asian serenity and colonial charm. Offering many places to unwind, take your pick of two glistening pools, the Blue Body Buddha Sanctuary or Chahoya Spa and Salon. If you are looking for some exciting leisure facilities, look no further than mini golf or one of two tennis courts. For the kids, there are hours of fun to be had at the traditional playground or the water playground which features water buckets and water sprays. At the end of a long day, dine at one of the four exotic dining choices. Enjoy Southeast Asian cuisine, Japanese, a relaxing bar and grill style dinner overlooking the Indian Ocean, or a fine dining experience at Club Restaurant. Or stay in and order room service!

Cable Beach Club Resort and Spa is a holiday destination like no other.

Property Features: Pools (2 – 1 adults only), Restaurants (4), Chahoya Spa by L'Occitane, Chahoya Salon, Blue Body Buddha Sanctuary, Gymnasium, Tennis courts (2), Mini golf, Games pavilion, Guest laundry, 24 hour reception, Parking (free), Resort shop.

Room Features: Villa – 2, Garden View Studio/Ocean Side Studio/Pool Terrace Studio/Pool View Studio – 3, Bungalow/Spa Superior Bungalow/Price Jones Suite – 5, Club Apartment/Pearlers Bungalow – 6, Durack/Nolan Suite – 7, Spa Deluxe Bungalow – 8.

Children: 0 to 17 years – free when sharing with an adult and using existing bedding. Cot free of charge.

Max Capacity: Villa – 2, Garden View Studio/Ocean Side Studio/Pool Terrace Studio/Pool View Studio – 3, Bungalow/Spa Superior Bungalow/Price Jones Suite – 5, Club Apartment/Pearlers Bungalow – 6, Durack/Nolan Suite – 7, Spa Deluxe Bungalow – 8.

Distances: Cable Beach 50m, Town centre 6.3km.



Broome & Surrounds

Oaks Broome



From price based on Stay 3, Pay 2 in a **Hotel Room**,
valid 9 – 31 Oct, 1 Nov – 21 Dec 17, 2 Jan – 31 Mar 18.

From \$63*
per person per night

99 Robinson Street, Broome

MAP PAGE 32 REF. 4

Enjoy cosmopolitan living at Oaks Broome in picturesque Roebuck Bay. Surrounded by landscaped gardens, enjoy contemporary, well appointed hotel rooms and apartments which feature balconies and large decks which look onto the two swimming pools. A superb restaurant and bar overlooking the central pool adds to the ambience of this tropical paradise.

Property Features: Wi-Fi (public areas – extra charge), Pools (2), Restaurant, Café, Bar, Guest laundry, Non smoking, Parking (free).

Room Features: Wi-Fi (extra charge), Air-conditioning, Balcony, Limited cooking facilities (Studios), Kitchen (1 and 2 Bedrooms), Cable TV, Washer/dryer (2 Bedrooms), Ironing facilities, Hair dryer.

Children: 0 to 2 years – cot/bed charge payable direct. 3 to 12 years – free when sharing with 2 adults and using existing bedding.

Max Capacity: Hotel – 2, 1 Bedroom – 3, 2 Bedroom – 5.

Distances: Cable Beach 250m, Town centre 2km.

BONUS: FREE Night Offer: Stay 3 nights, pay for 2, valid 1 Apr – 30 Jun, 9 – 31 Oct, 1 Nov – 21 Dec 17, 2 Jan – 31 Mar 18.

Oaks Cable Beach Sanctuary



From price based on Stay 3, Pay 2 in a **Studio**,
valid 1 Nov – 21 Dec 17, 2 Jan – 31 Mar 18.

From \$70*
per person per night

1 Lullfitz Drive, Cable Beach

MAP PAGE 32 REF. 5

Offering relaxed resort-style accommodation featuring modern studios and apartments with courtyards or balconies and spacious layouts offering privacy and comfort. Enjoy an impressive lagoon swimming pool, infinity pool, a dedicated children's wading pool, expansive deck with sun lounges and a restaurant.

Property Features: Restaurant, Pools (4 – 1 children's wading, 1 infinity edge), Parking (free).

Room Features: Air-conditioning, Balcony/courtyard, Tea/coffee making facilities, Limited cooking facilities with microwave (Studios), Kitchen with microwave and dishwasher (1, 2 and 3 Bedrooms), Cable TV, Laundry (1, 2 and 3 Bedrooms), Ironing facilities, Hair dryer, All rooms non smoking.

Children: 0 to 2 years – cot/bed charge payable direct. 3 to 12 years – free when sharing with an adult and using existing bedding.

Max Capacity: Studio – 2, 1 Bedroom – 3, 2 Bedroom – 5.

Distances: Cable Beach 600m, Town centre 4.5km.



BONUS: FREE Night Offer: Stay 3 nights, pay for 2, valid 1 Apr – 30 Jun, 9 – 31 Oct, 1 Nov – 21 Dec 17, 2 Jan – 31 Mar 18.

Seashells Broome



From price based on Stay 3, Pay 2 in a **1 Bedroom**,
valid 1 Nov – 23 Dec 17, 3 Jan – 31 Mar 18.

From \$80*
per person per night

4-6 Challenor Drive, Cable Beach

MAP PAGE 32 REF. 6

Nestled among lush and secluded gardens, this resort offers stylish, fully self-contained, spacious apartments and bungalows. A free-form island swimming pool surrounded by a comfortable sun lounge area is the perfect place to unwind after a long day sightseeing. Relax in the entertaining area where there are gas barbecues perfect for an evening meal.

Property Features: Pools (2 – 1 wading), Barbecue area, Children's playground, Resort shop, Parking (free).

Room Features: Wi-Fi (extra charge), Air-conditioning, Fan, Balcony/Verandah, Kitchen with microwave and dishwasher, Cable TV, In-room movies (free), Laundry, Ironing facilities, Hair dryer, Safe, All rooms non smoking.

Children: 0 to 12 years – free when sharing with an 2 adults and using existing bedding. Cot free of charge.

Max Capacity: 1 Bedroom – 2, 2 Bedroom – 4, 3 Bedroom Bungalow – 6.

Distances: Cable Beach 300m, Town centre 6km.



BONUS: FREE Night Offer: Stay 3 nights, pay for 2, valid 1 Apr - 31 May, 1 – 22 Sep, 9 Oct – 23 Dec 17, 3 Jan – 31 Mar 18.

FREE Wi-Fi up to 500 megabytes per room per day for up to 3 devices.

HONEYMOON BONUS: FREE bottle of sparkling wine in room on arrival.

Kimberley Sands Resort and Spa

★★★★★

From price based on 3 nights in a **Guest Room**,
valid 1 – 23 Dec 17, 11 Jan – 31 Mar 18.

From **\$83***
per person per night



Deluxe Guest

10 Murray Road, Cable Beach

MAP PAGE 32 REF. 8

Kimberley Sands Resort and Spa is located just minutes from the turquoise blue waters and white sands of Cable Beach. This five star resort captures Broome's unique beauty and culture. Whether your quest is serenity or adventure, here you'll find time and space, understated elegance and around the clock attention.

With a boutique feel this resort has a range of accommodation options, choose from spacious hotel rooms or open one and two bedroom suites. The resort wraps around an asymmetrical pool with spa nooks and sunbeds, a cascading water feature and 25 metre lap lane.

For your health and convenience the resort also features a fitness room and meditative garden zones. For ultimate relaxation, visit the resort's day spa. Surrounded by elegant water features relax in seclusion and enjoy a taste of paradise. Choose from a range of treatments based on Australian native botanicals that will leave you refreshed and rejuvenated.

The Deck, the resort restaurant, has a highly acclaimed chef and restaurant staff who spoil guests with mouth-watering meals, refreshing summer cocktails and an ideal ambience for a luxurious, relaxed atmosphere both day and night.

The Kimberley Sands Resort and Spa is the perfect place to return to for relaxation and luxury after your days exploring The Kimberley.

Property Features: Free Wi-Fi (limited), Pool, Restaurant, Café, Bar, Room service (limited), Day spa, Fitness room, Sauna, Meditative gardens, Guest laundry, Non smoking, Parking (free), Adults only lounge, Resort shop.

Room Features: Air-conditioning, Fan, Balcony or patio, Tea/coffee making facilities, Cable TV, Docking station (Apple), Ironing facilities, Bathrobes, Hair dryer, Safe, All rooms non smoking.

Children: 0 to 3 years – cot/bed charge payable direct. 3 to 12 years – \$30 per child per night.

Max Capacity: Guest/Master Pearler Suite – 2, Deluxe Guest/1 Bedroom Suite – 3, 2 Bedroom Suite – 4.

Distances: Cable Beach 500m, Town centre 6km.



Broome & Surrounds

The Pearle of Cable Beach



Pearle Guest Room

From price based on 1 night in a **Guest Room**,
valid 1 – 23 Dec 17, 11 Jan – 31 Mar 18.

From **\$142***
per person per night

14 Millington Road, Broome

MAP PAGE 32 REF 11

Set in a lush tropical setting The Pearle of Cable Beach provides superb self-contained accommodation in one of Australia's most unique and rugged destinations. Offering a blend of modern resort living and Australian outback adventure, the resort's rooms are hidden in their own exclusive tropical sanctuaries. The Pearle of Cable Beach offers an unforgettable holiday experience for the discerning traveller.

Enjoy the meandering roads and landscaped pathways all wrapped around a central 25 metre resort infinity pool. Visit the lavish Pearle Day Spa, where you will find invigorating and tranquil massage treatments. Whether you spend your day exploring the incredible surroundings of Broome, or taking a day of leisure know that you can return to your comfortable and spacious resort room for relaxation and rejuvenation.

Property Features: Pool (infinity), Café, The Pearle Day Spa, Laundry facilities, Parking (free), Resort shop.

Room Features: Air-conditioning, Fan, Patio, Kitchen, Tea/coffee making facilities, Cable TV, Docking station, Ironing facilities, Washer, Hair dryer.

Children: 0 to 11 years – free when sharing with 2 adults and using existing bedding.

Max Capacity: Guest Room/Master Pearle Suite – 2, Deluxe Guest/ 1 Bedroom Suite – 3, 2 Bedroom Suite – 4, Pearle Superior Pavilion – 7.

Distances: Cable Beach 1.6km, Town centre 5.1km.



Ramada Eco Beach Resort, Cape Villaret



Ocean Front Eco Villa

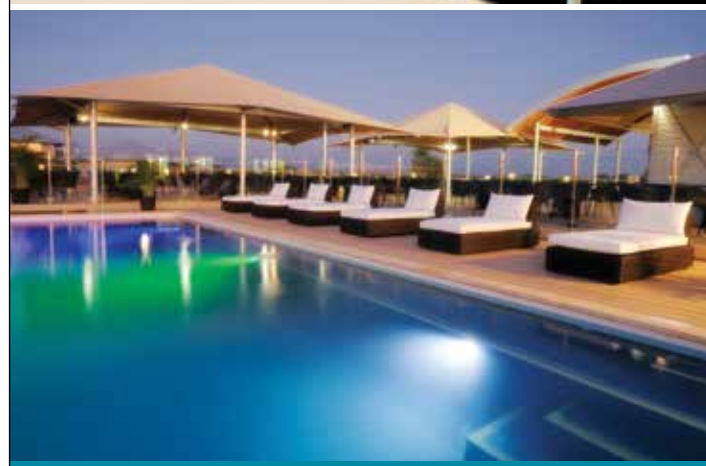

From price based on Stay 7, Pay 5 in a **Garden View Eco Tent**,
valid 1 Apr – 30 Jun 17.

From **\$70***
per person per night

Great Northern Highway, 130km south of Broome

MAP PAGE 32 REF 12

One of the world's most remarkable destinations, this unique beachfront eco resort is set in an untouched landscape south of Broome. This exceptional resort features tents and villas interlinked by elevated wooden boardwalks.

Property Features: Free Wi-Fi (public areas), Pool, Restaurant, Bar, Massage facilities, Dragon Fly Day Spa, Parking (free).

Room Features: Air-conditioning (Eco Villas/Beach Houses), Limited cooking facilities (Eco Villas), Kitchen (Beach Houses), Private en suite.

Children: 0 to 2 years – cot free of charge. 3 to 12 years – adult prices apply.

Max Capacity: Garden View Eco Tent/Ocean View Eco Tent – 3, Garden View Eco Villa/Ocean View Eco Villa/Ocean Front Eco Villa – 4, Beach House – 6.

Distances: Broome 130km.

How To Get There from Broome: By car (4WD recommended), seat in coach transfer or helicopter. Ask your travel agent for details.

Note: Resort is open with limited facilities 3 Jan – 28 Mar 18.



BONUS: FREE Night Offer: Stay 4 night, pay for 3 or stay 7 nights, pay for 5, valid 1 Apr – 31 Oct 17.

FREE meals for children 0 to 12 years when dining with a paying adult in the resort restaurant (one child per adult).

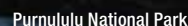

From Kununurra, an adventure down dirt tracks will reveal spectacular waterfalls, gorges and cattle stations. Your outback adventure awaits.

4 KUNUNURRA SURROUNDS

Map showing the Kununurra region, Cockburn Ranges, and surrounding towns like Wyndham and Mirima National Park. The map includes the Berkeley River, King River, and Lake Argyle. A dashed line indicates a route from Kununurra to Emma Gorge and Chamberlain Gorge. A red dot marks the location of Carr Boyd Range. A red line with a black dot indicates a route from Kununurra to Mirima National Park.



Kununurra & Surrounds



Bungle Bungle Explorer

Enjoy a scenic flight from Kununurra to the Bungle Bungle Range, flying over the Ord River and Lake Argyle. Take a 4WD tour into the domes. Enjoy views of the Argyle Diamond Mine, Carr Boyd and Ragged Ranges on the afternoon flight back.

Includes:

- Scenic plane flight • 4WD and walking tour
- World Heritage Listed Purnululu National Park
- Beehive Domes • Expert guide • Lunch
- Afternoon tea • National park fees
- Return transfers from Kununurra accommodation

Operator: East Kimberley Tours

Departs: Daily from Kununurra at 8:15am (Apr – Nov)

Returns: 5pm

Note: Price based on minimum 2 adults. Sole use prices also available.



PRICE:

Adult	\$730
-------	--------------



Lake Argyle & Ord River Full Day Tour

Travel from Kununurra through the magnificent Carr Boyd Ranges. Explore Lake Argyle, stopping on an island for lunch and a swim. Cruise back to Kununurra along the Ord River with Triple J Cruises.

Includes:

- Durack Homestead Museum tour
- Lake Argyle cruise with lunch, commentary, complimentary soft drink and a beer or wine
- Access to the Infinity pool at Lake Argyle Resort
- Ord River cruise with Triple J Tours
- Return transfers from Kununurra accommodation

Operator: Lake Argyle Tours

Departs: Daily from Kununurra at 8:30am (Apr – Oct)

Returns: 5:30pm

PRICE:

Adult	\$320
Child 3-15 years	\$215



Ord River Day Tour

Travel by coach 70 kilometres across Durack country to Lake Argyle, enjoying the vast East Kimberley landscape. Stop at the historic Argyle Downs Homestead Museum before being amazed by the views of Lake Argyle and the Ord River. Board the boat for a scenic 55 kilometre cruise where another layer of the outback unfolds, another kind of spectacular scenery in an eco-environment thriving with birds and wildlife, including Freshwater crocodiles. A famous East Kimberley sunset is the perfect finish to the day.

Includes:

- Afternoon tea
- Cold drinks, water, tea and coffee

Operator: Triple J Tours

Departs: Daily from Kununurra at 11:30am (Apr – Oct)

Returns: 6pm

PRICE:

Adult	\$185
Child 3-15 years	\$145



Bungle Bungle Fly – Cathedral Gorge and Domes Walk

Experience The Kimberley's landmark attractions by air and by ground. Fly over Lake Argyle, Argyle Diamond Mine, Bungle Bungle, and the Ord Irrigation Area. After, walk among the beehive structures of the Bungle Bungle Range. Choose to add a 30 minute helicopter flight for a close-up view.

Includes:

- Scenic flight
- 30 minute helicopter flight (helicopter option)
- Informative commentary • Morning tea
- Picnic Lunch • Cold bottled water
- Return transfers from Kununurra accommodation

Operator: Aviair

Departs: Daily from Kununurra at 6am (Apr – Oct)

Returns: 1pm



PRICE:

	WITH HELICOPTER
Adult	\$789 \$1188



Bungle Bungle Adventurer

This scenic flight from Kununurra to the Bungle Bungles is an exhilarating way to take in The Kimberley's best icons. Fly past the Diversion Dam, Lake Kununurra and over the Ord River Irrigation Area before crossing the Carr Boyd Range and Lake Argyle. Fly over Lissadell Homestead, the Osmand Range and on to the iconic Bungle Bungles. Orbit the Argyle Diamond Mine on the return journey.

Includes:

- 2 hour scenic flight
- Informative commentary
- Cold bottled water and sweets
- Return transfers from Kununurra accommodation

Operator: Aviair

Departs: Daily from Kununurra at 6am, 9am, 2:30pm (Apr – Oct),
On request (Nov – Mar)

Duration: 2 hours

PRICE:

Adult	\$399
-------	--------------



Bungle Bungle Helicopter and Guided Walk Tour

See The Kimberley from above with the ultimate helicopter adventure. Fly over Bungle Bungle Range and witness the incredible beehive shaped sandstone domes, deep gorges and striking rifts. You will also see Lake Argyle, Kununurra, the Ord Irrigation Scheme and the Argyle Diamond Mine. On the ground, join a local guide who will walk you through Cathedral Gorge and tell you the history of the land.

Includes:

- 3 hour helicopter flight
- Morning Tea • Lunch • Cold water
- Return transfers from Kununurra accommodation

Operator: Helispirit

Departs: Daily from Kununurra at 6am

Returns: 2pm

Note: Price based on minimum 2 adults.

PRICE:

Adult	\$2199
-------	---------------

Kununurra Lakeside Resort

★★★★☆



From price based on Stay 4, Pay 3 in a **Self Catering Room**, valid 1 Oct 17 – 31 Mar 18.

From \$75*
per person per night

50 Casuarina Way, Kununurra

MAP PAGE 41 REF: 3

Situated alongside the stunning Lake Kununurra, this resort offers a tranquil environment from which to explore The Kimberley. With self-catering and motel style rooms there is a range of styles to suit individual needs and budgets.

Property Features: Free Wi-Fi (public areas), Pool (saltwater), Restaurant, Bar, Barbecue area, Private wharf, Parking (free), Courtesy airport transfers (available if pre-booked).

Room Features: Air-conditioning, Lake and pool views (Premiers), Tea/coffee making facilities, Limited cooking facilities with microwave (Self Catering rooms), All rooms non smoking.

Includes: Light breakfast daily.

Children: 0 to 15 years – free when sharing with an adult and using existing bedding.

Max Capacity: Self Catering/Premier – 3.

Distances: Town centre 2.5km.



EXCLUSIVELY FOR YOU

BONUS: FREE Night Offer: Stay 4 nights, pay for 3, valid 1 Sep 17 – 31 Mar 18.

Kununurra Country Club Resort

★★★★★



From price based on Stay 7, Pay 6 in a **Twin, Triple or Club Room**, valid 1 – 30 Apr, 1 Oct 17 – 31 Mar 18.

From \$92*
per person per night

47 Coolibah Drive, Kununurra

MAP PAGE 41 REF: 2

Centrally located in the heart of Kununurra, the resort's modern rooms are set in tropical gardens – a perfect sanctuary from which to explore the region. The resort showcases its passion for the Kununurra and East Kimberley region through their local knowledge, local art and photography and by celebrating locally-produced ingredients.

Property Features: Pool, Restaurant, Bar, Guest laundry (extra charge), Parking (free), Courtesy airport transfers (available if pre-booked), Resort shop.

Room Features: Air-conditioning, Tea/coffee making facilities, Mini bar, Cable TV, Ironing facilities, Hair dryer.

Children: 0 to 2 years – cot/bed charge payable direct. 3 to 11 years – adult prices apply.

Max Capacity: Twin/King – 2, Triple/Club – 3.

Distances: Town centre 50m.



BONUS: FREE Night Offer: Stay 7 nights, pay for 6, valid 1 Apr – 15 May, 1 Jun 17 – 31 Mar 18.

HONEYMOON BONUS: FREE bottle of sparkling wine in room on arrival.

Freshwater East Kimberley Apartments

★★★★★



From price based on Stay 7, Pay 6 in a **Studio**, valid 1 Oct 17 – 31 Mar 18.

From \$88*
per person per night

19 Victoria Highway, Kununurra

MAP PAGE 41 REF: 1

Overlooking Lily Creek Lagoon, Freshwater East Kimberley Apartments provide the ideal relaxing environment for the ultimate holiday adventure. The apartment complex offers spacious self-contained apartments with modern décor. One and three bedroom apartments feature a unique tropical outdoor shower creating an outback vibe. All apartments surround the stunning free form resort-style pool which was constructed with one of the East Kimberley's remote gorges in mind.

Property Features: Pool, Barbecue area, Parking (free), Courtesy airport transfers (available if pre-booked).

Room Features: Air-conditioning, Fan, Patio, Kitchen with microwave and dishwasher, Cable TV, CD/DVD player, Ironing facilities, Hair dryer, All rooms non smoking.

Children: 0 to 11 years – free when sharing with 2 adults and using existing bedding.

Max Capacity: Studio/1 Bedroom – 2, 2 Bedroom – 5, 3 Bedroom – 7.

Distances: Town centre 1.2km.



BONUS: FREE Night Offer: Stay 7 nights, pay for 6, valid 1 Apr 17 – 31 Mar 18.

Lake Argyle Resort

◆◆◆◆



From price based on 1 night in a **Standard Cabin or Standard Studio**, valid 1 Apr 17 – 31 Mar 18.

From \$130*
per person per night

Lake Argyle Road, 70kms from Kununurra

MAP PAGE 41 REF: 5

Nestled among a rugged billion year old landscape, surrounded by breathtaking scenery is Lake Argyle Resort. The perfect East Kimberley base, the Resort offers lake view villas, studio rooms and cabins.

There's so much to do at Lake Argyle, Australia's largest expanse of freshwater, with activities including bushwalking, fishing or canoeing. Explore the lake on a lunch or sunset cruise or enjoy an exhilarating scenic flight over the lake.

When you're not out exploring Lake Argyle, lounge around the infinity edge pool perched on a cliff overlooking the lake and simply enjoy the stunning views.

Property Features: Free Wi-Fi (public areas), Pool (infinity edge), Restaurant, Bar, Café, Barbecue area, Guest laundry, Resort shop, Parking (free).

Room Features: Air-conditioning, Balcony (Villas), Patio, Limited cooking facilities with microwave (Villas), Tea/coffee making facilities, 2 bathrooms in a 2 Bedroom Villa.

Children: 3 to 15 years – adult prices apply.

Max Capacity: 1 Bedroom Lake View Villa – 2, Standard Studio – 3, Standard Cabin/2 Bedroom Lake View Villa – 5.

Distances: Kununurra 70km.

Kununurra & Surrounds

The Berkeley River Lodge



From price based on 3 nights in a **River View Villa** or **Ocean View Villa**,
valid 1 Apr – 31 Oct 17.

From **\$744***
per person per night

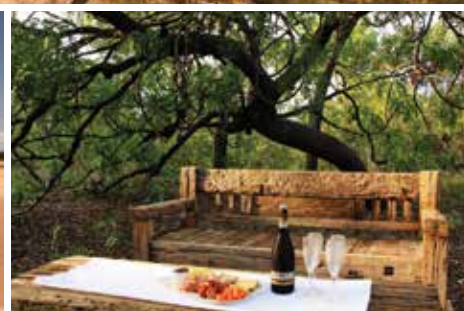
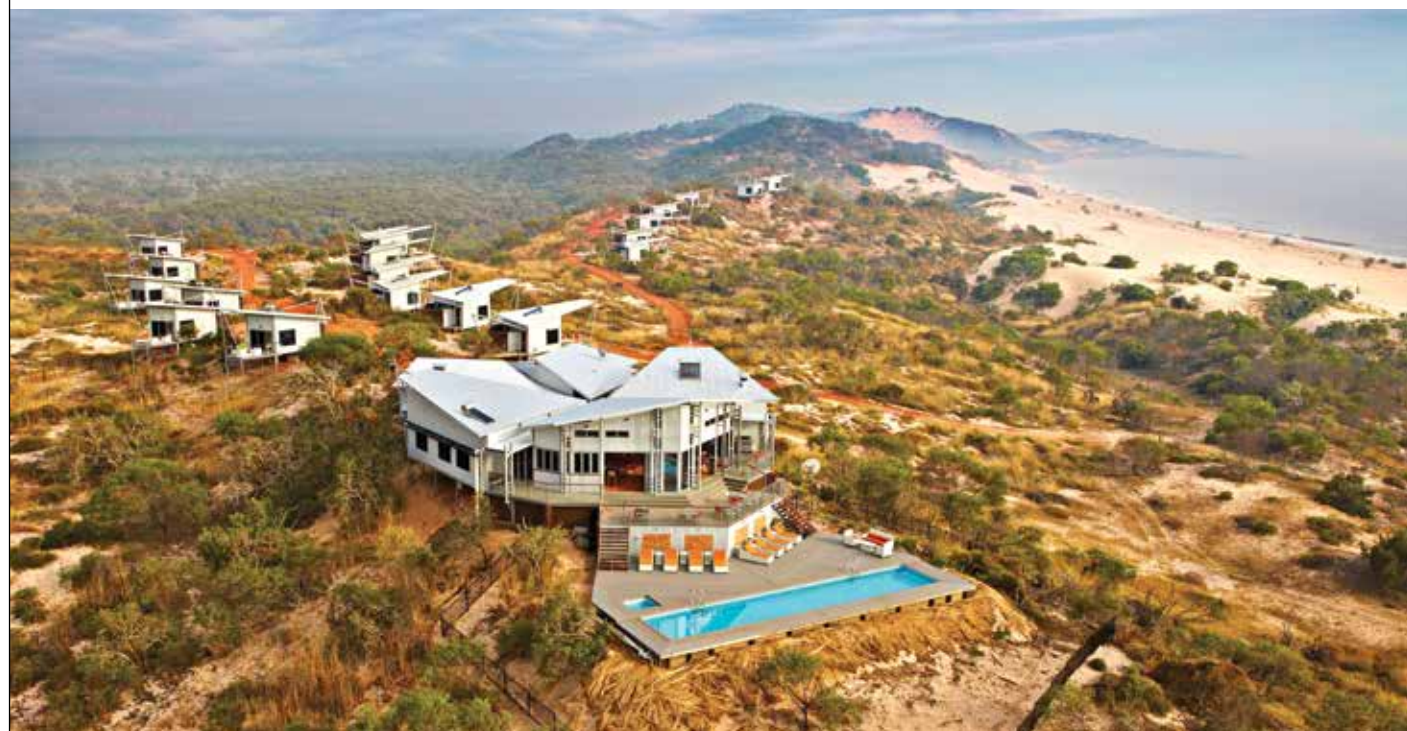

Berkeley River, East Kimberley

The Berkeley River Lodge brings a whole new level of accommodation to The Kimberley Coast in Western Australia. Located between the rugged northern Kimberley coastline and the mouth of the Berkeley River you will find unsurpassed accommodations. Leave behind the hustle and bustle of modern life for this truly remote and wild Kimberley landscape.

Only accessible by air or water, this lavish lodge is perched on a 65 metre high dune which provides incredible views for all 20 ocean view villas.

Surrounded by native vegetation, take in the views of Timor Sea, Reveley Island and the mouth of the stunning Berkeley River.

Indulge in superior accommodation by the sea and soak up the wide open spaces, fresh air and abundance of nature. The large floor to ceiling windows allow for impressive views of the red rock gorges of the Berkeley River. The luxury open-air bathtubs allow for bathing under a sky full of stars.

Explore your surrounds by day, try fishing along the river, take a guided walk or join a four-wheel drive tour through the diverse area. Enjoy as much or as little activity as you like. At night, return to the Lodge's restaurant for an unforgettable culinary experience. Dunes Restaurant showcases dramatic views across the Timor Sea and the Berkeley River while serving rich cuisine creations.



Ocean View Villa

MAP PAGE 41 REF. 4

Property Features: Internet facilities (limited), Pool, Spa, Sundeck, Room Service, Library, Laundry service.

Room Features: Air-conditioning, Fan, Deck, Tea/coffee making facilities, Open-air bathroom, Hair dryer.

Includes: All meals and selected alcoholic beverages daily. All tours and activities excluding helicopter tours.

Children: 0 to 11 years – free when sharing with an adult and using existing bedding.

Max Capacity: River View Villa/Ocean View Villa – 2.

Distances: Kununurra 120km.

How to Get There from Kununurra: 1 hour float plane or land based transfer.

From Darwin: 1 hour 45 minutes land based transfer. Ask your travel agent for details.

Note: Property is closed Nov – Mar (dates are subject to weather conditions).



We love it!

Our Favourites

Take a walk to Cathedral Gorge in the Bungle Bungle Range

Explore the many gorges along the Gibb River Road

Relax at Zebedee Thermal Springs at El Questro

Join the privileged few fishing the pristine waters of Admiralty Gulf

Experience a working cattle station



FIND YOUR ACCOMMODATION

REF.	PROPERTY	PAGE
1	Bell Gorge Wilderness Lodge ♦♦♦♦	45
2	Bungle Bungle Savannah Lodge ♦♦♦♦	46
3	Bungle Bungle Wilderness Lodge ♦♦♦♦	46
4	El Questro Homestead ♦♦♦♦	48
4	El Questro – Emma Gorge ♦♦♦♦	47
4	El Questro – The Station ♦♦♦♦	48
5	Home Valley Station ♦♦♦♦	46
6	Mitchell Falls Wilderness Lodge ♦♦♦♦	46
7	Mt Hart Homestead ♦♦♦♦	45

Experience the ultimate Kimberley adventure staying at the wilderness camps and working cattle stations dotted throughout The Kimberley region. These camps consist of permanent safari tents with either share or private facilities, while the stations offer a range of accommodation options, from safari tents to guest rooms in the homestead.

The stations and wilderness camps of The Kimberley cover a staggering 423,000 kilometres with a population smaller than almost any other place on Earth. From sensational fishing, to remarkable wildlife and breathtaking gorges, you're sure to find your piece of paradise in this ultimate Australian outback experience.

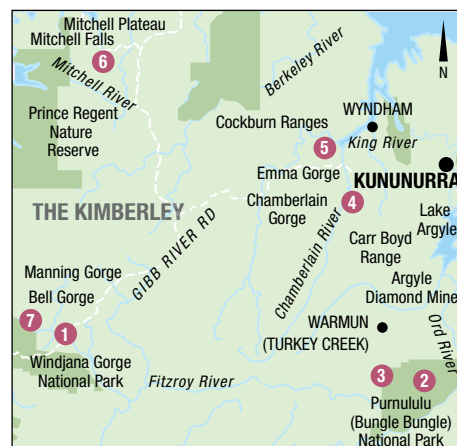

Bell Gorge Wilderness Lodge

♦♦♦♦



From price based on 1 night in a **Standard Twin Room**, valid 1 May – 30 Sep 17. \$12 per vehicle per day national park entrance fee payable direct.

From \$295*
per person per night

Gibb River Road, West Kimberley

MAP PAGE 45 REF. 1

Just off the Gibb River Road, this picturesque lodge offers easy access to explore Bell, Windjana, Galvans and Barnett River gorges, and Tunnel Creek. After your day of adventures, sit back and relax knowing that you will have a delicious three course dinner and a scrumptious buffet breakfast waiting for you, all included in your stay. From the deck of your cabin see views of King Leopold Range or unwind around a campfire. Bell Gorge Wilderness Lodge is the perfect base for exploring the West Kimberley.

Property Features: Lodge hosts, Liquor license, Open-air dining, Gourmet meals.

Room Features: Comfortable tented cabins, Deck, Twin bedding, Linen, Private en suite, Toiletries.

Includes: Breakfast and 3 course dinner daily.

Children: 3 to 14 years – \$236 per child per night.

Max Capacity: Standard Twin – 2.

Distances: Broome 440km.

Note: Lodge is closed 1 – 31 Apr, 1 Oct 17 – 31 Mar 18.



Mt Hart Homestead

♦♦♦♦



From price based on 1 night in a **Classic Safari Tent** or **Homestead Room**, valid 1 May – 30 Sep 17.

From \$315*
per person per night

King Leopold Ranges Conservation Park

MAP PAGE 45 REF. 7

In the heart of King Leopold Ranges Conservation Park, this homestead is the ideal base for exploring the West Kimberley gorge country. Originally a working cattle station, you will find rich history, a rustic ambience and exceptional hospitality at this homestead. For the active adventurer, breakfast and dinner are provided daily by your friendly hosts in the Settlers Bar. Experience Mt Hart Homestead for an authentic homestead experience.

Property Features: Homestead hosts, Liquor license, Laundry facilities, Library, RFDS rated airstrip.

Room Features: Air-conditioning (Homesteads), Authentic homestead rooms, Twin/double/triple bedding, Shared facilities (Homesteads), Private en suite (Classic Safari Tents).

Includes: Breakfast and dinner daily.

Children: 3 to 14 years – \$158 per child per night.

Max Capacity: Classic Safari Tent – 2, Homestead – 4.

Distances: Kununurra 485km, Gibb River Road 50km north.

Note: Property is closed 1 – 30 Apr, 1 Oct 17 – 31 Mar 18.

Kimberley Stations & Wilderness Camps

Bungle Bungle Savannah Lodge



Superior Cabin

From price based on 1 night in a **Standard Cabin**, valid 1 Apr – 30 Sep 17. \$12 per vehicle per day national park entrance fee payable direct.

From **\$250***
per person per night

Purnululu National Park

MAP PAGE 45 REF. 2

The eco-friendly Savannah Lodge set in the remarkable Purnululu National Park offers Cabin accommodation. This rustic bushcamp has little impact on the environment to blend and immerse visitors into The Kimberley wilderness. Enjoy hot showers, home cooked meals and a comfortable bed. Relax in the swimming pool or around campfire after a day exploring.

Property Features: Dining areas (Indoor, Outdoor), Pool, Licensed bar.

Room Features: Fan, Private en suite, Linen, Lighting, Power point.

Includes: Full breakfast and dinner daily.

Children: 0 to 5 years – cot/bed charge payable direct. 6 to 12 years – Standard Cabin \$250 per child per night.

Max Capacity: Standard Cabin/Superior Cabin – 2.

Distances: Kununurra 315km, Halls Creek 153km.

Note: Property is closed Oct – Mar (dates are subject to weather conditions).



Bungle Bungle Wilderness Lodge



Superior



From price based on 1 night in a **Standard Twin Room**, valid 2 May – 21 Sep 17. \$12 per vehicle per day national park entrance fee payable direct.

From **\$295***
per person per night

Purnululu National Park

MAP PAGE 45 REF. 3

Located in the heart of Purnululu National Park, the lodge offers convenient access to the Bungle Bungle Range. Spend your day exploring the stunning beehive domes of the Bungle Bungle Range and the breathtaking beauty of Piccaninny Creek, Cathedral Gorge, Echidna Chasm and Mini Palms Gorge. Return to Bungle Bungle Wilderness Lodge to unwind in the idyllic bush setting with a three course dinner.

Property Features: Lodge hosts, Liquor license, Gourmet meals.

Room Features: Tented cabins, Deck, Twin/king bedding, Linen, Private en suite, Toiletries.

Includes: Breakfast and 3 course dinner daily.

Children: 3 to 14 years – Standard Twin \$236 per child per night.

Max Capacity: Standard Twin – 2, Superior King/Superior Twin – 2 adults/1 child.

Distances: Kununurra 312km.

Note: Property is closed Oct – Apr (dates are subject to weather conditions).



Mitchell Falls Wilderness Lodge



Standard Twin



Ungolan Pavilion

From price based on 1 night in a **Standard Twin**, valid 10 May – 27 Sep 17. \$12 per vehicle per day national park entrance fee payable direct.

From **\$295***
per person per night

Mitchell Falls

MAP PAGE 45 REF. 6

Close to Mitchell Falls, a major Kimberley attraction, this lodge has minimal impact on the area leaving guests with an untouched natural habitat to explore. The refined yet comfortable Ungolan Pavilion is where you'll return after your explorations for a gourmet dining experience. Fusing modern Australian and Indigenous influences, this pavilion is the perfect place to unwind at Mitchell Falls Wilderness Lodge.

Property Features: Lodge hosts, Liquor license, Gourmet meals, Swimming hole.

Room Features: Tented cabins, Deck, Twin bedding, Linen, Private en suite, Toiletries.

Includes: Breakfast and 3 course dinner daily.

Children: 3 to 14 years – \$236 per child per night.

Max Capacity: Standard Twin – 2.

Distances: Kununurra 520km, Kalumburu and Mitchell Plateau Road junction 70km west.

Note: Property is closed Oct – Apr (dates are subject to weather conditions).



Home Valley Station



Grass Castle

From price based on 1 night in an **Eco Tent**, valid 1 – 31 May, 1 Sep – 31 Oct 17.

From **\$78***
per person per night

Gibb River Road, East Kimberley

MAP PAGE 45 REF. 5

At the foot of the majestic Cockburn Range and close to the mighty Pentecost River is the Home Valley Station. Offering accommodation choices from rugged adventure to outback luxury. Enjoy premium level accommodation in the Grass Castle, with creature comforts and a modern design. Stay in a Guesthouse Room, built on the site of the original stockman's quarters. Or embrace the bush setting in the Eco Tents, where you sleep under The Kimberley stars.

Property Features: Wi-Fi (public areas – extra charge), Pool, Restaurant, Bar, General store.

Room Features: Air-conditioning (except Eco Tents), Fan (except Eco Tents), Insect screens, Tea/coffee making facilities (except Eco Tents), Mini bar (Grass Castles), Cable TV (Grass Castles), Hair dryer (except Eco Tents).

Includes: Full breakfast daily.

Children: 0 to 15 years – free when sharing with an adult and using existing bedding, room only.

Max Capacity: Guesthouse Room – 2, Eco Tent – 3, Grass Castle – 4.

Distances: Kununurra 120km.



Kimberley Stations & Wilderness Camps



El Questro

MAP PAGE 45 REF. 4

El Questro is one of the world's most unique holiday destinations, providing a truly Australian holiday experience in The Kimberley near Kununurra. At just over 700,000 acres in size, El Questro is located in Western Australia's untamed Kimberley region and extends for approximately 80 kilometres, most of which has never been explored. It really is one of the last true frontiers. Go Barramundi fishing, set out on a horse trek, or explore remote areas by helicopter that only a select few have ever seen. A day spent with a local ranger will introduce you to a huge variety of animals and birds. El Questro offers three types of accommodation, each different in style and catering to a range of budgets. Choose from Tented Cabins at Emma Gorge, Riverview and Gardenview rooms at The Station or luxurious accommodation at the exclusive Homestead.

Activities Available at an Extra Charge: Fishing tours, Horse riding, Scenic helicopter flights, Gorge cruises, Station tours.

Distance: Kununurra 110km.

How To Get There from Kununurra: 2 hours by 4WD.

PRICE ONE WAY PER PERSON:	EMMA GORGE RESORT	THE STATION	HOMESTEAD
Adult	\$100	\$130	\$140

Note: Minimum 2 adults required. Helicopter and scenic charter flight prices are also available from Kununurra, Broome, Darwin and Alice Springs. Ask your travel agent for prices.

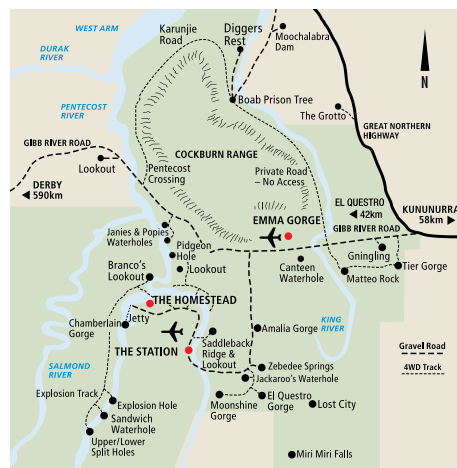

El Questro – Emma Gorge



From price based on 1 night in a
Tented Cabin, valid 13 Apr – 29
Sep 17. \$20 per adult Wilderness
Park permit payable direct, valid
for 7 days.

From \$154*
per person per night

Via The Gibb River Road, East Kimberley

MAP PAGE 47

Hidden within the fiery red of El Questro's Cockburn Ranges lies the spectacular Emma Gorge. The gorge opens up to reveal a cascading waterfall and a huge turquoise waterhole. El Questro Emma Gorge Resort is the closest property to this natural wonder.

Enjoy tented cabin accommodation allowing you to stay in comfort and style while still remaining close to nature and the rugged landscape.

Stargaze in the open air restaurant where chefs prepare modern Australian lunches and dinners for guests and visitors. The resort features a swimming pool and lounge area shaded by native trees and landscaped gardens on the banks of Emma Gorge Creek, both perfect for laying back and relaxing after a day exploring.

Property Features: Wi-Fi (public areas – extra charge), Pool, Restaurant, Bar, Boutique, Guest laundry.

Room Features: Fan, Private en suite.

Children: 0 to 12 years – free when sharing with an adult and using existing bedding.

Max Capacity: Tented Cabin – 4.

Note: Property is closed 1 – 12 Apr, 30 Sep 17 – 31 Mar 18.



Tented Cabin



Kimberley Stations & Wilderness Camps

El Questro – The Station



Station Bungalow Gardenview



From price based on 1 night in a
Station Gardenview Room,
valid 1 Apr – 28 Oct 17, \$20 per
adult Wilderness Park permit payable
direct, valid for 7 days.

From **\$170***
per person per night

Via The Gibb River Road, East Kimberley

MAP PAGE 47

El Questro Station sits in the heart of the El Questro property with stunning views of the rugged landscape and ancient boab trees. Go Barramundi fishing, set out on a horse trek, or explore remote areas by helicopter that only a lucky few have ever seen. A day spent with a local Ranger will introduce you to a variety of animals, birds and maybe even a Saltwater crocodile! El Questro Station boasts a range of Riverview and Gardenview rooms which are conveniently located next to the Steakhouse Restaurant and the Swinging Arm Bar and are only a short stroll away from a peaceful swimming hole. The camp ground provides a combination of powered and non-powered sites – with a number of fully fitted out tents for guests wishing to enjoy the fun of camping without needing to pitch a tent.

Property Features: Wi-Fi (public areas – extra charge), Restaurant, Bar, Guest laundry, Sundry shop, Fuel outlet.

Room Features: Air-conditioning, Balcony (Station Riverview), Tea/coffee making facilities, Private en suite, Ironing facilities, Hair dryer.

Children: 0 to 12 years – free when sharing with an adult and using existing bedding.

Max Capacity: Station Riverview – 4, Station Gardenview – 6.

Note: Property is closed 29 Oct 17 – 31 Mar 18.

El Questro Homestead



Cliff Side Retreat



From price based on 4 nights
in a **Homestead Garden Room**,
valid 1 Apr – 28 Oct 17.

From **\$837***
per person per night

Via The Gibb River Road, East Kimberley

MAP PAGE 47

The luxurious El Questro Homestead sits in an exclusive oasis in Western Australia's rugged Kimberley landscape.

The resort style accommodation features magnificent panoramic views of Chamberlain Gorge and river systems from sunrise to sunset. Enjoy the exclusive Homestead swimming pool and tennis court before indulging in a gourmet dinner on a spacious verandah or private cliff top. Experience intimate Ranger led tours, soak in the Zebedee Thermal Springs, cruise private gorges, rivers and waterfalls, or explore from the air, horse ride or hike on foot. The Homestead provides luxury accommodations and modern conveniences in The Kimberley outback.

Property Features: Free Wi-Fi (public areas), Pool, Exclusive dining, Bar, Internet café, Tennis court, Library.

Room Features: Air-conditioning, Fan, Verandah, Tea/coffee making facilities, Mini bar, Ironing facilities, Private en suite, CD player, Docking station (Apple), Hair dryer.

Includes: All dining and beverages daily (except Cellar Masters list), Selected touring, Wilderness Park permit.

Children: 0 to 15 years – not catered for.

Max Capacity: Homestead Garden/Gorge View/Cliff Side Retreat/Chamberlain Suite – 2.

Note: Property is closed 29 Oct 17 – 31 Mar 18.

Our Favourites

Visit Wolfe Creek Crater and the China Wall

Explore the ancient Tunnel Creek and Windjana Gorge

Take a trip to Geikie Gorge

Picnic, swim and fish at Sawpit Gorge, Halls Creek

Check out the old Halls Creek town site, a reminder of the town's mining history



Bungle Bungle Range

FIND YOUR ACCOMMODATION

REF.	HOTELS	PAGE
1	Kimberley Hotel ★★☆☆	46



China Wall

Located on the edge of the Great Sandy Desert you'll find Halls Creek. This historic town is rich with the influence of the Western Australian gold mining industry and provides easy access to Purnululu National Park and the Bungle Bungle Range. Visit Old Halls Creek, home to the first gold discovery in Western Australia. Try your hand at panning for gold and see the ruins of the old mud Post Office.

In this part of The Kimberley there are amazing natural attractions including the phenomenal Wolfe Creek Crater, the second largest meteorite crater in the world. Also see the six metre high wall of quartz rock, known as China Wall. Rising from the creek and over the side of a hill these rocks look like a miniature Great Wall of China.



Kimberley Hotel

★★★☆☆



Deluxe



From price based on 1 night in a
Standard Room, valid 1 – 30 Apr 17.

From **\$68***
per person per night

Roberta Avenue, Halls Creek

MAP PAGE 49 REF. 1

Set in delightful gardens surrounded by wide verandahs and pathways, Kimberley Hotel, Halls Creek is right in the centre of town.

The accommodation offers large, spacious rooms creating a comfortable and relaxed stay. The hotel features a colonial style lounge, traditional saloon bar, cocktail bar and a restaurant overlooking a swimming pool and spa. There are plenty of places to sit back and relax.

Kimberley Hotel, Halls Creek provides a retreat in The Kimberley region.

Property Features: Pool, Restaurant, Bars (2), Room service (limited), Barbecue area, Guest laundry, Parking (free), Courtesy airport transfers (available if pre-booked).

Room Features: Air-conditioning, Fan, Tea/coffee making facilities, Cable TV, Ironing facilities, Hair dryer.

Children: 0 to 11 years – free when sharing with an adult and using existing bedding.

Max Capacity: Standard – 2, Deluxe – 3, 1 Bedroom – 4, 2 Bedroom – 6.

Distances: Town centre 500m, Kununurra 358km.



We love it!

Accommodation Index



El Questro Homestead

PROPERTY	PAGE	PROPERTY	PAGE	PROPERTY	PAGE
Broome & Surrounds		Ramada Eco Beach Resort, Cape Villaret	40	Bungle Bungle Savannah Lodge	46
The Billi Resort	37	Seashells Broome	38	Bungle Bungle Wilderness Lodge	46
Blue Seas Resort	37	Kununurra & Surrounds		El Questro – Emma Gorge	47
Cable Beach Club Resort & Spa	37	The Berkeley River Lodge	44	El Questro Homestead	48
Kimberley Sands Resort and Spa	39	Freshwater East Kimberley Apartments	43	El Questro – The Station	48
Mangrove Hotel	36	Kununurra Country Club Resort	43	Home Valley Station	46
Mercure Broome	36	Kununurra Lakeside Resort	43	Mitchell Falls Wilderness Lodge	46
Moonlight Bay Suites	36	Lake Argyle Resort	43	Mt Hart Homestead	45
Oaks Broome	38	Kimberley Stations & Wilderness Camps		Halls Creek	
Oaks Cable Beach Sanctuary	38	Bell Gorge Wilderness Lodge	45	Kimberley Hotel	49
The Pearle of Cable Beach	40				



Please read these Important Booking Conditions carefully as they apply to all bookings with Sunlover Holidays.

How to Book

Contact your travel agent, call 1300 738 833 or go to sunloverholidays.com.au and request a reservation. All verbal quotes provided are an estimate only and subject to change until confirmed in writing.

Prices & Conditions

This brochure was printed on 29 November 2016. The prices in this brochure are valid for travel from 1 April 2017 to 31 March 2018, unless otherwise stated, are in Australian dollars and include GST where applicable. All prices are subject to availability, subject to change and can be withdrawn or varied without notice. Price changes may occur by reason of matters outside our control which increase the cost of the product or service. Such factors include (without limitation) adverse currency fluctuations, fuel surcharges, taxes and airfare increases. Surcharges and minimum stays may apply due to demand, Christmas and New Year's Eve, school and public holidays, special events and other circumstances. All prices are the lowest available prices at the time of print and are a guide only. Ask your travel agent for exact pricing, other dates and availability.

If we have to change any part of your booking for reasons beyond our control, for example, an Accommodation Supplier overbooks accommodation, or if there is an increase in taxes or Supplier charges, we will notify you. If any such changes result in your holiday costing more or otherwise being materially different from that originally booked, you may cancel the booking and we will refund any monies already paid less any charges levied by Suppliers.

Prices Do Not Include

Anything not specifically indicated as being an inclusion.

Deposits & Final Payments

Deposit

A minimum non-refundable deposit of \$55 per person for domestic bookings and \$100 per person for international bookings is payable within 7 days of confirmation of your booking. You will be notified at the time of booking if any additional deposit requirements apply.

Final Payment

Final payment of your holiday cost is required at least 30 days prior to departure or by sale end date or by the payment deadline specified in individual package conditions, whichever is earlier. Some services, including airfares, may require full payment at the time of booking. For bookings made less than 31 days prior to travel, full payment of holiday cost is required at the time your booking is confirmed.

Please ensure payments are made by the due dates. If this does not happen, our system will automatically cancel the booking without notice or liability to you.

Only upon payment of the full cost of your holiday do you have a final booking with the Supplier of the relevant good and/or service. In arranging your booking, Sunlover Holidays is acting as the agent of the Supplier of the relevant Product and at no time do you have a contract with Sunlover Holidays.

Credit & Debit Card Surcharges

A fee will apply for payments made by debit and credit cards. Please check this fee with us or your travel agent when booking.

Amendment Fees

If you change your booking, an amendment fee of \$30 will be charged, in addition to any fees imposed by the Supplier of each service booked.

Late Booking Fee

A fee of \$30 will be charged for all bookings made less than 7 days prior to travel.

Cancellations & Refunds

Prior to final payment: Your deposit is forfeited.

After final payment: There will be no refund of your deposit, in addition to any fees imposed by the Supplier, which may be up to 100% of monies paid.

After travel: There will be no refund for cancellation once travel has commenced. There will be no refund for unused services unless cancelled prior to travel date, with the exception of OPEN DATED services where the service is unused due to rain for the entire stay. Requests for refunds received more than 6 months after departure date will not be accepted.

Responsibility

Sunlover Holidays acts as an agent for the Suppliers (transport, tour, event or accommodation providers) who provide the various goods and/or services (Products). All bookings are subject to the terms and conditions and limitations of liability imposed by each Supplier. It is therefore important for you to obtain and read the applicable Supplier's terms and conditions as they may limit or exclude their liability to you.

In producing this brochure, we have used information provided by Suppliers. Irrespective of any measures taken by us to ensure the information contained in this brochure is accurate at the time of printing, Sunlover Holidays disclaims and will be exempt from liability in respect of anything misleading, false, incomplete or inaccurate and any errors, misdescription and all associated disappointment, loss, expense, damage, inconvenience, delay, death, shock, illness or injury, however caused.

Sunlover Holidays does not control the manner in which Products featured within this brochure are provided. Sunlover Holidays disclaims and will be exempt from liability for anything to do with the supply of such Products. This includes liability (whether as a matter of contract, tort, statute, restitution, or otherwise) for any direct, indirect or consequential loss, liability, claim, cost, expense, proceeding, demand, penalty, disappointment, death, injury, illness, shock, inconvenience or delay. This limitation of liability also applies irrespective of the cause, including negligence of us or a Supplier, withdrawal, cancellation or failure to provide a Product, delay, any variation in the Product, the provision of substitute Products or a change in the Supplier. Without limitation, Sunlover Holidays will not be responsible if the Product is not available due to inclement weather conditions or other acts of God, civil disturbances, fire, floods, acts of Government or any other authorities, accident to or failure of machinery or equipment or industrial action.

Maps & Photographs

The maps in this brochure are intended as a guide only and are not to scale. They do not necessarily reflect actual routings or accommodation or attraction locations. Accommodation room photographs are representative only and actual rooms occupied may vary in decor and inclusions from those shown. Many images are supplied courtesy of tourist bureaus, hotels and tour operators.

Some images used in this brochure are supplied courtesy of Tourism Western Australia, Tourism Australia, North Star Cruises, The Great Escape Charter Company, Acorn Photo Agency, Adrian Beckett, ANW, Dave Hancock, David Kirkland, Don Skirrow, Edward Tran, GM, James Fisher, Joel Barblitta, Jewels Lynch Photography, Mauro Risch, Mark Stothard Photography, Paul Pichugin, Penney Hayley, Philip Schubert, Robert Frith, Steve Strike, Tao Hoogland, Tim Hixson, Timothy Burgess, Tony Fawcett.

Product Descriptions

Product descriptions and accommodation ratings featured in this brochure are provided by the individual Suppliers. Facilities, features or ratings are subject to change at any time. Tours may not operate on certain dates and durations and departure times are approximate only. You should check at the time of booking for any changes to published information of which we may be aware.

Children's Prices

Children's prices for accommodation featured in this brochure refer to children occupying the same room/unit with at least two adults and using existing bedding. Additional charges will apply if extra beds (including rollaways and cots) are required. Prices for any other combination of children and adults can be obtained when booking.

Bonds

Bonds or credit card imprints are required by Car Hire Suppliers and by most Accommodation Suppliers at the time of check-in to cover incidentals and fees not included in your holiday cost.

Airfares

Airfares not included unless otherwise specified. A number of airfares can be used in conjunction with your holiday package. All airfares are subject to availability and have special conditions. In most instances airfares must be paid in full at the time of booking and some may be non-refundable.

Travel Insurance

We strongly recommend you take out appropriate travel insurance to cover your travel arrangements.

Transfers & Tours

Some Accommodation Suppliers provide courtesy transfers to/from the airport. It is essential that these transfers are pre-booked. Some Tour Suppliers provide complimentary pick up and return to your holiday accommodation and require a minimum number of passengers to operate. If minimum numbers are not achieved tours may be cancelled at short notice. Additionally, some Suppliers reserve the right to cancel departures for other reasons, including bad weather. Some tours and itineraries may also vary and attractions may be substituted due to seasonal conditions. Sunlover Holidays will not be held liable for a service variation, cancellation, delay or withdrawal, or a Supplier's failure to notify you. A full refund applies for the cancelled tour.

Governing Law

These conditions are governed by the laws of New South Wales, Australia and any action arising under them or in any way connected with a booking may be brought only in a court in New South Wales, Australia, subject to any law which is expressly inconsistent with this.

Please check our complete and up to date full booking conditions available at our website sunloverholidays.com.au.

HALF DAY AND FULL DAY TOURS

BROOME



Broome and The Kimberley Region

Offering the real Australian outback, the remote **Kimberley Region** of Western Australia's north is considered even by Australians as a last frontier. An immense area larger than the entire Australian state of Victoria and close to **three times the size of the United Kingdom**, there is much to explore. Over millions of years this arid land has been shaped by tropical summer monsoon rains that have carved out **amazing landforms**, stunning **gorges**, **waterfalls** and pristine hidden **swimming holes**. Travel up rough **rugged outback** roads and through kilometres of **wilderness** to reach awe inspiring **natural landforms**.



Click, call us or see your preferred Travel Agent. sunloverholidays.com.au ☎ 1300 738 833

YOUR SUNLOVER HOLIDAYS PREFERRED AGENT:

Travel Agent Bookings and Enquiries

Web: agents.sunloverholidays.com.au

Phone: 1300 738 830

Group Reservations 1300 738 838



For more inspiring holiday destinations scan our QR code to view our complete range of brochures online at sunloverholidays.com.au

